

ATV-001 小恐龙1+1美国

1. Plastic cover 塑料件

Ref. No.	Parts No.	Discription	名称及规格	数量Q'TY
1	202150003	OIL SWITCH	油开关	1
2	202210016	BIG FUEL PIPE	油管7x11	0.35米
3	202210009	SMALL FUEL PIPE	EPA油管4.5*8.5	0.3米
4	202200057	BIG SPRINGINESS LATHE DOG	大油管卡簧	1
5	202200058	SMALL SPRINGINESS LATHE DOG	小油管卡簧(M8)	5
6	202150002	GAS FILTER	油滤器	1
7	201215001	MAIN PLASTIC BODY	ATV-001车体8-1	1
8	201214001	Lampshade	ATV-001灯罩(小恐龙) 8-2	1
9	201216001	L.FOOTREST	ATV-001左脚踏板8-3	1
10	201217001	R.FOOTREST	ATV-001右脚踏板8-4	1
11	201218001	L.Decorative board	ATV-001左装饰块8-5	1
12	201219001	R.Decorative board	ATV-001右装饰块8-6	1
13	202200245	Headlamp	ATV-001 LED前大灯8-7	1
14	202200247	Rear lamp	ATV-001 LED后尾灯8-8	1
15	202220017	SEAT ASSY	ATV-001(小恐龙)坐垫	1
16	201207001	CHAIN COVER	沙滩车通用链罩	1
17		Mushroom head bolts	大扁头螺钉M6x20	16
18		Large washer	大垫圈φ6.6×φ18	22
19	202150006	RUBBER PAD	单层胶垫	20
20		HEX FLANGE NUT	六角法兰面螺母M6	18
21		TAPPING SCREW	自攻螺钉ST4.2x13	6
22	202200088	gear light R	档显灯R	1
23	202200089	gear light N	档显灯N	1

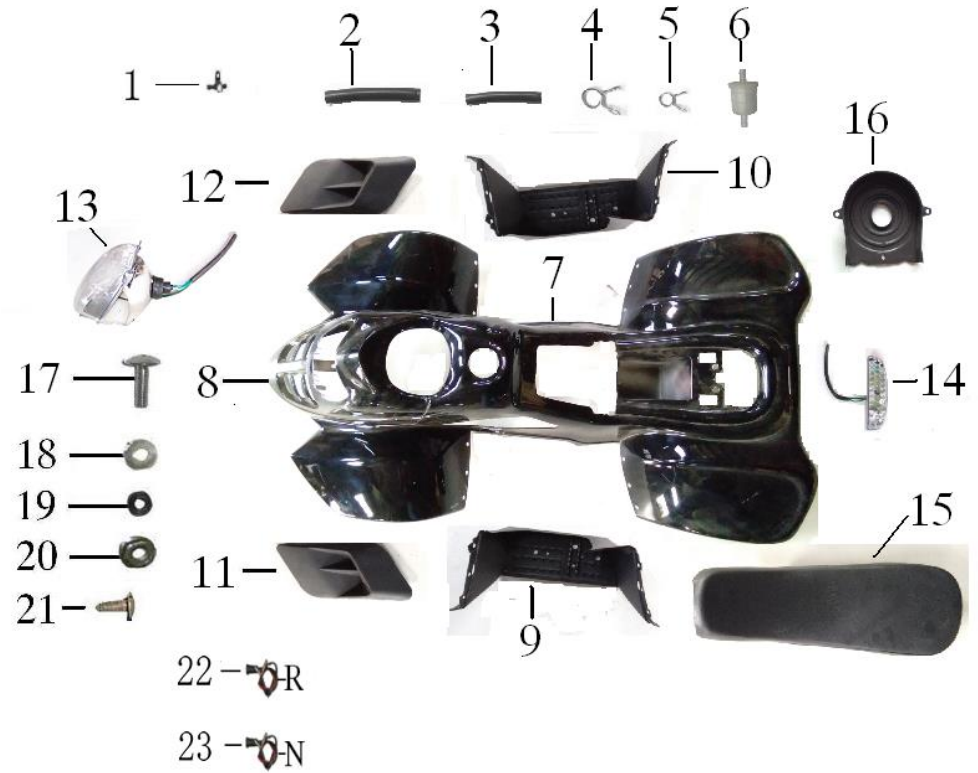

2. Main part steering system

Ref. No.	Parts No.	Discription	名称及规格	QTY
1	202070057	HANDLE BAR	套色手把套(美国状态)	1
2	202060008	FUNCTION SWITCH	三功能开关	1
3	203010443	STEERING BAR	沙滩车手把管喷塑(800mm)	1
4		Hexagon flange bolts	六角法兰面螺栓M8X55	4
5	202110047	UPPER CLIP	50手把夹块1套	1
/	/	/	/	/
7	202070014	THROTTLE	沙滩车双刹加油器	1
8	202070057	HANDLE BAR	套色手把套(美国状态)	1
9		Hexagon flange bolts	六角法兰面螺栓M10x60	2
10	201337001	STEERING CLIP (UPPER)	大公牛方向柱夹块(1套)	1
11	203011040	GASKET $\Phi 11 \times \Phi 14 \times 40 \text{mm}$	方向柱隔套 $\Phi 14 \times 1.5 \times 40 \text{mm}$	2
12	/	/	/	/
13		NUT	防松螺母M10	2
14	203010437	STEERING POST	ATV-001方向柱喷塑(410mm)	1
15	202120021	HANDLE BAR	120横直拉杆1副	1
16		NUT	防松螺母M12	1
17	202160014	PROTECTION MASK	圆柱包布中 中性	1
18	202170002		海绵管18*50	1
19	202080022	THROTTLE CABLE	EPA油门线720mmx85mm	1
20		gasket	方向柱夹块垫片	1

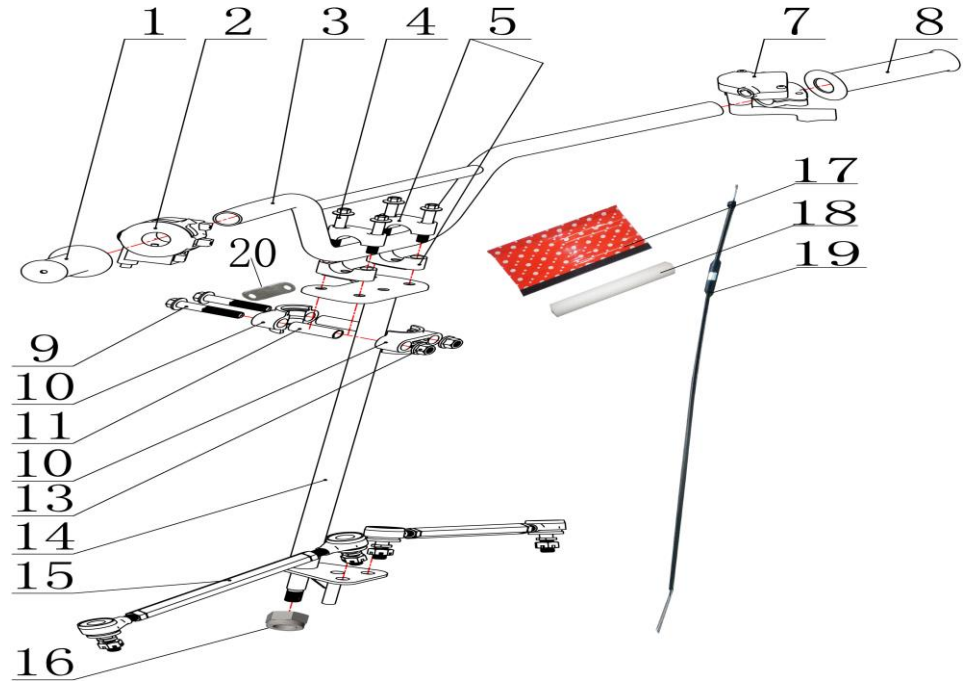

3. Main part front suspension system

Ref. No.	Parts No.	Discription	名称及规格	QTY
1	202010030	FRONT SHOCK	小恐龙前减6mmx270mm	2
2		HEX FLANGE LOCKING NUT	自锁螺母M10	12
3		Hexagon flange bolts	六角法兰面螺栓M10x40	4
4	203010433	UPPER SWING ARM	ATV-001上摇臂喷塑	2
5		Hexagon flange bolts	六角法兰面螺栓M10x70	4
6	203010453	short GASKET	摇臂短隔套 (14*10.2*48)	4
7	201210001	small WASHER	摇臂尼龙套小	8
8	202150029	small COVER	沙滩车防尘盖小	16
9	203010452	long GASKET	atv-001/002摇臂长隔套 (14*10.2*152)	4
10		Hexagon flange bolts	六角法兰面螺栓M10x170	4
11	203010445	LEFT ELEVATION AXIS	沙滩车转向节左喷塑	1
12	203010447	RIGHT ELEVATION AXIS	沙滩车转向节右喷塑	1
13	203010449	CHIP	沙滩车仰角吊耳电镀	4
14		Hexagon flange bolts	六角法兰面螺栓M12x105	2
15	201209001	large WASHER	仰角尼龙套大	4
16	202150028	medium COVER	沙滩车防尘盖中	4
17	203010451	GASKET	沙滩车转向节隔套 (16*12.2-80)	2
18		HEX FLANGE LOCKING NUT	自锁螺母M12	2
19	203010435	LOWER SWING ARM	ATV-001下摇臂喷塑	2
20	202150027	Big COVER	沙滩车防尘盖大	2
21		Slotted nut	开槽螺母M14x1.5	2
22		Cotter pin	开口销φ3x30	2
23	202150026	Dust cap	沙滩车橡胶防尘帽	2
24	202140173	FRONT TIRE	145/70-6火焰花轮胎(145/70-6)	2
25	202140174	FRONT HUB	145/70-6黑色轮毂(145/70-6)	2

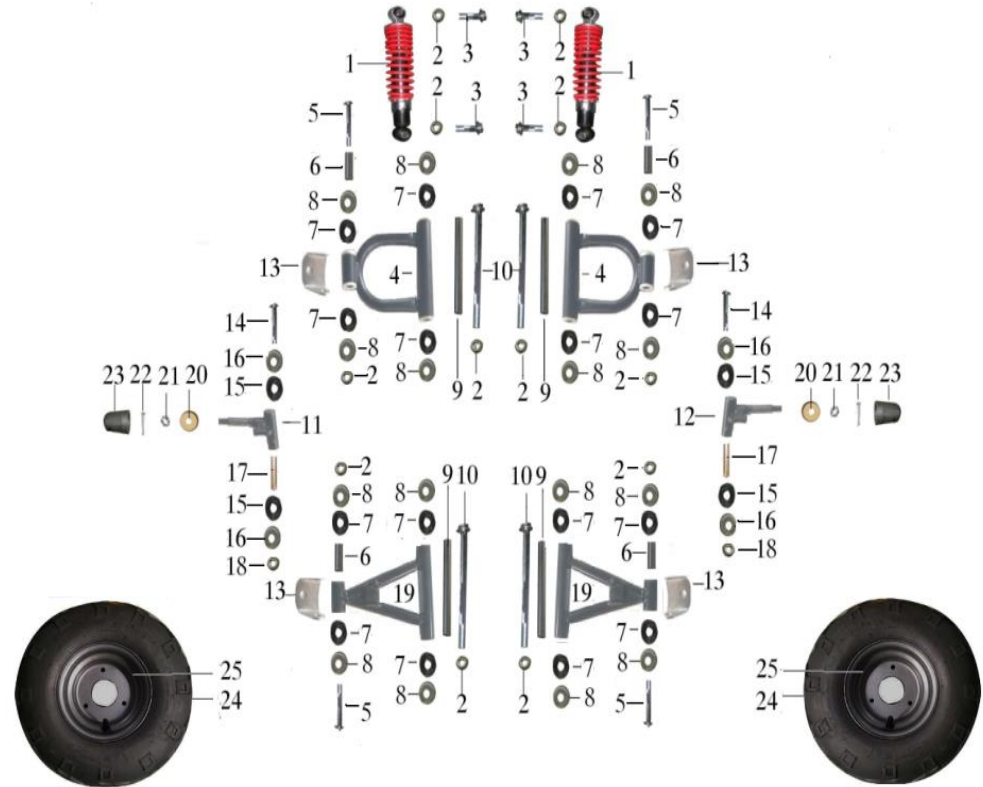

5. Main part Electrical parts

Ref. No.	Parts No.	Discription	名称及规格	Q'TY
1	202030078	RELAY	EPA高压包编号K125-10线长300	1
2	202030017	RELAY	110继电器	1
3	202030079	C.D.I	EPA点火器编号K125-02 (ATV)	1
4	202030080	RECTIFIER	110半波不带线稳压器	1
5	202060017	ELECTRIC LOCK	四冲普通电门锁	1
6	201137001	REPLAY TRANSMITTER	反光片	1
7	202050018	cable	ATV-001 (小恐龙) 1+1总线	1
8	202030028	ALARM	单功能报警器	1
10	202180004	BATTERY	12V4A加液电池	1
11	202060026	FLAME OUT SWITCH	EPA布带开关	1

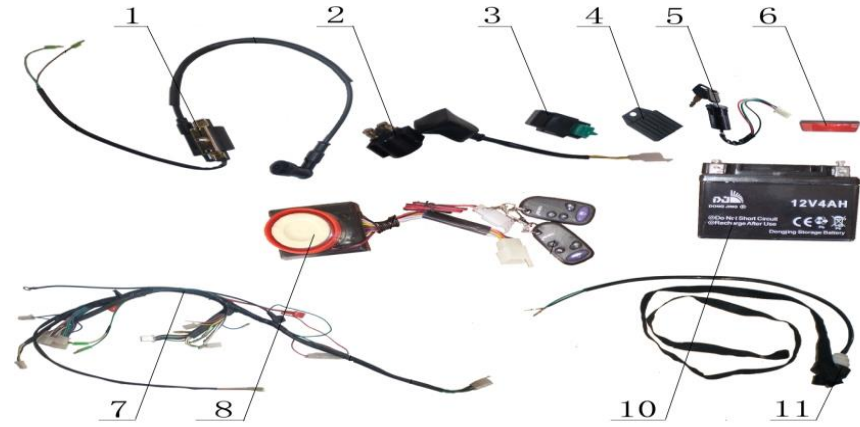

6. Main part Hydraulic brake system

Ref. No.	Parts No.	Discription	名称及规格	Q'TY
1	202040005	left DRUM BRAKE	50左鼓刹器	1
2	202040046	right DRUM BRAKE	50右鼓刹器	1
3	202040017	BRAKE CABLE	刹刹线850mmx85mm	2
4		HANDLE BRAKE	M5X16六角法兰面螺栓	2
5		REAR BRAKE	M5自锁螺母	2
6	202040051	rear brake set	后液刹带整体刹车开关/油管 400mm顶杆长88mm	1
7	203010784	foot brake fast	EPA小恐龙脚刹杆喷塑	1
8	202150037	spring	后刹制动回位簧 (长)	1

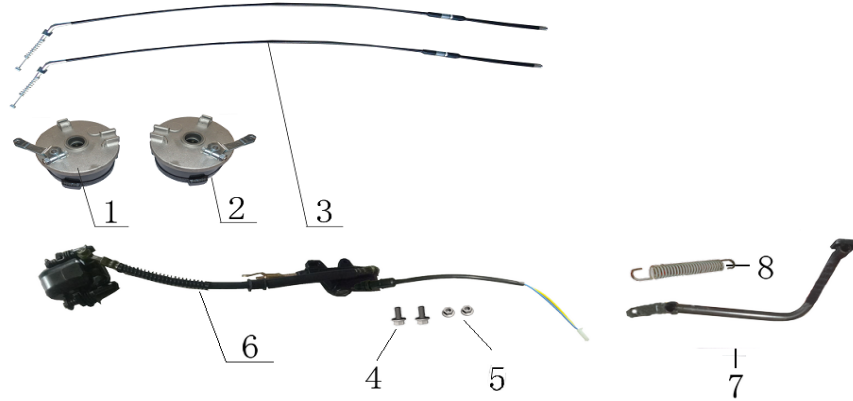

7. Main part Frame system

Ref. No.	Parts No.	Discription	名称及规格	Q'TY
1	203034001	front protection	ATV-001保护架	1
2		FENDER GUARD	ATV-001车架	1
3	202150009	rear rack stents,right	橡胶堵头20	2
4	202130043	rear rack stents,left	手挂挡杆	1
5	203010776	rear rack	EPA小恐龙后货架喷塑	1
6		110cc auto engine	110cc 自动波	1
	205090103	110cc 1+1 engine	110cc 1+1 (美国)	1
7	202130101	EXHAUST PIPE	EPA ATV-001排气管	1
8		Hexagon flange bolts	六角法兰面螺栓M10x105	1
9		Hexagon flange bolts	六角法兰面螺栓M10x110	1
10		HEX FLANGE LOCKING NUT	自锁螺母M10	2
11	202200243	GAS TANK	EPA铁油箱编码K125-03 (ATV)	1
12		Hexagon flange bolts	六角法兰面螺栓M8x16	4
13		HEX FLANGE LOCKING NUT	自锁螺母M6	2
14	202200244	AIR FILTER	EPA空滤器编码K125-05(ATV)	1
15	202000231	fuel tank cap	EPA油箱盖编码K125-04	1
16	202030081	carburetor	PZ20化油器(Fα-9)	1
17		bolt	六角法兰面螺栓M8x16	4
18		nut	自锁螺母M8	7
19		bolt	六角法兰面螺栓M8x20	1

