



序号 SR NO.	件号Part No.	名称Description	名称Description	数量Qty
1	PST50-1Z-A-001	Front tire	前轮胎	1
2	PST50-1Z-A-002	Front rim	前轮毂	1
3	PST50-1Z-A-003	Front brake disc	前制动盘	1
4	PST50-1Z-A-004	Steering stem	下联板	1
5	PST50-1Z-A-005	Front Shock LH, RH	前左右减震	2
6	PST50-1Z-A-006	Front disc brake	前碟刹	1
7	PST50-1Z-A-007	Steel bowl	钢碗	1
8	PST50-1Z-A-008	Mileage line clip	里程线线夹	1
9	PST50-1Z-A-009	Front disc brake clip	前碟刹线夹	1
10	PST50-1Z-A-010	Speed sensor	转速器	1
11	PST50-1Z-A-011	Front wheel bushing	前轮衬套	1
12	PST50-1Z-A-012	Self lock screw	自锁螺母	1
13	PST50-1Z-A-013	Front axle	前轮轴	1
14	PST50-1Z-A-014	Tubeless valve	气门嘴	1



序号 SR NO.	件号Part No.	名称Description	名称Description	数量Qty
1	PST50-1Z-B-001	Left panel	左装饰板	1
2	PST50-1Z-B-002	Right panel	右装饰板	1
3	PST50-1Z-B-003	Tail lamp	尾灯	1
4	PST50-1Z-B-004	Rear fender	后挡泥板	1
5	PST50-1Z-B-005	Left panel decoration	左装饰板装饰件	1
6	PST50-1Z-B-006	Right panel decoration	右装饰板装饰件	1
7	PST50-1Z-B-007	Connecting, up	上连接	1
8	PST50-1Z-B-008	Rear wing	后翼LED（后牌照灯）	1
9	PST50-1Z-B-009	Rear reflector plate	后反射镜片	1
10	PST50-1Z-B-010	Rear tail wing	后尾翼	1
11	PST50-1Z-B-011	Headlight bracket	大灯支架	1



序号 SR NO.	件号Part No.	名称Description	名称Description	数量Qty
1	PST50-1Z-C-001	Front wheel fender	前轮泥板	1
2	PST50-1Z-C-002	Left guard	左护条	1
3	PST50-1Z-C-003	Right guard	右护条	1
4	PST50-1Z-C-004	Rear left bar	后左边条	1
5	PST50-1Z-C-005	Rear right bar	后右边条	1



序号 SR NO.	件号Part No.	名称Description	名称Description	数量Qty
1	PST50-1Z-D-001	Seat front wall	坐垫前围	1
2	PST50-1Z-D-002	Front wall fender	前围泥板	1
3	PST50-1Z-D-003	Center cover	中心盖	1
4	PST50-1Z-D-004	Battery cover	电瓶盖	1
5	PST50-1Z-D-005	Charging port cover	充电口盖	1



序号 SR NO.	件号Part No.	名称Description	名称Description	数量Qty
1	PST50-1Z-E-001	Lower part of the toolbox	工具箱下部	1
2	PST50-1Z-E-002	Upper part of the toolbox	工具箱上部	1
3	PST50-1Z-E-003	Foot pedal	脚踏板	1
4	PST50-1Z-E-004	Cover, Chassis No.	号码盖	1
5	PST50-1Z-E-005	Hook up	电镀挂钩	1
6	PST50-1Z-E-006	Foot pedal cover	脚踏板小盖	4



序号 SR NO.	件号Part No.	名称Description	名称Description	数量Qty
1	PST50-1Z-F-001	Seat	坐垫	1
2	PST50-1Z-F-002	Luggage	杂物箱	1
3	PST50-1Z-F-003	Luggage cover	杂物箱内盖	1



序号 SR NO.	件号Part No.	名称Description	名称Description	数量Qty
1	PST50-1Z-G-001	Rear mirror	后视镜	2
2	PST50-1Z-G-002	Handlebar	方向把	1
3	PST50-1Z-G-003	Seat cushion pull	坐垫拉线	1
4	PST50-1Z-G-004	Mileage line	里程线	1
5	PST50-1Z-G-005	Throttle cable	油门线	1

6	PST50-1Z-G-006	Key set	套锁	1
7	PST50-1Z-G-007	Seat lock	坐垫锁	1
8	PST50-1Z-G-008	Throttle holder	油门座	1
9	PST50-1Z-G-009	Left hand grip	左胶套	1
10	PST50-1Z-G-010	Throttle grip	油门胶套	1

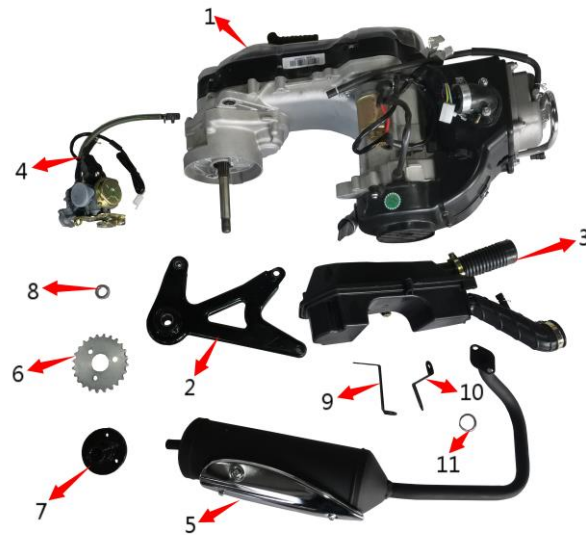

序号 SR NO.	件号Part No.	名称Description	名称Description	数量Qty
1	PST50-1Z-H-001	Engine	发动机	1
2	PST50-1Z-H-002	Connecting plate	三角连接板	1
3	PST50-1Z-H-003	Engine	空滤	1
4	PST50-1Z-H-004	Air filter	化油器	1
5	PST50-1Z-H-005	Muffler	消音器	1
6	PST50-1Z-H-006	Front sprocket	前链轮	1
7	PST50-1Z-H-007	Sprocket holder	链轮座	1
8	PST50-1Z-H-008	Connecting plate bushing	三角连接板衬套	1
9	PST50-1Z-H-009	Air filter bracket long	空滤支架长	1
10	PST50-1Z-H-010	Air filter bracket short	空滤支架短	1
11	PST50-1Z-H-011	Muffler washer	消音器垫圈	1



序号 SR NO.	件号Part No.	名称Description	名称Description	数量Qty
1	PST50-1Z-I-001	Front wall	前围	1
2	PST50-1Z-I-002	Front panel	前面板	1
3	PST50-1Z-I-003	Front headlight	前大灯	1
4	PST50-1Z-I-004	Front wall left decoration	前围左装饰件	1
5	PST50-1Z-I-005	Front wall right decoration	前围右装饰件	1
6	PST50-1Z-I-006	Front wall decoration	前围装饰件	1

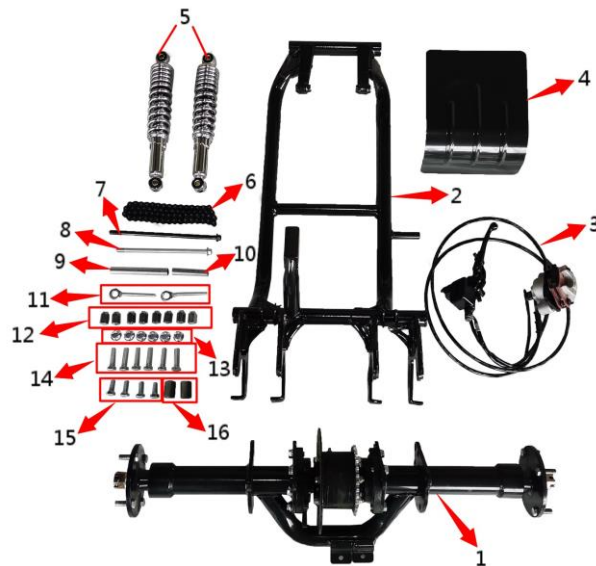

序号 SR NO.	件号Part No.	名称Description	名称Description	数量Qty
1	PST50-1Z-J-001	Differtinal	差速器	1
2	PST50-1Z-J-002	Swing arm	后平叉	1
3	PST50-1Z-J-003	Rear brake	后碟刹	1
4	PST50-1Z-J-004	Chain cover	上链罩	1
5	PST50-1Z-J-005	Rear shock	后减	2
6	PST50-1Z-J-006	Chain	链条	1
7	PST50-1Z-J-007	Swing arm axle	后平叉轴	1
8	PST50-1Z-J-008	Engine axle	发动机轴	1
9	PST50-1Z-J-009	Swing arm supporting tube	后平叉撑管	1
10	PST50-1Z-J-010	Engine supporting tube	发动机撑管	1
11	PST50-1Z-J-011	Chain adjuster	调链器	2
12	PST50-1Z-J-012	Tire nut	轮胎螺母	8
13	PST50-1Z-J-013	Nut	M12螺母	6
14	PST50-1Z-J-014	Nut	12*40螺母	6
15	PST50-1Z-J-015	Nut	12*25螺母	4
16	PST50-1Z-J-016	Swing arm buffer bushing	后平叉缓冲衬套	2



序号 SR NO.	件号Part No.	名称Description	名称Description	数量Qty
1	PST50-1Z-K-001	Tail box	尾箱	1
2	PST50-1Z-K-002	Tail box bracket	尾箱支架	1

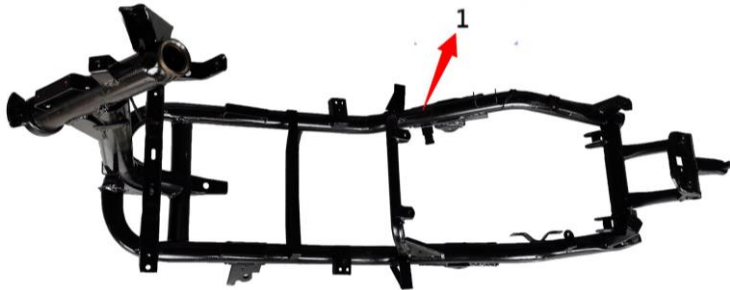

序号 SR NO.	件号Part No.	名称Description	名称Description	数量Qty
1	PST50-1Z-L-001	Frame	车架	1





序号 SR NO.	件号Part No.	名称Description	名称Description	数量Qty
1	PST50-1Z-M-001	Rear wheel fender	后轮泥板	2
2	PST50-1Z-M-002	Rear wheel fender bracket	后轮泥板支架	2
3	PST50-1Z-M-003	Rear wheel fender bracket upper	后轮泥板支架压板	2



序号 SR NO.	件号Part No.	名称Description	名称Description	数量Qty
1	PST50-1Z-N-001	Hood	头罩	1
2	PST50-1Z-N-002	Speedometer cover	仪表罩	1
3	PST50-1Z-N-003	Speedometer	仪表	1
4	PST50-1Z-N-004	Front left turning light	前左转向灯	1
5	PST50-1Z-N-005	Front right turning light	前右转向灯	1
6	PST50-1Z-N-006	Hood decoration	头罩装饰件	1
7	PST50-1Z-N-007	Speedometer secondary line 1	仪表副线1	1

8	PST50-1Z-N-008	Speedometer secondary line 2	仪表副线2	1
9	PST50-1Z-N-009	Speedometer secondary line 3	仪表副线3	1
10	PST50-1Z-N-010	Flameout switch	熄火开关	1
11	PST50-1Z-N-011	Horn switch	喇叭开关	1
12	PST50-1Z-N-012	Electric start switch	电启动开关	1
13	PST50-1Z-N-013	Left and right turning lights switch	左右转向灯开关	1
14	PST50-1Z-N-014	Far and near optical switch	远近光开关	1



序号 SR NO.	件号 Part NO.	名称 Description	名称 Description	数量Qty
1	PST50-1Z-O-001	Fuel tank	油箱	1
2	PST50-1Z-O-002	Main wire	导线	1
3	PST50-1Z-O-003	Regulator	稳压器	1
4	PST50-1Z-O-004	Tunsignal relay assy	闪光器	1
5	PST50-1Z-O-005	Starter relay	启动继电器	1
6	PST50-1Z-O-006	Ignition coil	高压泵	1
7	PST50-1Z-O-007	Fuel level sensors	油位传感器	1
8	PST50-1Z-O-008	Horn	喇叭	1
9	PST50-1Z-O-009	Fuel tank switch	油箱开关	1
10	PST50-1Z-O-010	Fuel level sensors pressure plate	油位传感器压板	1
11	PST50-1Z-O-011	Fuel level sensors rubber ring	油位传感器橡胶圈	1
12	PST50-1Z-O-012	Fuel tank cover	油箱盖	1



序号 SR NO.	件号 Part NO.	名称 Description	名称 Description	数量Qty
1	PST50-1Z-P-001	Rear tire	后轮胎	2
2	PST50-1Z-P-002	Rear rim	后轮毂	2
3	PST50-1Z-P-003	Chrome decorative cover	镀铬装饰盖	2
4	PST50-1Z-P-004	Tubeless Valve	气门嘴	2

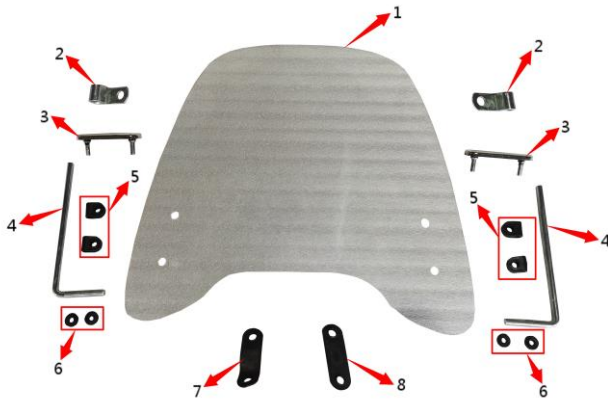

序号 SR NO.	件号 Part NO.	名称 Description	名称 Description	数量Qty
1	PST50-1Z-Q-001	Windshield	挡风玻璃	1
2	PST50-1Z-Q-002	Windshield attachment 1	挡风玻璃安装附件1	2
3	PST50-1Z-Q-003	Windshield attachment 2	挡风玻璃安装附件2	2
4	PST50-1Z-Q-004	Windshield attachment 3	挡风玻璃安装附件3	2
5	PST50-1Z-Q-005	Windshield attachment 4	挡风玻璃安装附件4	4
6	PST50-1Z-Q-006	Windshield attachment 5	挡风玻璃安装附件5	4
7	PST50-1Z-Q-007	Windshield attachment 6	挡风玻璃安装附件6	1
8	PST50-1Z-Q-008	Windshield attachment 7	挡风玻璃安装附件7	1