

REF. NO.	PART NO.	DESCRIPTION	CHINESE	Q.T.Y
1	PMZ50-1-A-001	FRONT COVER	前罩	1
2	PMZ50-1-A-002	DEFENDER OF HEAD LIGHT	前照灯保护罩	1
3	PMZ50-1-A-003	HEAD LIGHT	前照灯	1
4	PMZ50-1-A-004	SCREW	自攻螺钉	6
5	PMZ50-1-A-005	ACORSS BOLT	十字大盘头螺栓	4
6	PMZ50-1-A-006	FLANGE BOLT	六角法兰面螺母	4
7	PMZ50-1-A-007	SIDE COVER	前罩装饰条	1
8	PMZ50-1-A-008	FRONT fender	前轮挡泥板(烤漆)	1
			前轮挡泥板(水转印)	

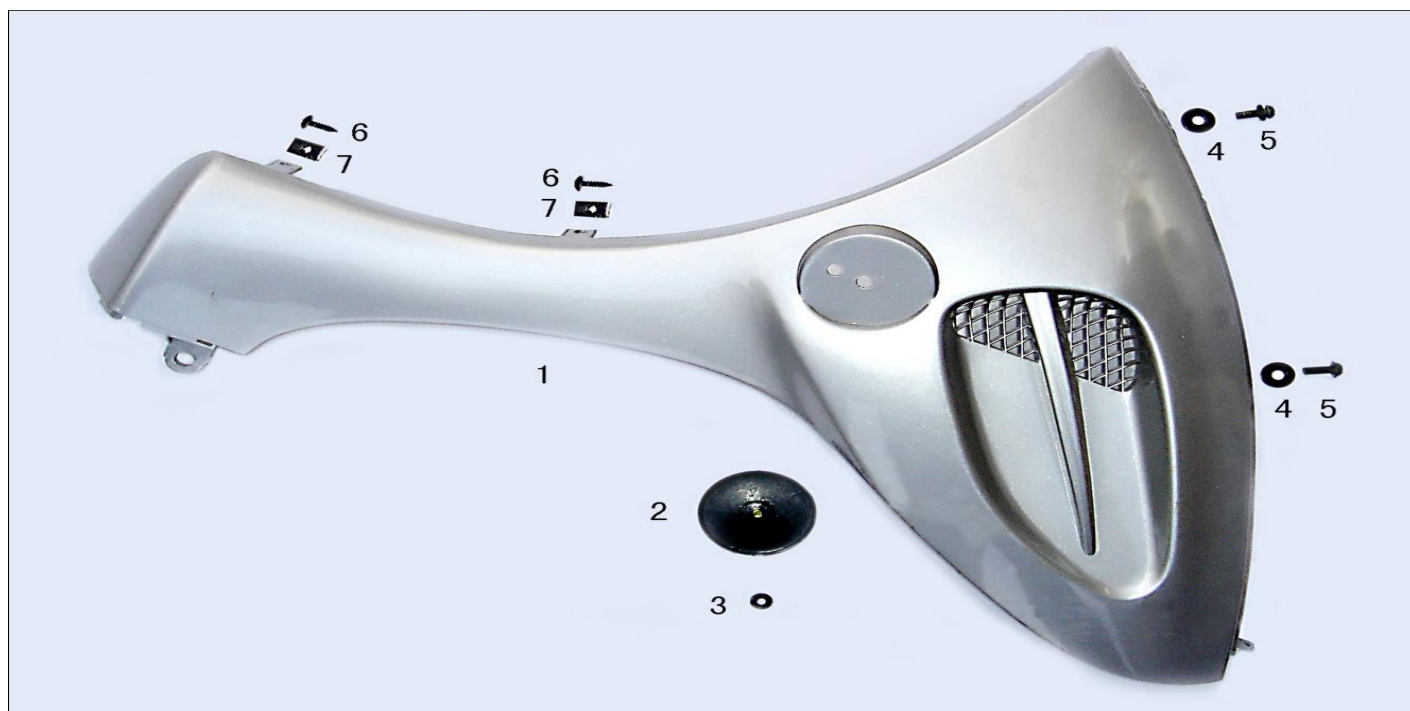

REF. NO.	PART NO.	DESCRIPTION	CHINESE	Q.T.Y
1	PMZ50-1-B-001	R. SIDE COVER	右护板	1
2	PMZ50-1-B-002	REFLECTER	侧反射器	1
3	PMZ50-1-B-003	FLANGE BOLT	六角法兰面螺母	1
4	PMZ50-1-B-004	ACROSS BOLT	十字盘头螺栓	2
5	PMZ50-1-B-005	WASHER	平垫	2
6	PMZ50-1-B-006	SCREW	自攻螺钉	2
7	PMZ50-1-B-007	LOCK PLATE	卡片	2

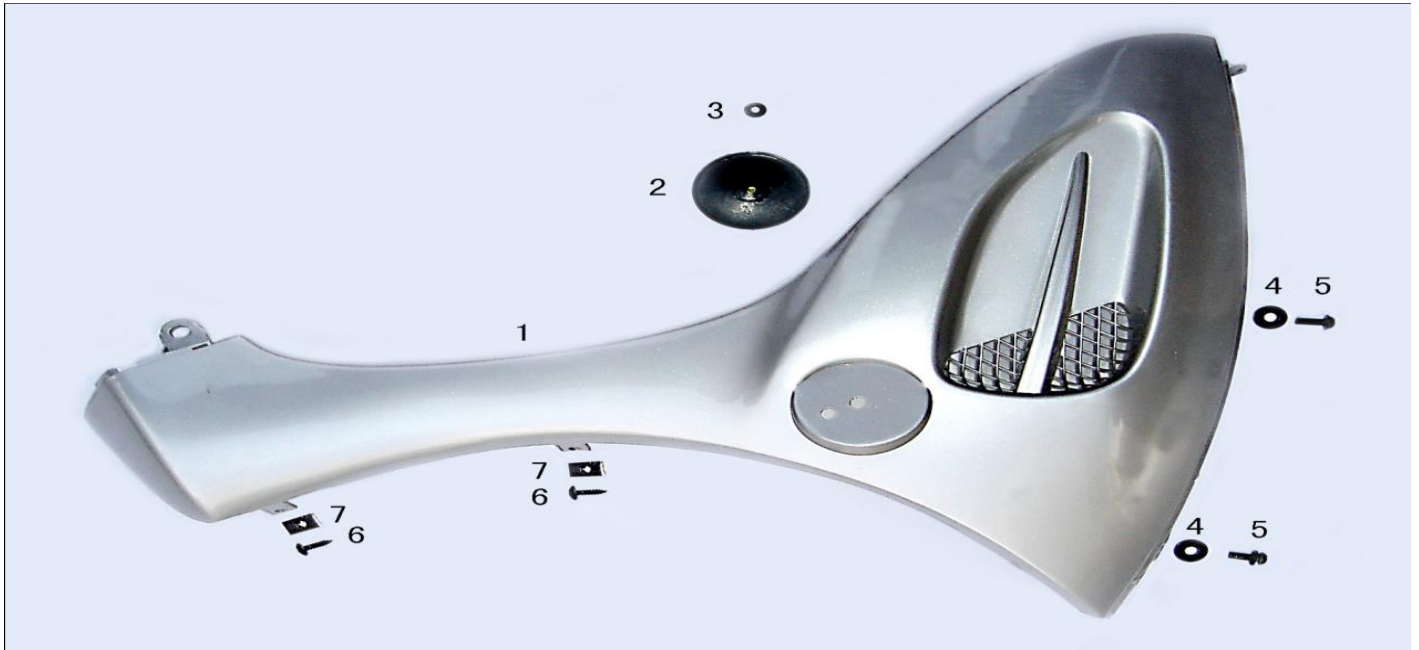

REF. NO.	PART NO.	DESCRIPTION	CHINESE	Q.T.Y
1	PMZ50-1-C-001	L SIDE COVER	左护板	1
2	PMZ50-1-C-002	REFLECTER	侧反射器	1
3	PMZ50-1-C-003	FLANGE BOLT	六角法兰面螺母	1
4	PMZ50-1-C-004	ACORSS BOLT	十字盘头螺栓	2
5	PMZ50-1-C-005	WASHER	平垫	2
6	PMZ50-1-C-006	SCREW	自攻螺钉	2
7	PMZ50-1-C-007	LOCK PLATE	卡片	2

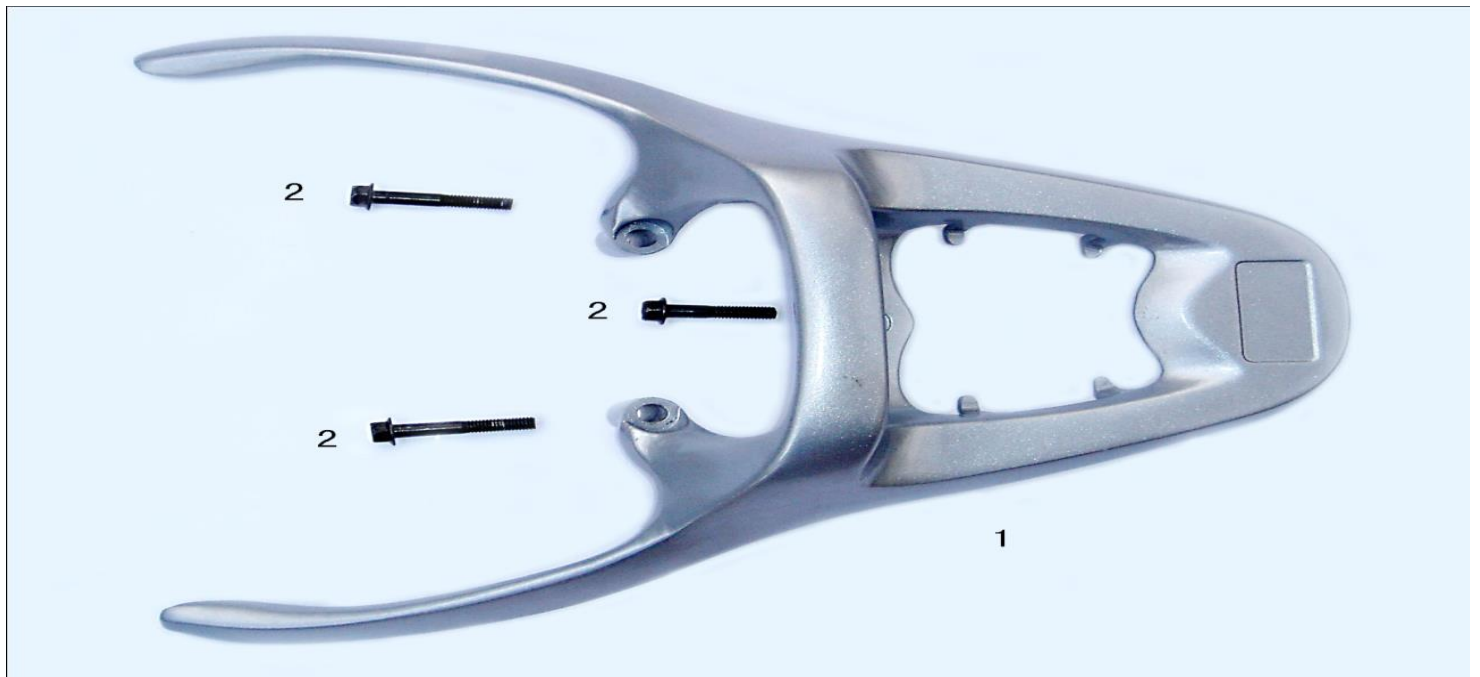

REF. NO.	PART NO.	DESCRIPTION	CHINESE	Q.T.Y
1	PMZ50-1-D-001	CARRIER	载物架	1
2	PMZ50-1-D-002	FLANGE BOLT	六角法兰面螺栓	3



REF. NO.	PART NO.	DESCRIPTION	CHINESE	Q.T.Y
1	PMZ50-1-E-001	SEAT	座垫	1
2	PMZ50-1-E-002	NUT	六角螺母	1
3	PMZ50-1-E-003	AXIAL OF SEAT	座垫轴	1



REF. NO.	PART NO.	DESCRIPTION	CHINESE	Q.T.Y
1	PMZ50-1-F-001	LUGGAGE BOX	杂物箱	1
2	PMZ50-1-F-002	INNER LID	杂物箱内盖	1
3	PMZ50-1-F-003	FRONT COVER LID	杂物箱前罩小盖	1
4	PMZ50-1-F-004	LUGGAGE BOX	杂物箱前罩	1
5	PMZ50-1-F-005	SCREW	自攻螺钉	2
6	PMZ50-1-F-006	FLANGE BOLT	六角法兰面螺母	2
7	PMZ50-1-F-007	ACROSS BOLT	十字大盘头螺栓	1
8	PMZ50-1-F-008	LOCK PLATE	卡片	1

9	PMZ50-1-F-009	LOCK PLATE	卡片	1
10	PMZ50-1-F-010	FLANGE BOLT	六角法兰面螺栓	2



REF. NO.	PART NO.	DESCRIPTION	CHINESE	Q.T.Y
1	PMZ50-1-G-001	LEFT SIDE COVER	左护条	1
2	PMZ50-1-G-002	RIGHT SIDE COVER	右护条	1
3	PMZ50-1-G-003	ACROSS BOLT	十字盘头带垫螺栓	2
4	PMZ50-1-G-004	SCREW	自攻螺钉	2



REF. NO.	PART NO.	DESCRIPTION	CHINESE	Q.T.Y
1	PMZ50-1-H-001	LEFT SIDE LACQUIRE	左装饰板	1
2	PMZ50-1-H-002	RIGHT SIDE LACQUIRE	右装饰板	1
3	PMZ50-1-H-003	MIDDLE LACQUIRE	中装饰板	1
4	PMZ50-1-H-004	LEFT AND RIGHT VENT	左右挡风隔	1
5	PMZ50-1-H-005	LOCK PLATE	锁卡片	1
6	PMZ50-1-H-006	SEAT LOCK	座垫锁	1
7	PMZ50-1-H-007	HOOK POSITION	安全帽挂钩固定板	1
8	PMZ50-1-H-008	HELMET HOOK	安全帽挂钩	1
9	PMZ50-1-H-009	ACROSS PLATE BOLT	十字盘头螺栓	1
10	PMZ50-1-H-010	SCREW	自攻螺钉	4
11	PMZ50-1-H-011	LOCK PLATE	卡片	2
12	PMZ50-1-H-012	SCREW	自攻螺钉	4
13	PMZ50-1-H-013	SCREW	自攻螺钉	2
14	PMZ50-1-H-014	SCREW	自攻螺钉	2

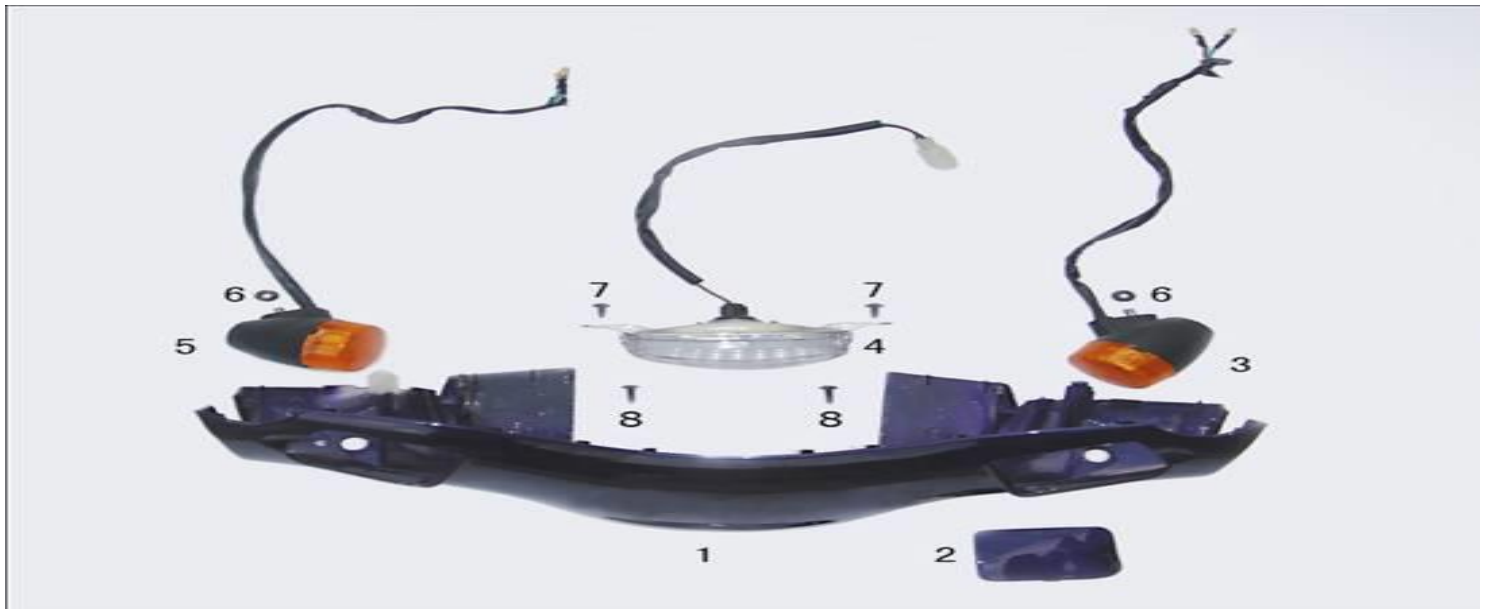

REF. NO.	PART NO.	DESCRIPTION	CHINESE	Q.T.Y
1	PMZ50-1-I-001	WIND SCREEN	挡风罩	1
2	PMZ50-1-I-002	LITTLE LID	挡风罩小盖板	1
3	PMZ50-1-I-003	F/L SIGNAL LAMP	前左转向灯	1
4	PMZ50-1-I-004	FRONT DECORATION	前装饰灯	1
5	PMZ50-1-I-005	RIGHT SIGNAL LAMP	前右转向灯	1
6	PMZ50-1-I-006	FLANGE BOLT	六角法兰面螺母	2

7	PMZ50-1-I-007	SCREW	自攻螺钉	2
8	PMZ50-1-I-008	SCREW	自攻螺钉	2

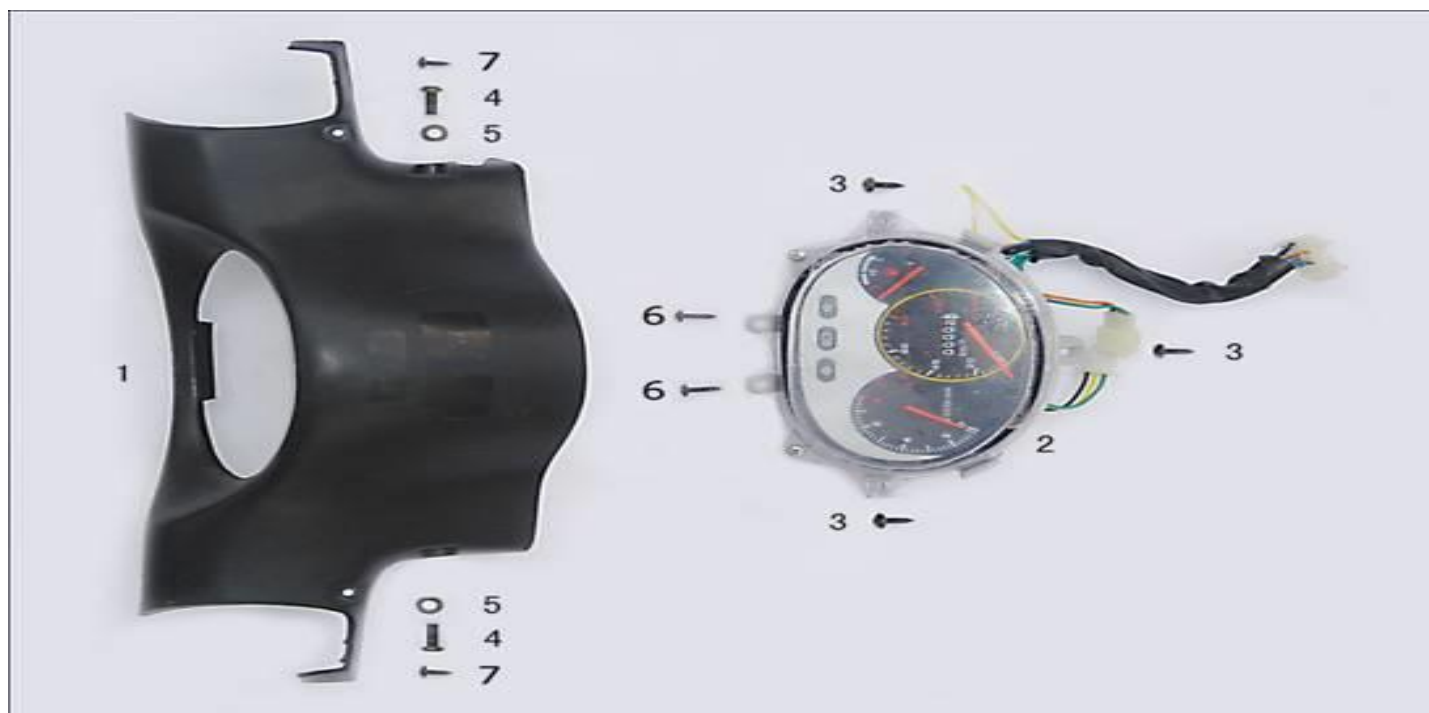

REF. NO.	PART NO.	DESCRIPTION	CHINESE	Q.T.Y
1	PMZ50-1-J-001	PANEL OF INSTRUMENT	仪表壳	1
2	PMZ50-1-J-002	SPEEDOMETER ASSAY	仪表总成 (冷光)	1
3	PMZ50-1-J-003	SCREW	自攻螺钉	3
4	PMZ50-1-J-004	ACROSS BOLT	十字盘头螺栓	2
5	PMZ50-1-J-005	WASHER	平垫	2
6	PMZ50-1-J-006	SCREW	自攻螺钉	2
7	PMZ50-1-J-007	SCREW	自攻螺钉	2



REF. NO.	PART NO.	DESCRIPTION	CHINESE	Q.T.Y
1	PMZ50-1-K-001	TOOL BOX	工具箱	1
2	PMZ50-1-K-002	TOOL BOX LID	工具箱盖	1
3	PMZ50-1-K-003	LOCK PLATE	锁卡片	1
4	PMZ50-1-K-004	LOCK OF TOOL BOX	工具箱锁	1
5	PMZ50-1-K-005	ARM OF LID	工具箱盖摇臂	2
6	PMZ50-1-K-006	SCREW	自攻螺钉	3
7	PMZ50-1-K-007	FLANGE BOLT	六角带垫螺栓	1



REF. NO.	PART NO.	DESCRIPTION	CHINESE	Q.T.Y
1	PMZ50-1-L-001	FRAME DEFENDER	车架挡泥板	1



REF. NO.	PART NO.	DESCRIPTION	CHINESE	Q.T.Y
1	PMZ50-1-M-001	FUEL TANK	油箱	1
2	PMZ50-1-M-002	SUCK HOSE	负压管	1
3	PMZ50-1-M-003	HOSE A	油管A	1
4	PMZ50-1-M-004	HOSE B	油管B	1
5	PMZ50-1-M-005	HOSE C	油管C	1
6	PMZ50-1-M-006	HOSE D	油管D	1
7	PMZ50-1-M-007	OIL MOUTH	油嘴	1
8	PMZ50-1-M-008	SWITCH	自吸开关	1
9	PMZ50-1-M-009	FUEL TANK LID	油箱盖	1
10	PMZ50-1-M-010	FUEL TENSOR	汽油传感器	1
11	PMZ50-1-M-011	SEAL	密封圈	1
12	PMZ50-1-M-012	TENSOR PRESSOR	传感器压板	1
13	PMZ50-1-M-013	FLANGE BOLT	六角法兰面螺栓	3
14	PMZ50-1-M-014	FLANGE NUT	六角法兰面螺母	2
15	PMZ50-1-M-015	NET	过滤网	1
16	PMZ50-1-M-016	CLIP	钢片卡簧	7
17	PMZ50-1-M-017	CLIP	钢丝卡簧	3
18	PMZ50-1-M-018	FUEL FLITER	汽油过滤器	1

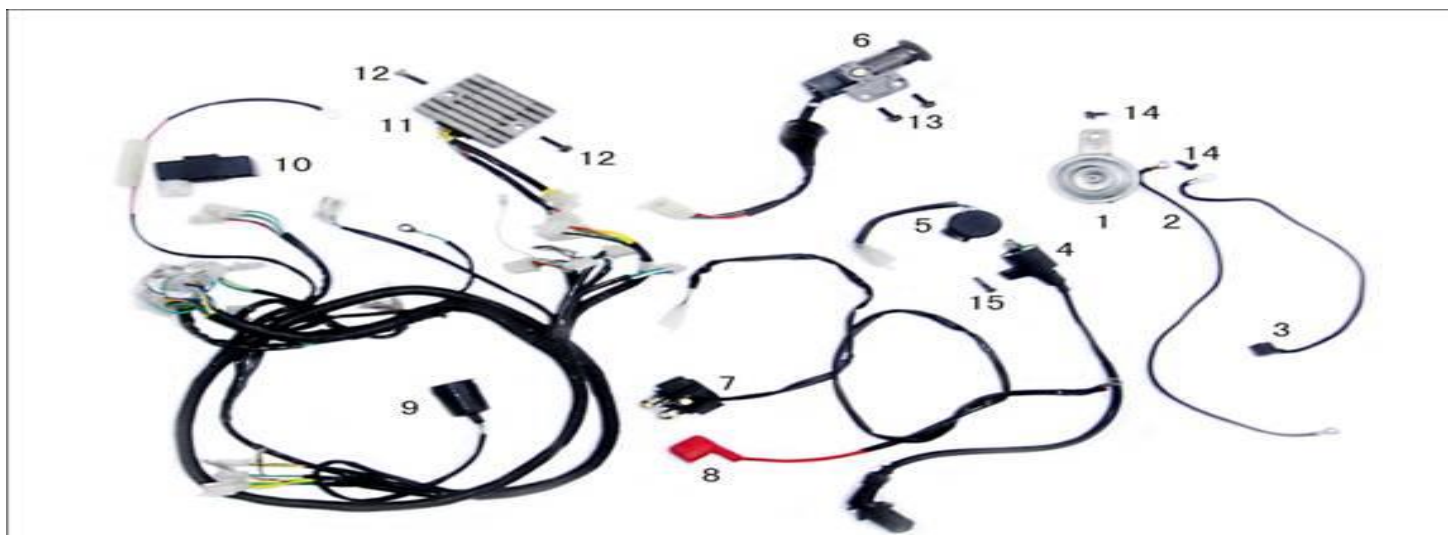

REF. NO.	PART NO.	DESCRIPTION	CHINESE	Q.T.Y
1	PMZ50-1-N-001	HORN	喇叭	1
2	PMZ50-1-N-002	LAND LINE A	接地线A	1
3	PMZ50-1-N-003	LAND LINE B	接地线B	1
4	PMZ50-1-N-004	IGNITION WIRE	点火线圈	1
5	PMZ50-1-N-005	FLASH	闪光器	1
6	PMZ50-1-N-006	IGNITION LOCK	点火开关	1
7	PMZ50-1-N-007	RELAY	起动继电器	1
8	PMZ50-1-N-008	RELAY WIRE	起动继电器线缆	1
9	PMZ50-1-N-009	MAIN WIRE	主电缆	1
10	PMZ50-1-N-010	CDI	点火器	1
11	PMZ50-1-N-011	REGULATOR	电压调节器	1
12	PMZ50-1-N-012	FLANG BOLT	六角法兰面螺栓	2
13	PMZ50-1-N-013	FLANG BOLT	六角法兰面螺栓	2
14	PMZ50-1-N-014	FLANG BOLT	六角法兰面螺栓	2
15	PMZ50-1-N-015	ACROSS BOLT	十字盘头螺栓	1

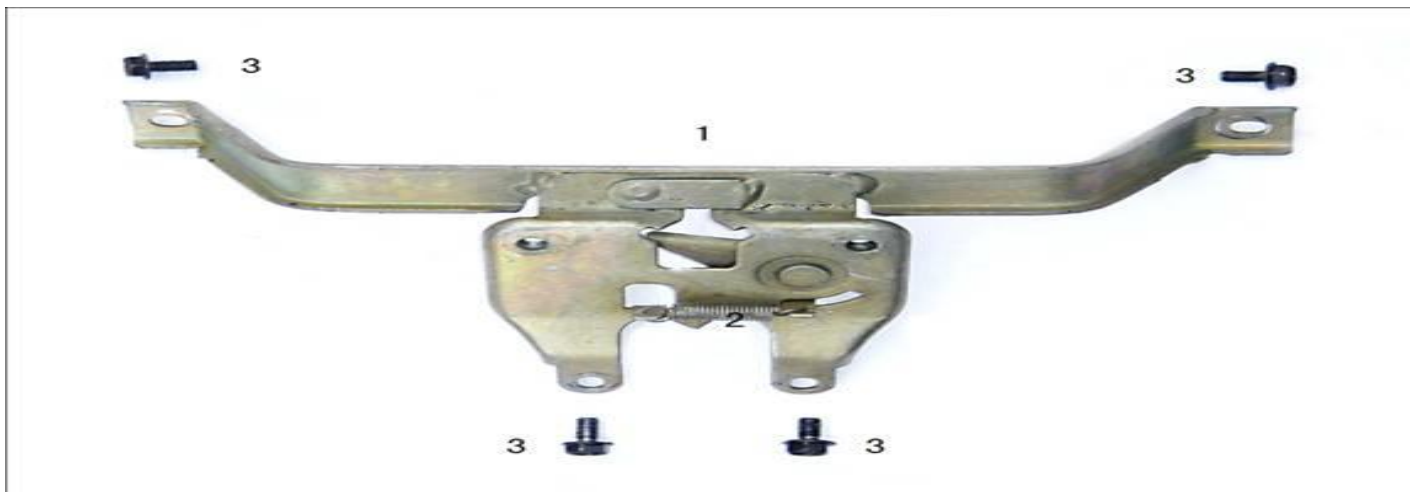

REF. NO.	PART NO.	DESCRIPTION	CHINESE	Q.T.Y
1	PMZ50-1-O-001	SEAT LOCK POSITION	座垫锁支架	1
2	PMZ50-1-O-002	SPRING	弹簧	1
3	PMZ50-1-O-003	FLANGE BOLT	六角法兰面螺栓	4



REF. NO.	PART NO.	DESCRIPTION	CHINESE	Q.T.Y
1	PMZ50-1-P-001	COUNTER	计数器	1
2	PMZ50-1-P-002	SPEEDOMETER SOFT AXIAL	里程表软轴	1
3	PMZ50-1-P-003	ACROSS BOLT	十字沉头螺栓	1



REF. NO.	PART NO.	DESCRIPTION	CHINESE	Q.T.Y
1	PMZ50-1-Q-001	HANDLE BAR	方向把	1
2	PMZ50-1-Q-002	LEFT GRIP	左把套	1
3	PMZ50-1-Q-003	LEFT COMBINATION SWITCH	左组合开关	1
4	PMZ50-1-Q-004	LEFT C. SWITCH COVER	左组合开关盖	1
5	PMZ50-1-Q-005	BALANCE PLATE OF HANDLE BAR	方向把平衡块	2
6	PMZ50-1-Q-006	THROTTLE GRIP	油门转把	1
7	PMZ50-1-Q-007	R. C. SWITCH	右组合开关	1
8	PMZ50-1-Q-008	R. C. SWITCH COVER	右组合开关盖	1
9	PMZ50-1-Q-009	THROTTLE CABLE	油门线	1

10	PMZ50-1-Q-010	ACROSS BOLT	十字盘头螺栓	1
11	PMZ50-1-Q-011	ACROSS BOLT	十字盘头螺栓	1
12	PMZ50-1-Q-012	ACROSS BOLT	十字盘头螺栓	1
13	PMZ50-1-Q-013	ACROSS BOLT	十字盘头螺栓	1

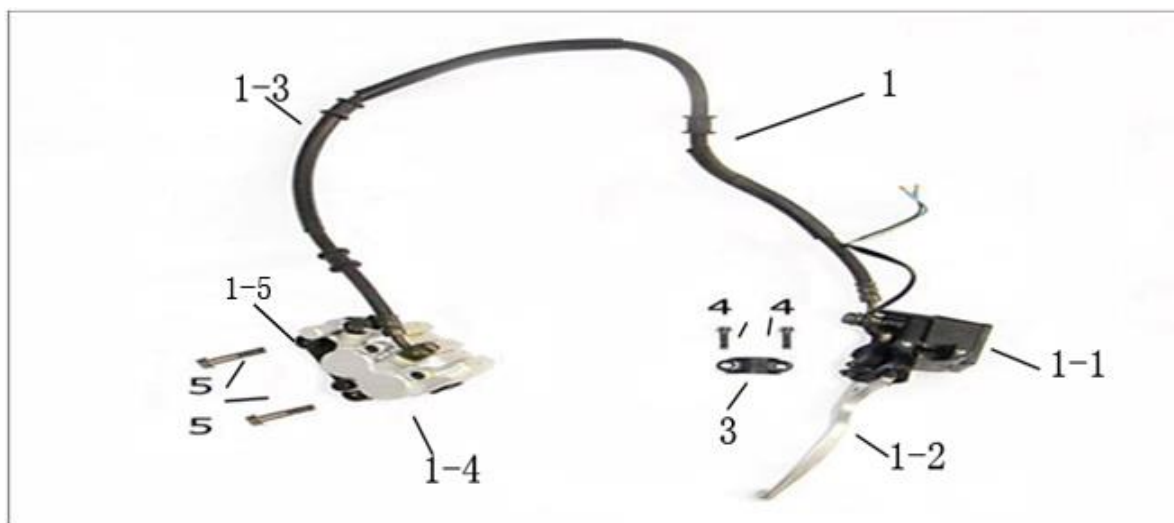

REF. NO.	PART NO.	DESCRIPTION	CHINESE	Q.T.Y
1	PMZ50-1-R-001	Front brake assembly	前碟刹	1
1-1	PMZ50-1-R-002	Master cylinder	碟刹上泵	1
1-2	PMZ50-1-R-003	brake lever	碟刹手柄	1
1-3	PMZ50-1-R-004	Brake Line	碟刹油管	1
1-4	PMZ50-1-R-005	Brake Caliper	碟刹下泵	1
1-5	PMZ50-1-R-006	Brake Pad	摩擦片	2
2	PMZ50-1-R-007	DOWN PUMP	碟刹下泵	1
3	PMZ50-1-R-008	POSITION OF PUMP	上泵固定座	1
4	PMZ50-1-R-009	FLANGE BOLT	六角法兰面螺栓	2
5	PMZ50-1-R-010	FLANGE BOLT	六角法兰面螺栓	2



REF. NO.	PART NO.	DESCRIPTION	CHINESE	Q.T.Y
1	PMZ50-1-S-001	CARBURETOR	化油器总成	1

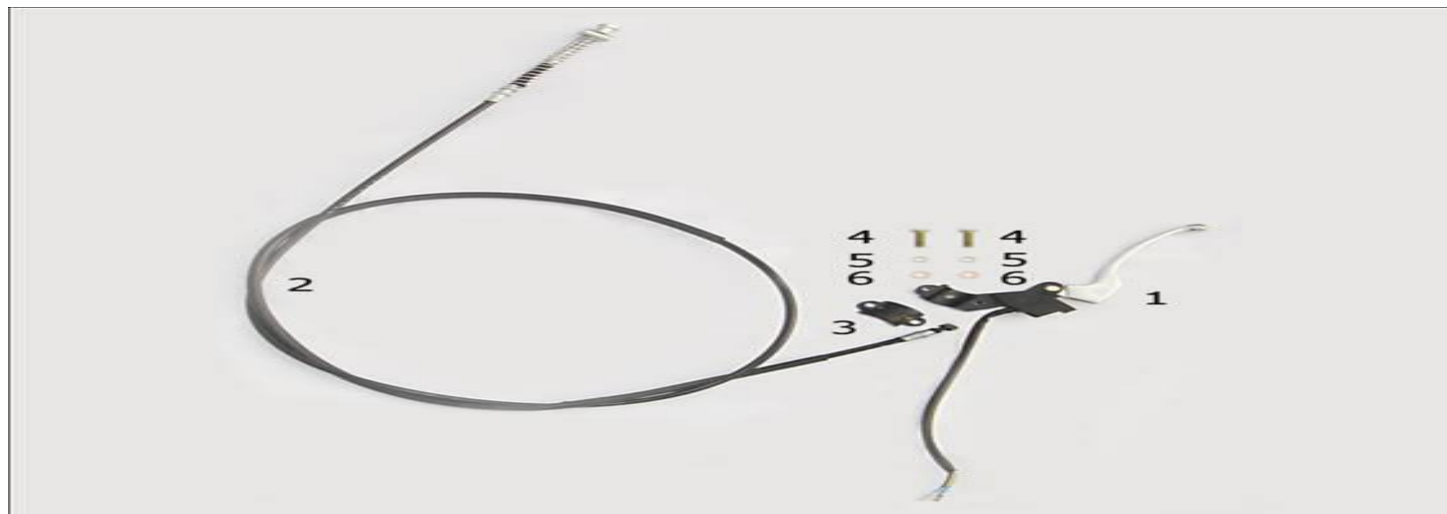

REF. NO.	PART NO.	DESCRIPTION	CHINESE	Q.T.Y
1	PMZ50-1-T-001	REAR BRAKE GRIP	后制动握把	1
2	PMZ50-1-T-002	REAR BRAK CABLE	后制动线	1
3	PMZ50-1-T-003	REAR BRAKE GRIP UPPER POSITION	后制动握把固定上盖	1
4	PMZ50-1-T-004	BOLT	六角螺栓	2
5	PMZ50-1-T-005	SPRING WASHER	弹簧垫圈	2
6	PMZ50-1-T-006	WASHER	平垫	2

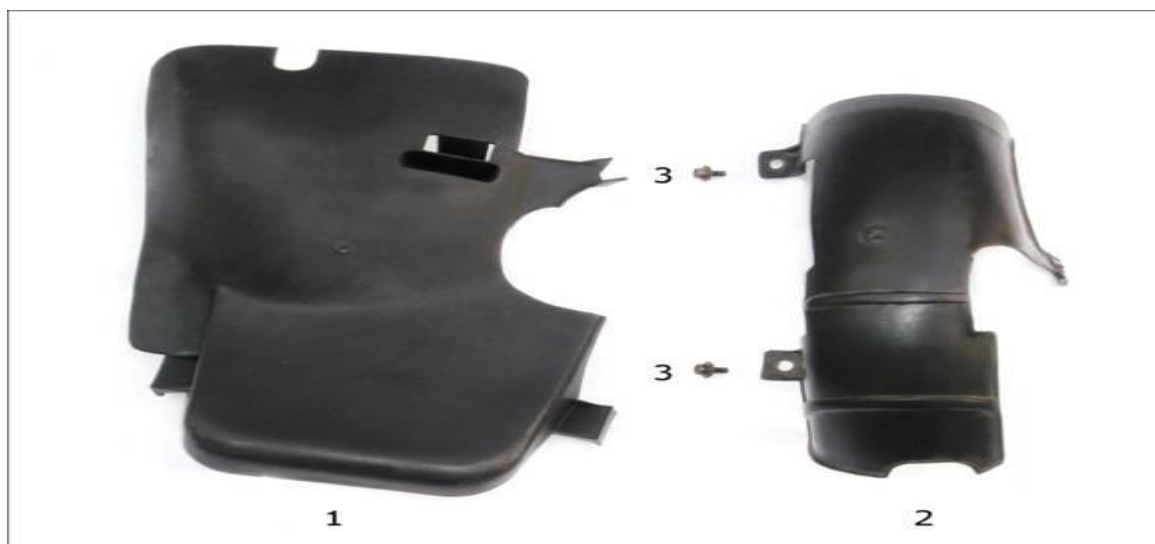

REF. NO.	PART NO.	DESCRIPTION	CHINESE	Q.T.Y
1	PMZ50-1-U-001	FRAME DEFENDER, REAR	车架后部挡泥板	1
2	PMZ50-1-U-002	REAR WHEEL DEFENDER	后轮挡泥板	1
3	PMZ50-1-U-003	AXIAL BOLT	六角轴位螺栓	2



REF. NO.	PART NO.	DESCRIPTION	CHINESE	Q.T.Y
1	PMZ50-1-V-001	TIRE	轮胎	1
2	PMZ50-1-V-002	BUSH	前轮隔套	1
3	PMZ50-1-V-003	FRONT WHEEL AXIAL	前轮轴	1
4	PMZ50-1-V-004	LOCK NUT	六角法兰面自锁螺母	1
5	PMZ50-1-V-005	WHEEL	铝轮	1
6	PMZ50-1-V-006	DISK	碟刹盘	1
7	PMZ50-1-V-007	FLANGE BOLT	内六角平头螺栓	3



REF. NO.	PART NO.	DESCRIPTION	CHINESE	Q.T.Y
1	PMZ50-1-W-001	HANDLE BAR	方向柱	1
2	PMZ50-1-W-002	RIGHT CUSSHION	右减震器	1
3	PMZ50-1-W-003	LEFT CUSSHION	左减震器	1
4	PMZ50-1-W-004	SOFT AXIAL	里程表软轴夹	1
5	PMZ50-1-W-005	UPPER BOWL, RAISED	上凸钢碗	1
6	PMZ50-1-W-006	DOWN BOWL, INDENTATION	上凹钢碗	1

7	PMZ50-1-W-007	UPPER KEEPER	上保持器	1
8	PMZ50-1-W-008	DOWN KEEPER	下保持器	1
9	PMZ50-1-W-009	DOWN BOWL, INDENTATION	下凹钢碗	1
10	PMZ50-1-W-010	LOCK NUT	锁紧螺母	1
11	PMZ50-1-W-011	FLANGE BOLT	六角法兰面螺栓	4
12	PMZ50-1-W-012	FLANGE BOLT	六角法兰面螺栓	2
13	PMZ50-1-W-013	HOSE CLAMP	液压管夹	1
14	PMZ50-1-W-014	FLANGE BOLT	六角法兰面螺栓	2



REF. NO.	PART NO.	DESCRIPTION	CHINESE	Q.T.Y
1	PMZ50-1-X-001	TYRE	轮胎	1
2	PMZ50-1-X-002	SHOE A	刹车蹄块A	1
3	PMZ50-1-X-003	SHOE B	刹车蹄块B	1
4	PMZ50-1-X-004	SHOE RETURN SPRING	刹车蹄块回位弹簧	2
5	PMZ50-1-X-005	ARM AXIAL	刹车摇臂轴	1
6	PMZ50-1-X-006	ARM	刹车摇臂	1
7	PMZ50-1-X-007	FLANGE	六角法兰面螺栓	1
8	PMZ50-1-X-008	LOCK NUT	六角自锁螺母	1
9	PMZ50-1-X-009	REAR ALMIUM WHEEL	后铝轮	1



REF. NO.	PART NO.	DESCRIPTION	CHINESE	Q.T.Y
----------	----------	-------------	---------	-------

1	PMZ50-1-Y-001	L. REAR-SIGHT MIRROR	左后视镜	1
2	PMZ50-1-Y-002	R. REAR-SIGHT MIRROR	右后视镜	1
3	PMZ50-1-Y-003	FLANGE NUT	六角法兰面螺母	2



REF. NO.	PART NO.	DESCRIPTION	CHINESE	Q.T.Y
1	PMZ50-1-Z-001	SIDE STANDER	单撑	1
2	PMZ50-1-Z-002	SPRING	单撑弹簧	1
3	PMZ50-1-Z-003	STAND FIXED BOLT	单撑固定螺栓	1



REF. NO.	PART NO.	DESCRIPTION	CHINESE	Q.T.Y
1	PMZ50-1-AA-001	RAER CUSSHION	后减震器	1
2	PMZ50-1-AA-002	HUNGER	吊架	1

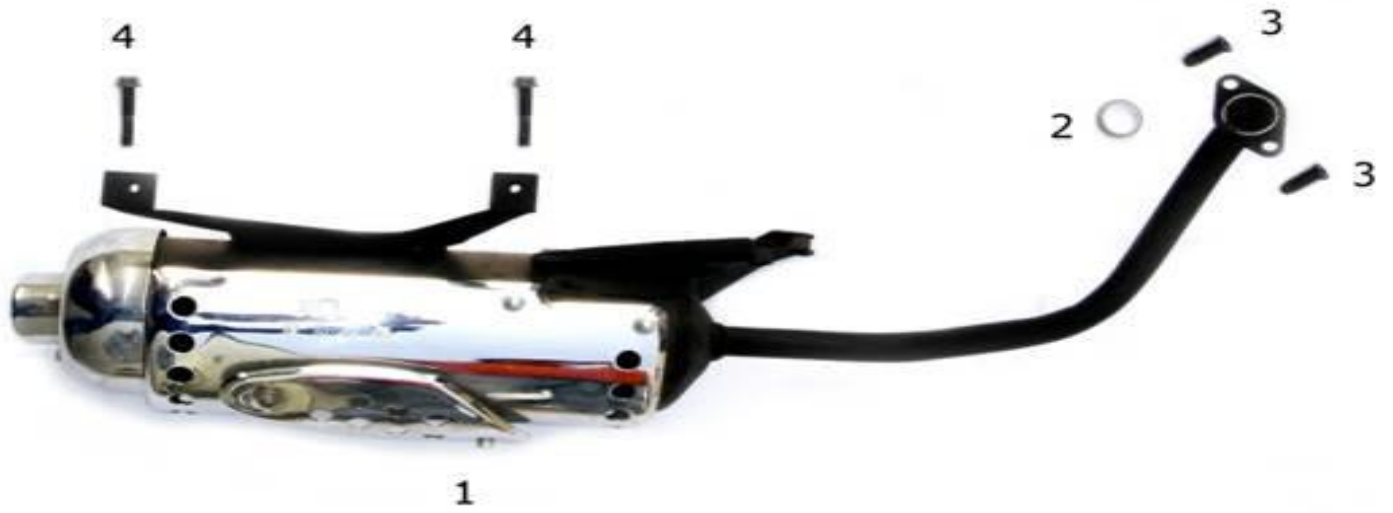

REF. NO.	PART NO.	DESCRIPTION	CHINESE	Q.T.Y
1	PMZ50-1-BB-001	MUFFLER	铝筒消声器	1
2	PMZ50-1-BB-002	OIL SEAL	密封垫圈	1
3	PMZ50-1-BB-003	LID SHAPED NUT	盖形螺母	2
4	PMZ50-1-BB-004	FLANGE BOLT	六角法兰面螺栓	2

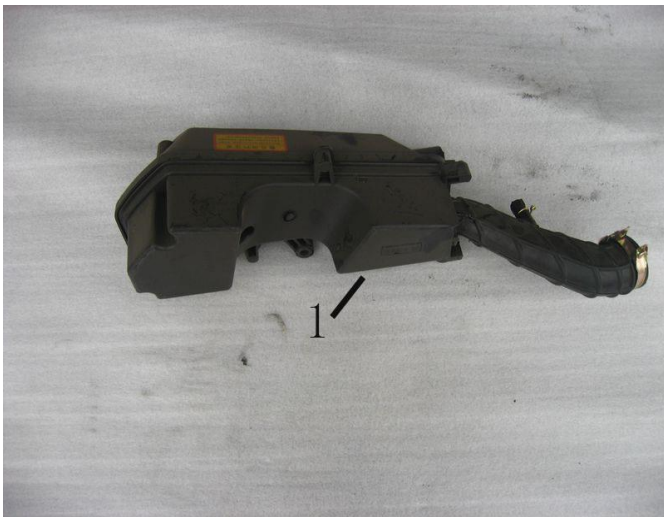

REF. NO.	PART NO.	DESCRIPTION	CHINESE	Q.T.Y
1	PMZ50-1-CC-001	SHELL OF FLITER	空气滤总成	1

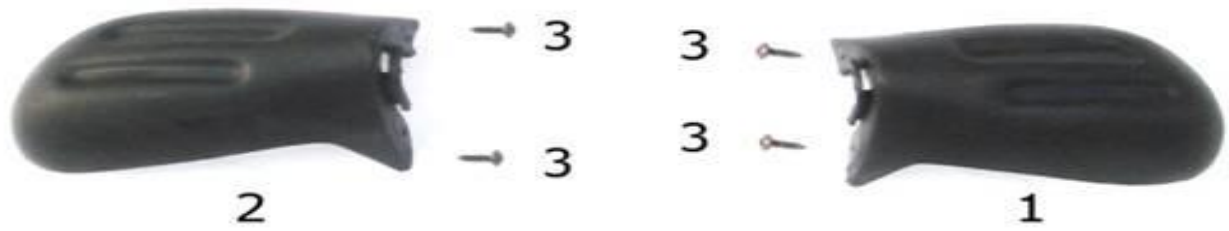

REF. NO.	PART NO.	DESCRIPTION	CHINESE	Q.T.Y
1	PMZ50-1-DD-001	GRIP SAFEGUARD L	左挡风壳	1
2	PMZ50-1-DD-002	GRIP SAFEGUARD R	右挡风壳	1
3	PMZ50-1-DD-003	SCREW	自攻螺钉	4



REF. NO.	PART NO.	DESCRIPTION	CHINESE	Q.T.Y
1	PMZ50-1-EE-001	ENGINE ASSAY	发动机总成	1
2	PMZ50-1-EE-002	CLIP	卡箍	1
3	PMZ50-1-EE-003	CRANKCASE -L HOSE	左盖通气管	1

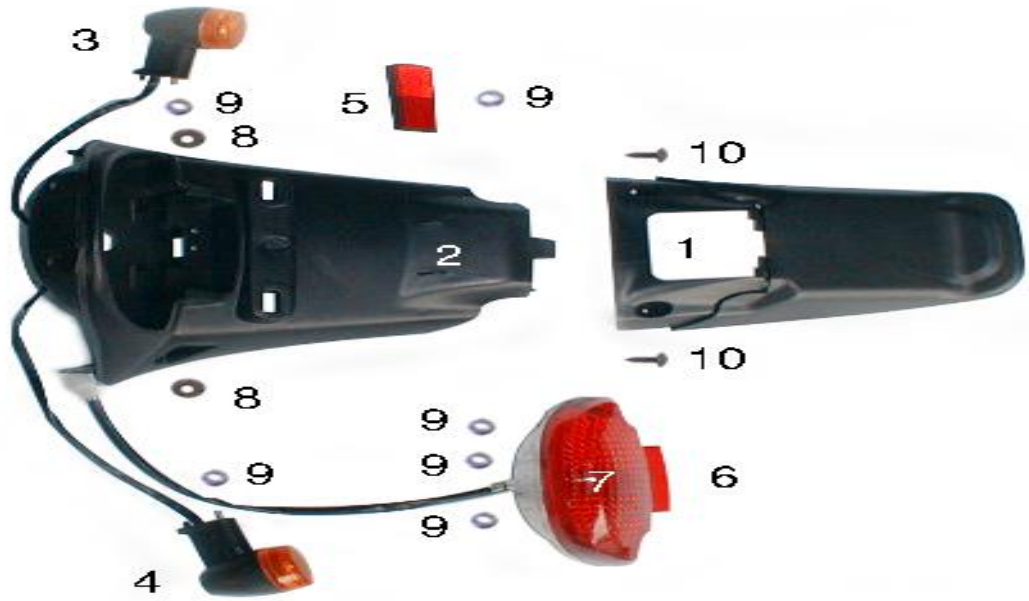

REF. NO.	PART NO.	DESCRIPTION	CHINESE	Q.T.Y
1	PMZ50-1-FF-001	REAR DEFENDER(B)	后挡泥板(B)	1
2	PMZ50-1-FF-002	REAR DEFENDER(B)	后挡泥板(B)	
3	PMZ50-1-FF-003	R/R SIGNAL LAMP	后右转向灯	1
4	PMZ50-1-FF-004	L/R SIGNAL LAMP	后左转向灯	1
5	PMZ50-1-FF-005	REFLECTER	方反射器	1
6	PMZ50-1-FF-006	REAR TAIL ASSAY	后尾灯总成	1
7	PMZ50-1-FF-007	BULB,stop,STANLEY	尾灯灯泡	1
8	PMZ50-1-FF-008	WASH	平垫	2
9	PMZ50-1-FF-009	NUT	六角法兰面螺母	6
10	PMZ50-1-FF-010	SCREW	自攻螺钉	2

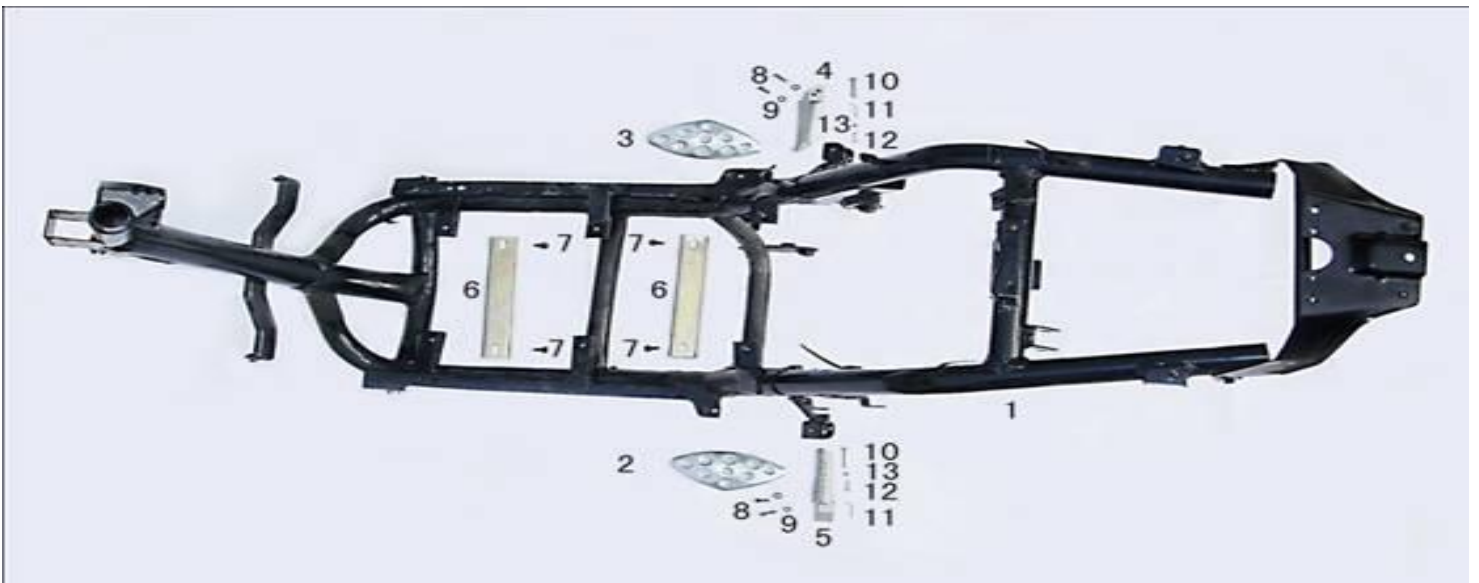

REF. NO.	PART NO.	DESCRIPTION	CHINESE	Q.T.Y
1	PMZ50-1-GG-001	FRAME ASSAY	车架焊接组件	1
2	PMZ50-1-GG-002	L VENT PANEL	左透风板	1
3	PMZ50-1-GG-003	R VENT PANEL	右透风板	1
4	PMZ50-1-GG-004	R/R FOOT PANEL	后右脚踏	1
5	PMZ50-1-GG-005	L/R FOOT PANEL	后左脚踏	1
6	PMZ50-1-GG-006	FOOT PANEL SIDE COVER	脚踏板护条	2
7	PMZ50-1-GG-007	FLANGE BOLT	六角法兰面螺栓	4
8	PMZ50-1-GG-008	ACROSS BOLT	十字盘头螺栓	4
9	PMZ50-1-GG-009	WASHER	平垫	4
10	PMZ50-1-GG-010	AXIAL	销轴	2
11	PMZ50-1-GG-011	KEY	卡销	2
12	PMZ50-1-GG-012	SPRING	弹簧	1
13	PMZ50-1-GG-013	BALL	钢珠	2



序号 SR NO.	件号 PART NO.	名称 Description	名称 Description	数量 Qty
1	PMZ50-1-HH-001	battery	蓄电池	1
2	PMZ50-1-HH-002	electrolyte	电解液	1
3	PMZ50-1-HH-003	parts for installation	安装附件	1

