

# ICEBEAR

## PAZ125-1

Parts Diagram & Catalog



Sec.	Description	Sec.	Description
A	Seat Assembly	M	Rear Swing Arm & Rear Shock
B	Engine Cover	N	Headlight & Mirrors
C	Front Cover	O	Electrical Components
D	Plastic Body	P	Chain & Tensioner
E	Frame	Q	Steering Linkage
F	Instrument Panel & Switches	R	Wheel Hubs & Brake Discs
G	Windshield	S	Engine & Exhaust
H	Handrail	T	Gear Changer & Pedals
I	Footboard	U	Brake Linkage
J	Steering Column	V	Battery
K	Spare Tire & Fuel Tank Mount	W	Tires & Rims
L	Front Swing Arm & Front Shock	X	Fuel Tank

## SECTION A Seat Assembly



NO.	Part Number	Description	QTY
1	PAZ125-1-A-1	Seat	5+
	PAZ125-1-A-1-2	Seat backrest	
2	PAZ125-1-A-2	Seat Slide	7+

## SECTION B Engine Cover

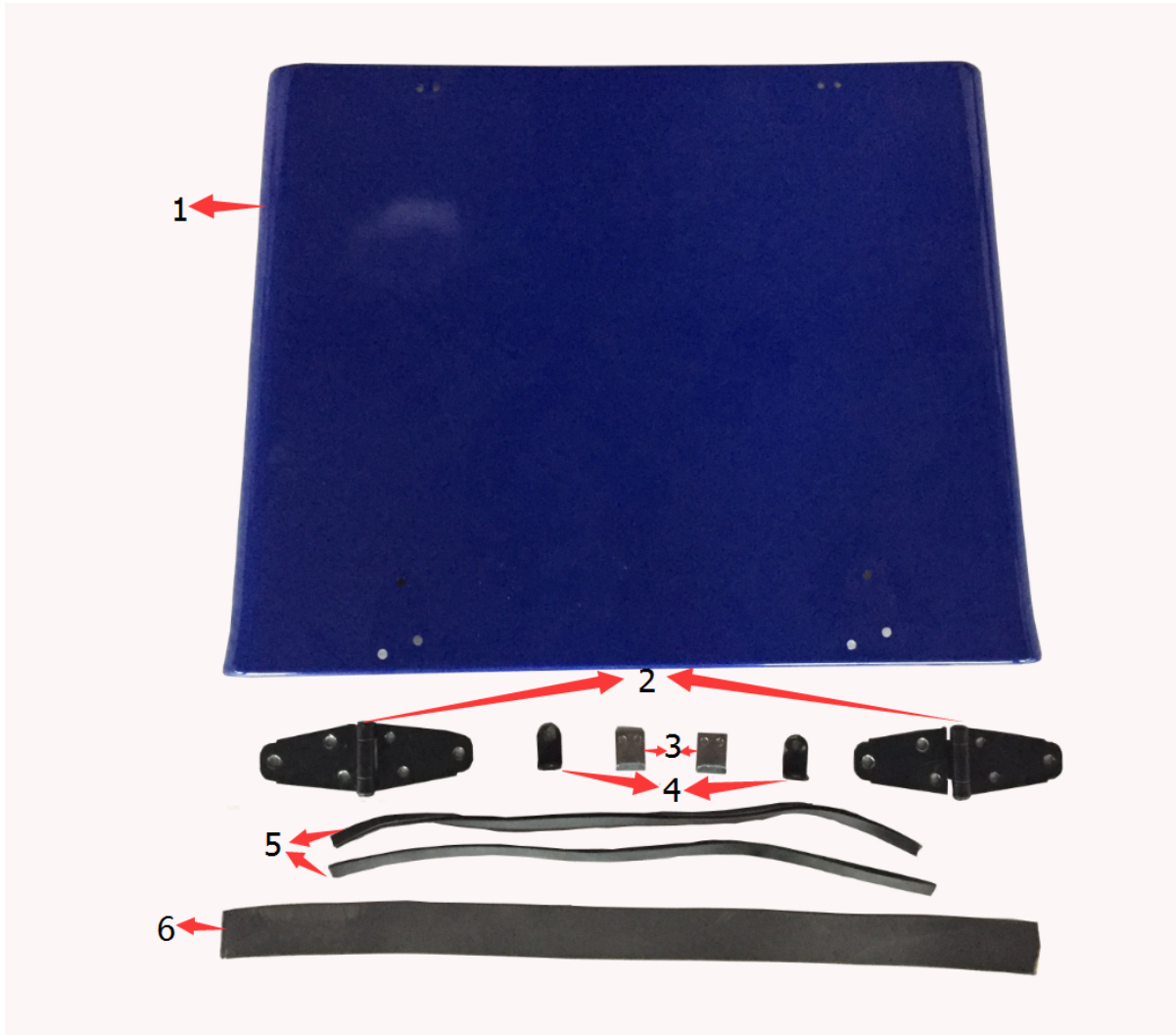

NO.	Part Number	Description	QTY
1	PAZ125-1-B-1	Enigne cover	1
2	PAZ125-1-B-2	Enigne cover Hinge	2
3	PAZ125-1-B-3	Lock catch	2
4	PAZ125-1-B-4	Windshield stand	2
5	PAZ125-1-B-5	Cushioning rubber	2
6	PAZ125-1-B-6	Big cushioning rubber	1

## SECTION C Front Cover

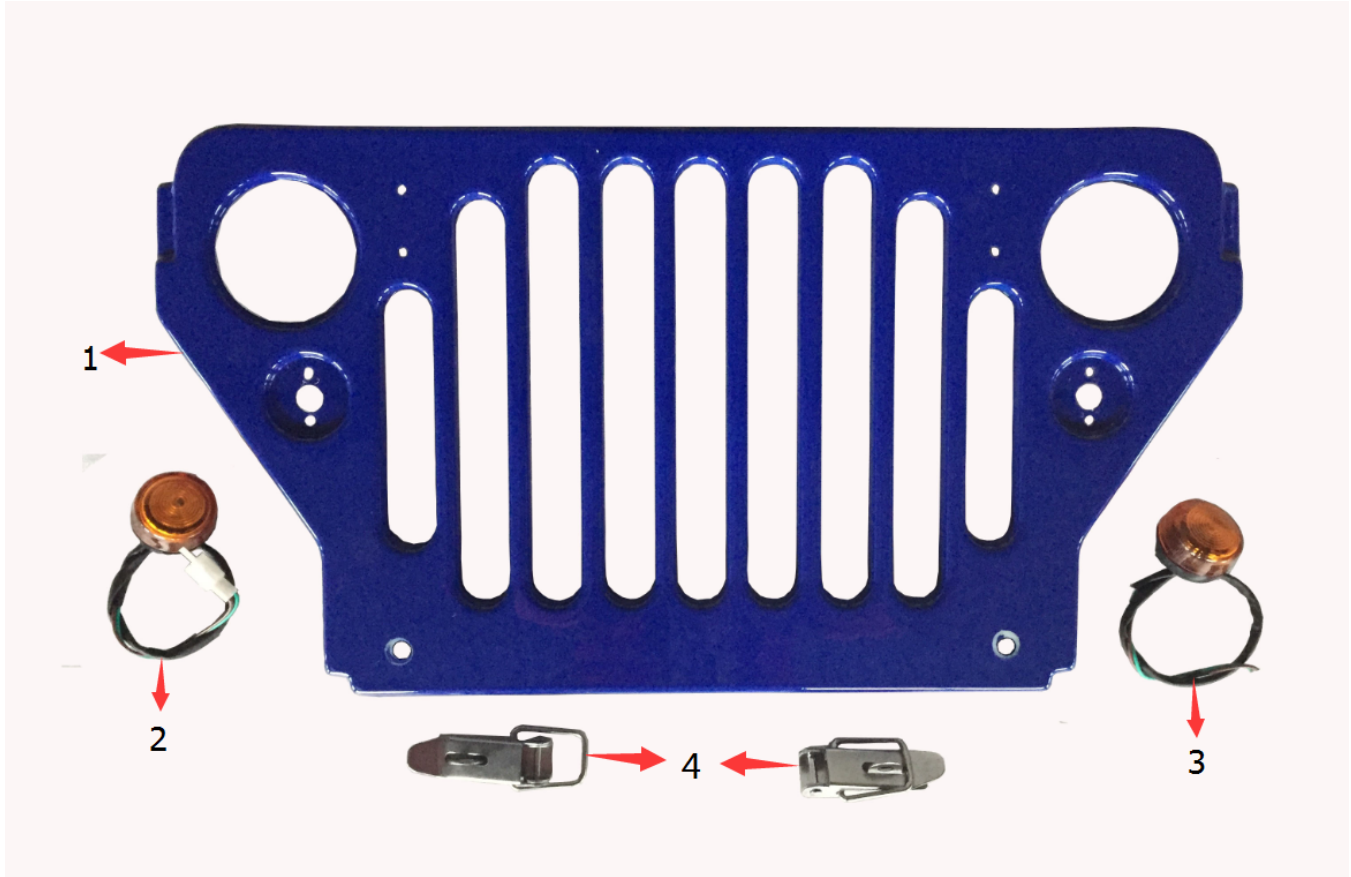

NO.	Part Number	Description	QTY
1	PAZ125-1-C-1	Front cover	1
2	PAZ125-1-C-2	Front right turn lamp	1
3	PAZ125-1-C-3	Front left turn lamp	1
4	PAZ125-1-C-4	Engine cover lock	2

## SECTION D Plastic Body

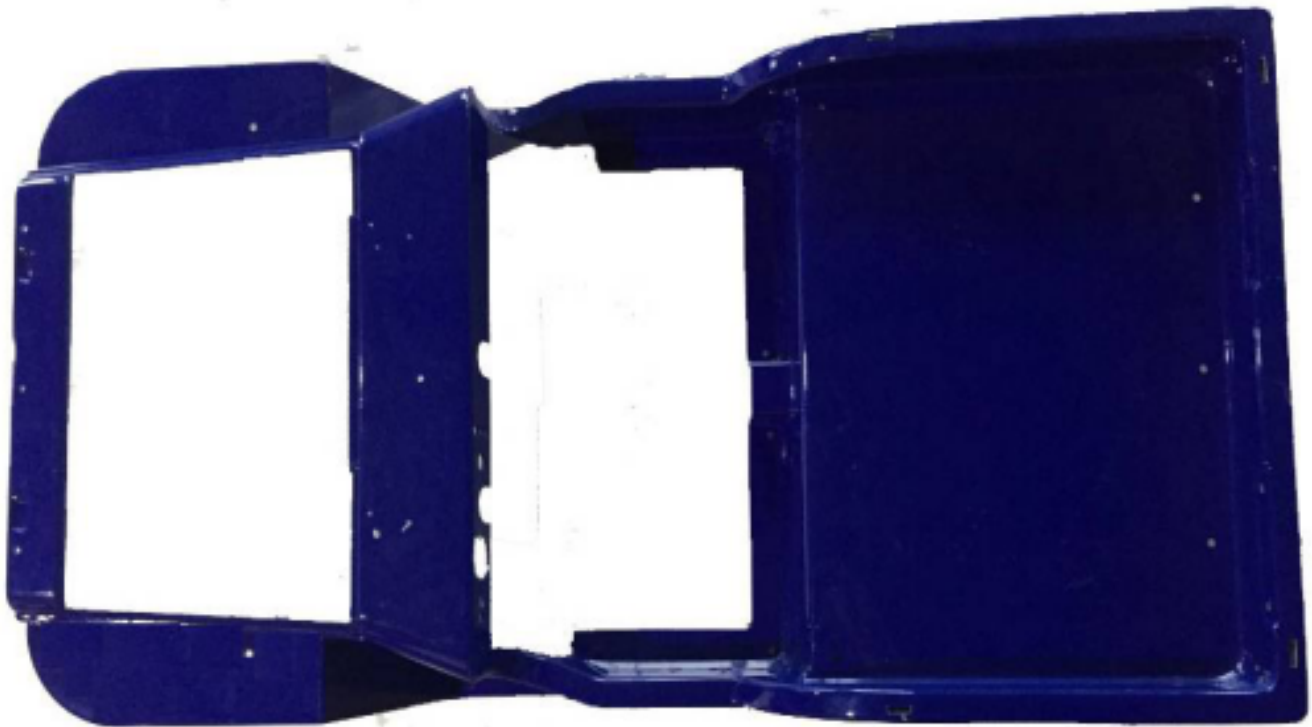

NO.	Part Number	Description	QTY
1	PAZ125-1-D-1	Plastic body(no paint)	1
2	PAZ125-1-D-2	Plastic body with paint	1

## SECTION E Frame

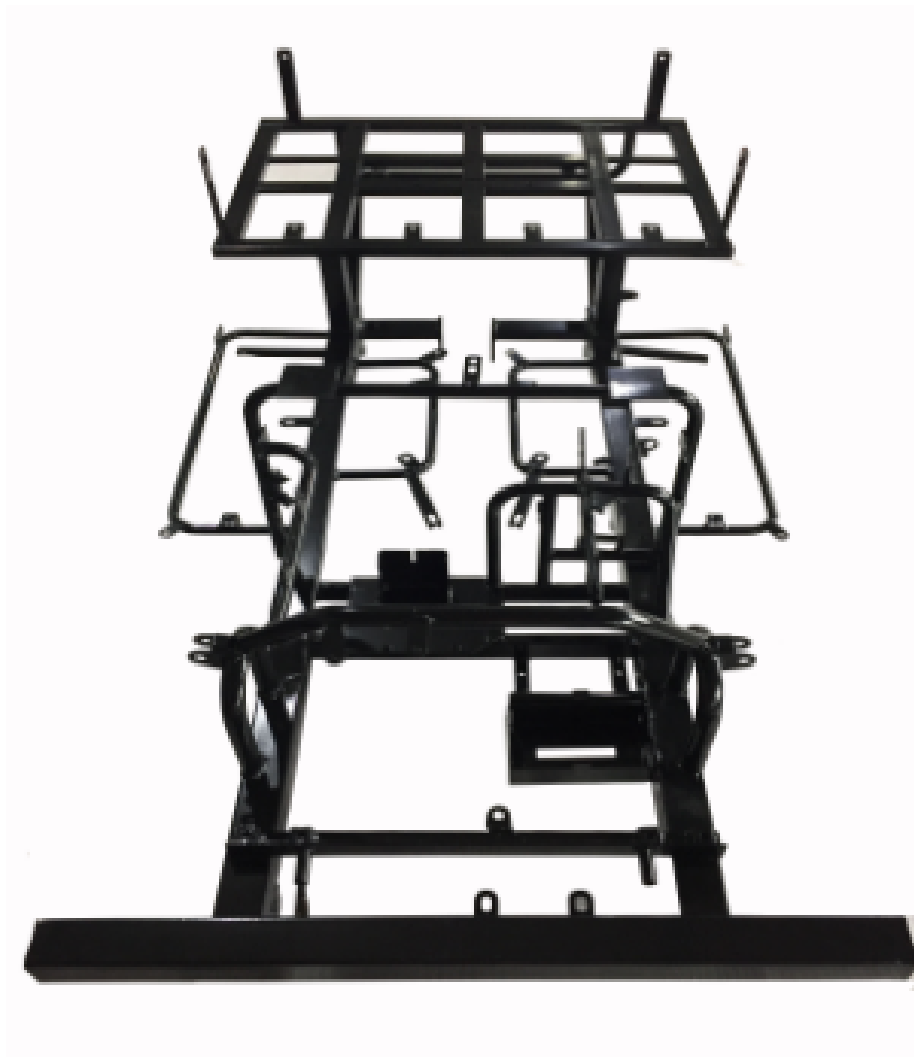

NO.	Part Number	Description	QTY
1	PAZ125-1-E-1	Frame	1

## SECTION F Instrument Panel & Switches

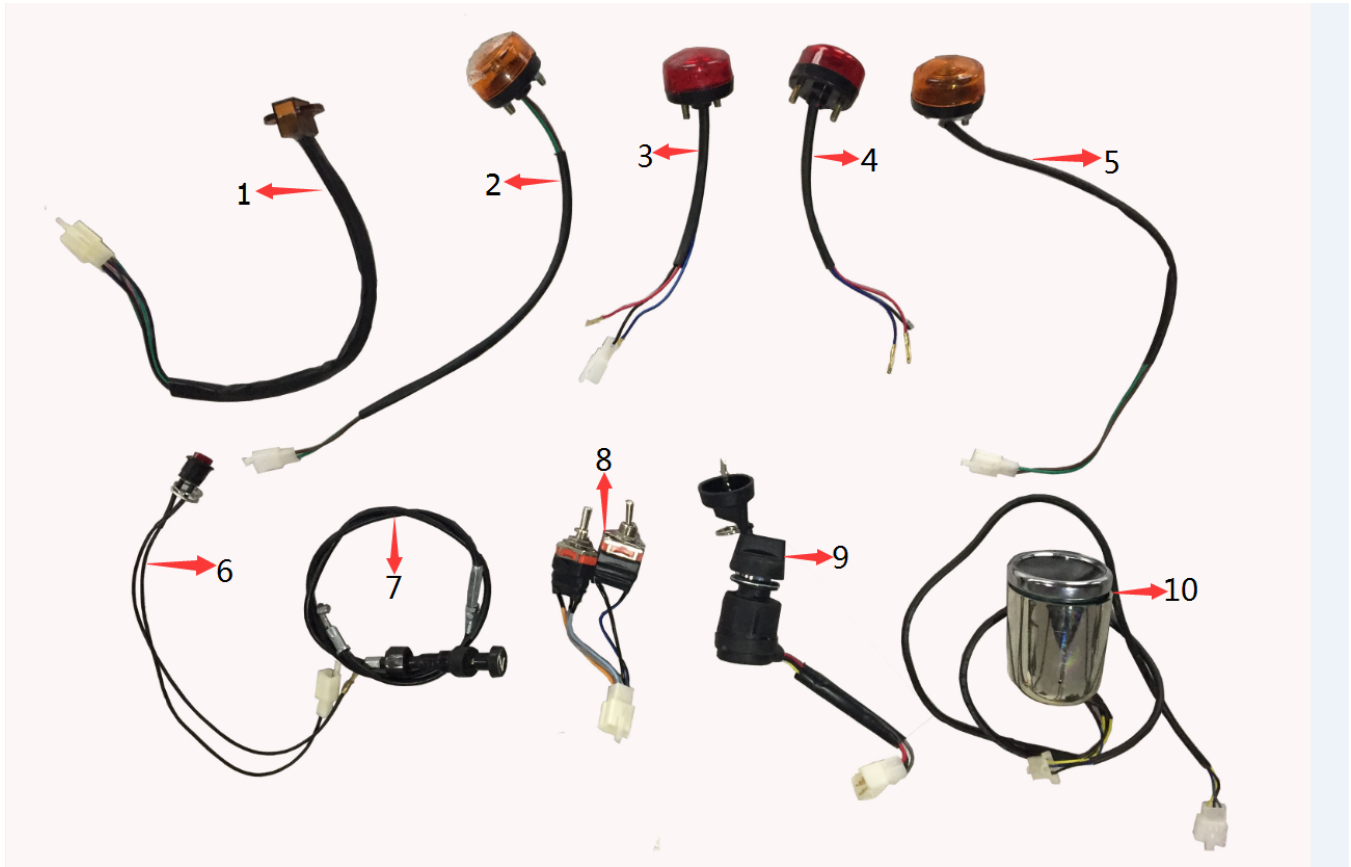

NO.	Part Number	Description	QTY
1	PAZ125-1-F-1	Gear indicator	1
2	PAZ125-1-F-2	Rear left turn lamp	1
3	PAZ125-1-F-3	Left brake lamp	1
4	PAZ125-1-F-4	Right brake lamp	1
5	PAZ125-1-F-5	Rear right turn lamp	1
6	PAZ125-1-F-6	Horn switch	1
7	PAZ125-1-F-7	Air throttle switch	1
8	PAZ125-1-F-8	Headlamp and turn lamp Switch	1
9	PAZ125-1-F-9	Ignition Lock	1
10	PAZ125-1-F-10	Speedometer	1

## SECTION G Windshield

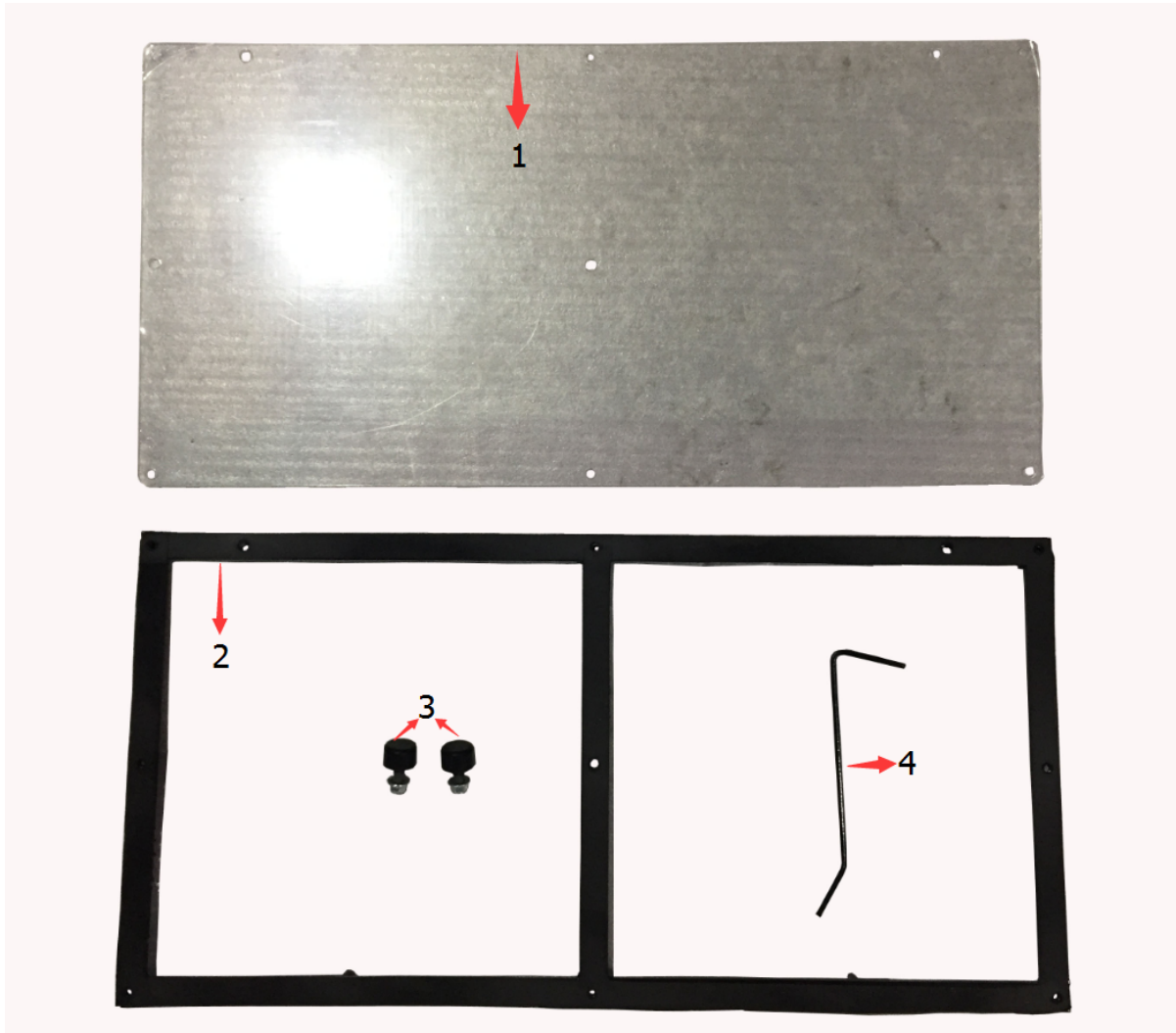

NO.	Part Number	Description	QTY
1	PAZ125-1-G-1	Windshield	1
2	PAZ125-1-G-2	Windshield Holder	
3	PAZ125-1-G-3	Fixing bolt	2
4	PAZ125-1-G-4	Windshield bracket	1

## SECTION H Handrail

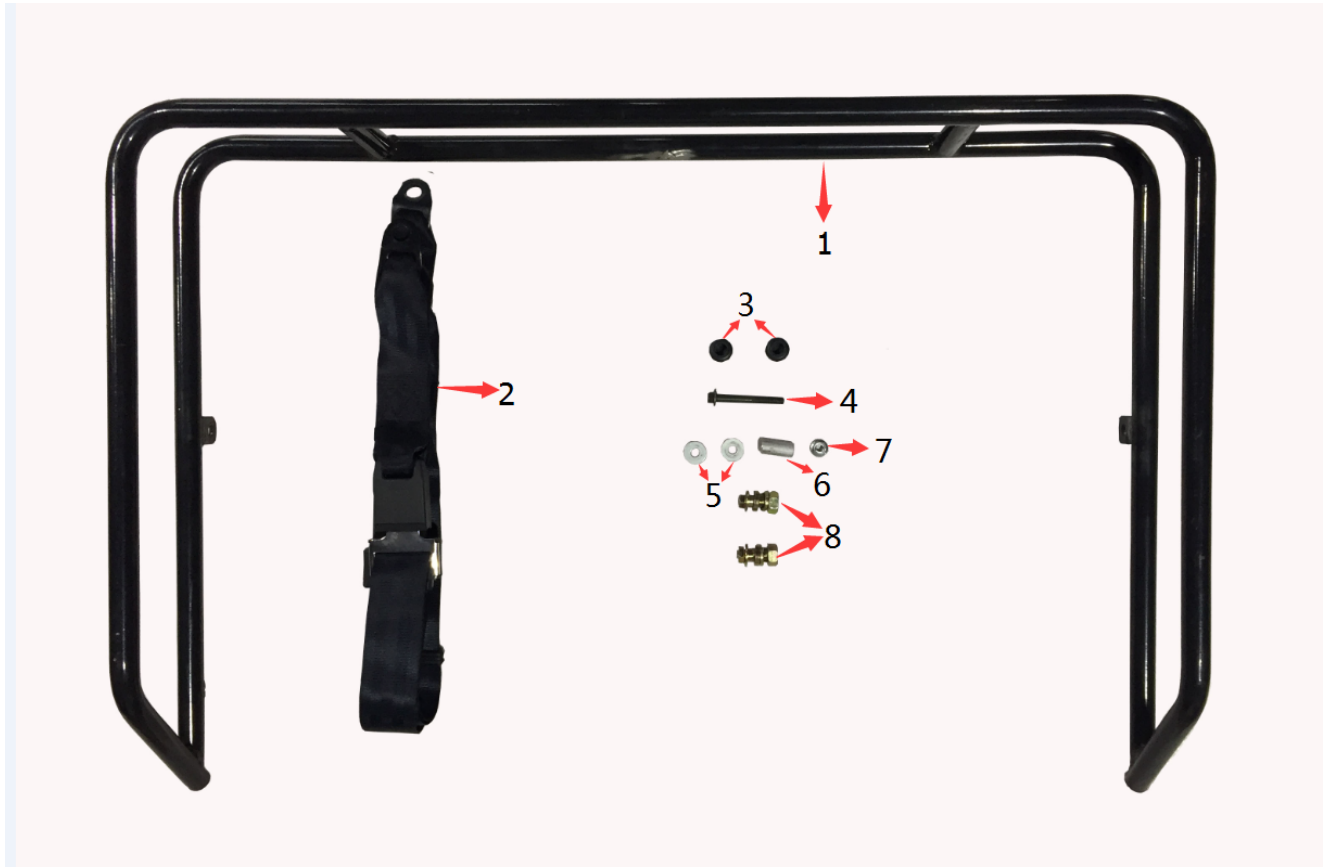

NO.	Part Number	Description	QTY
1	PAZ125-1-H-1	Handrail	1
2	PAZ125-1-H-2	Safety belt	1
3	PAZ125-1-H-3	Rubber ring	2
4	PAZ125-1-H-4	Bolt	1
5	PAZ125-1-H-5	Shim	2
6	PAZ125-1-H-6	bushing	1
7	PAZ125-1-H-7	Nut	1
8	PAZ125-1-H-8	Installation bolt	2

## SECTION I Footboard

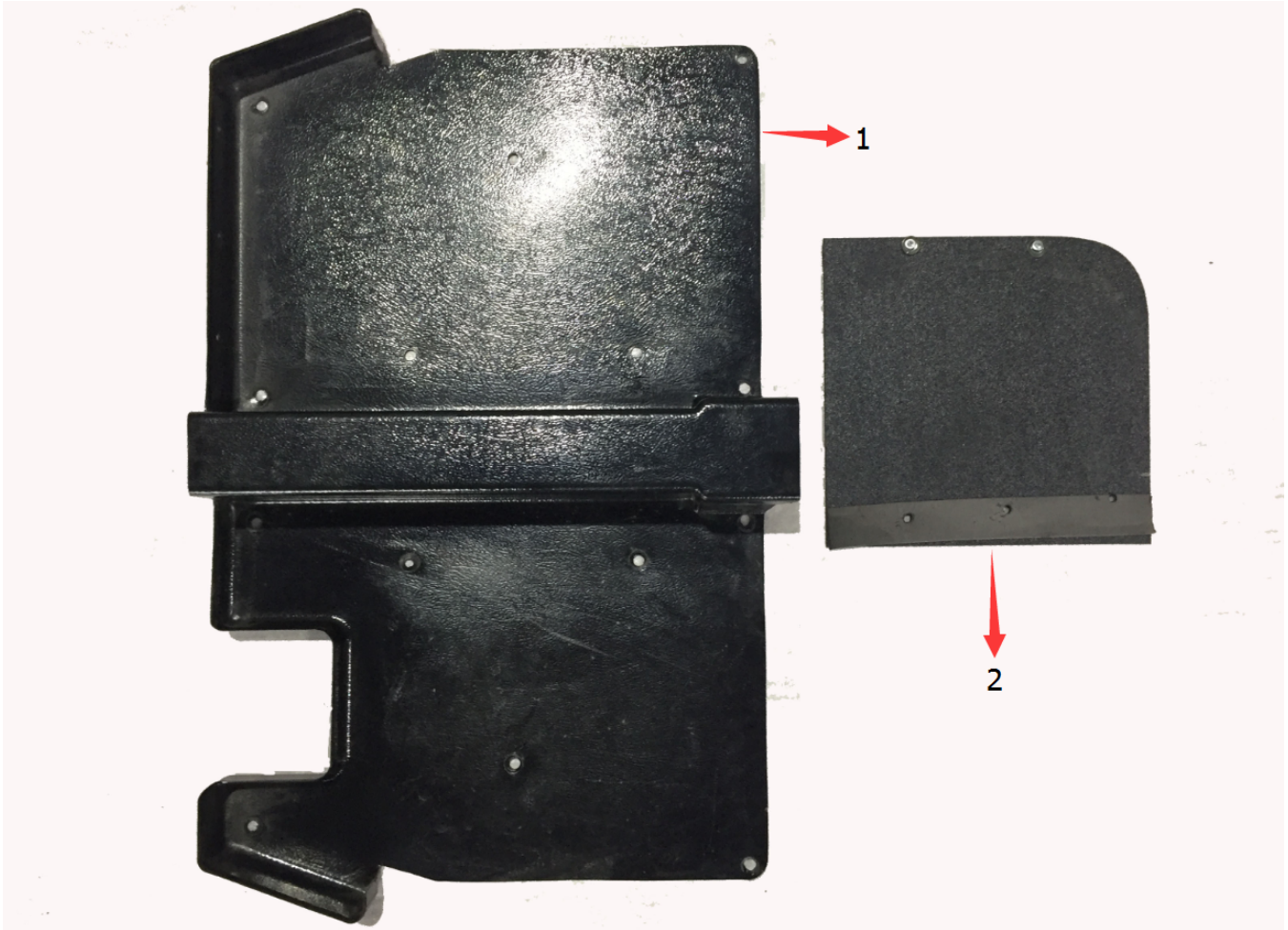

NO.	Part Number	Description	QTY
1	PAZ125-1-I-1	Footboard	1
2	PAZ125-1-I-2	Cover board	1

## SECTION J Steering Column



NO.	Part Number	Description	QTY
1	PAZ125-1-J-1	Steering wheel	1
2	PAZ125-1-J-2	Post cover	1
3	PAZ125-1-J-3	Gimbal	1
4	PAZ125-1-J-4	Upper part of the direction column	1
5	PAZ125-1-J-5	Lower part of the direction column	1
6	PAZ125-1-J-6	Bolt	4
7	PAZ125-1-J-7	Bolt	3
8	PAZ125-1-J-8	Self locking nut	4
9	PAZ125-1-J-9	Bolt	2
10	PAZ125-1-J-10	nut	1
11	PAZ125-1-J-11	Bearing	2

## SECTION K Spare Tire & Fuel Tank Mount

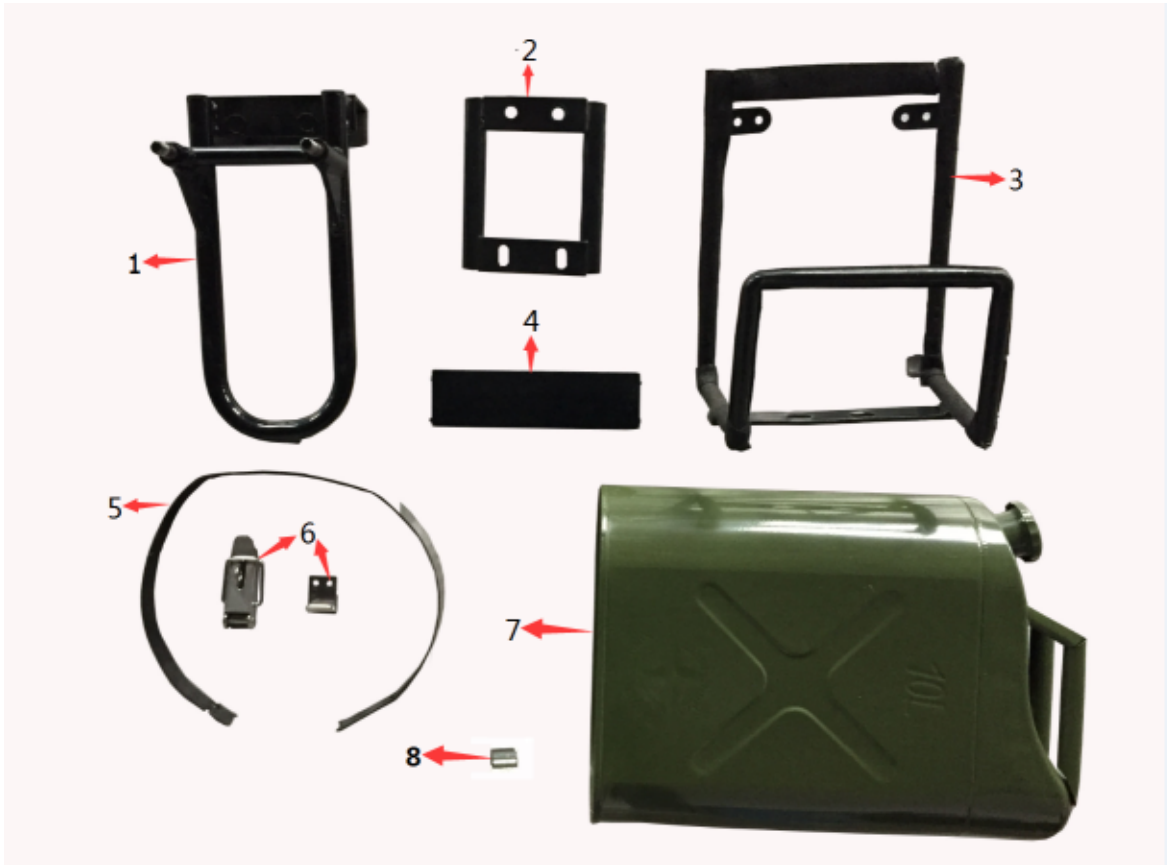

NO.	Part Number	Description	QTY
1	PAZ125-1-K-1	Spare wheel bracket	1
2	PAZ125-1-K-2	Spare fuel tank support	1
3	PAZ125-1-K-3	Spare fuel tank holder	1
4	PAZ125-1-K-4	Spare fuel tank support	1
5	PAZ125-1-K-5	Hoop for auxiliary tank	1
6	PAZ125-1-K-6	Agraffe	2
7	PAZ125-1-K-7	Spare fuel tank	1
8	PAZ125-1-K-8	Bushing	1

## SECTION L Front Swing Arm & Front Shock

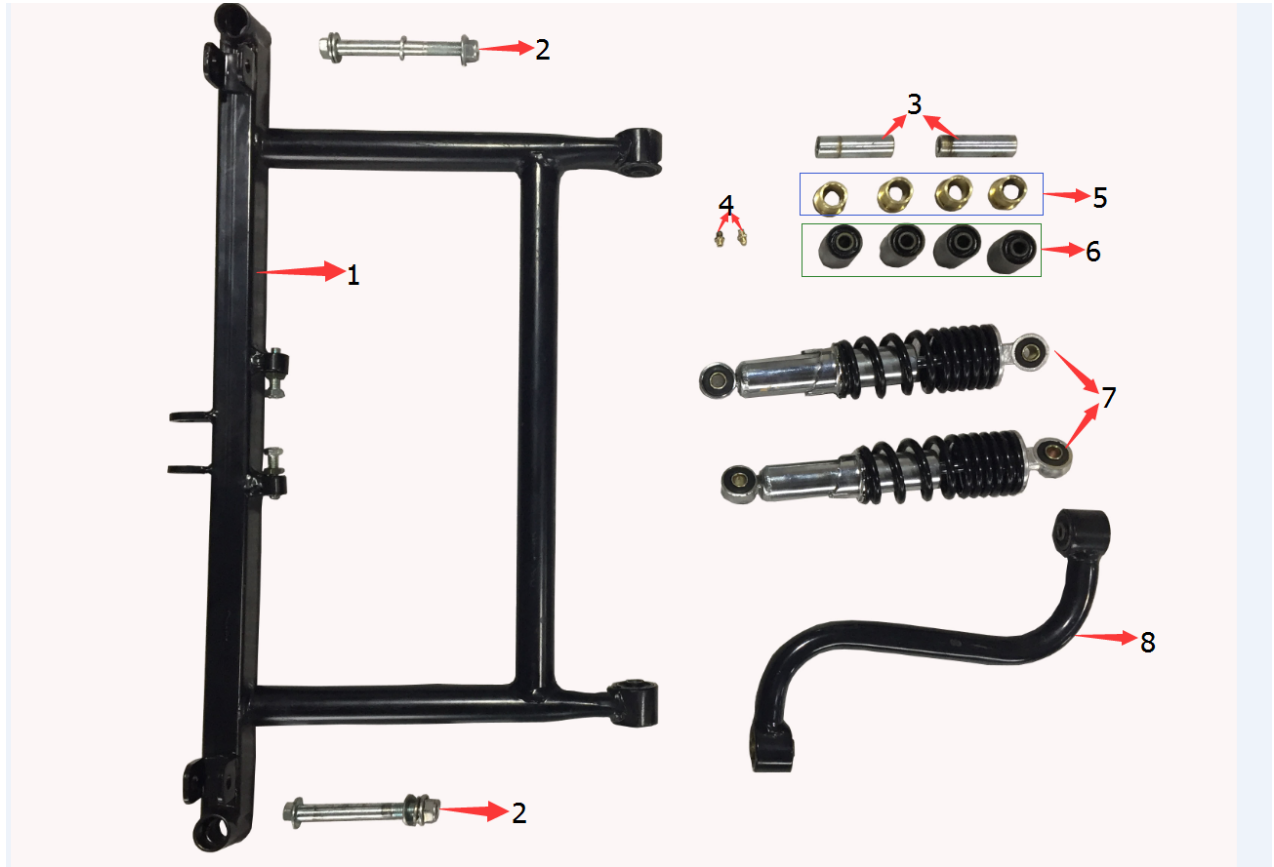

NO.	Part Number	Description	QTY
1	PAZ125-1-L-1	Front swing arm	1
2	PAZ125-1-L-2	Axle	2
3	PAZ125-1-L-3	Bushing	2
4	PAZ125-1-L-4	Spray nozzle	2
5	PAZ125-1-L-5	Copper sleeve	4
6	PAZ125-1-L-6	Bushing for front fork	4
7	PAZ125-1-L-7	Front shock	2
8	PAZ125-1-L-8	S Bracket	1

## SECTION M Rear Swing Arm & Rear Shock

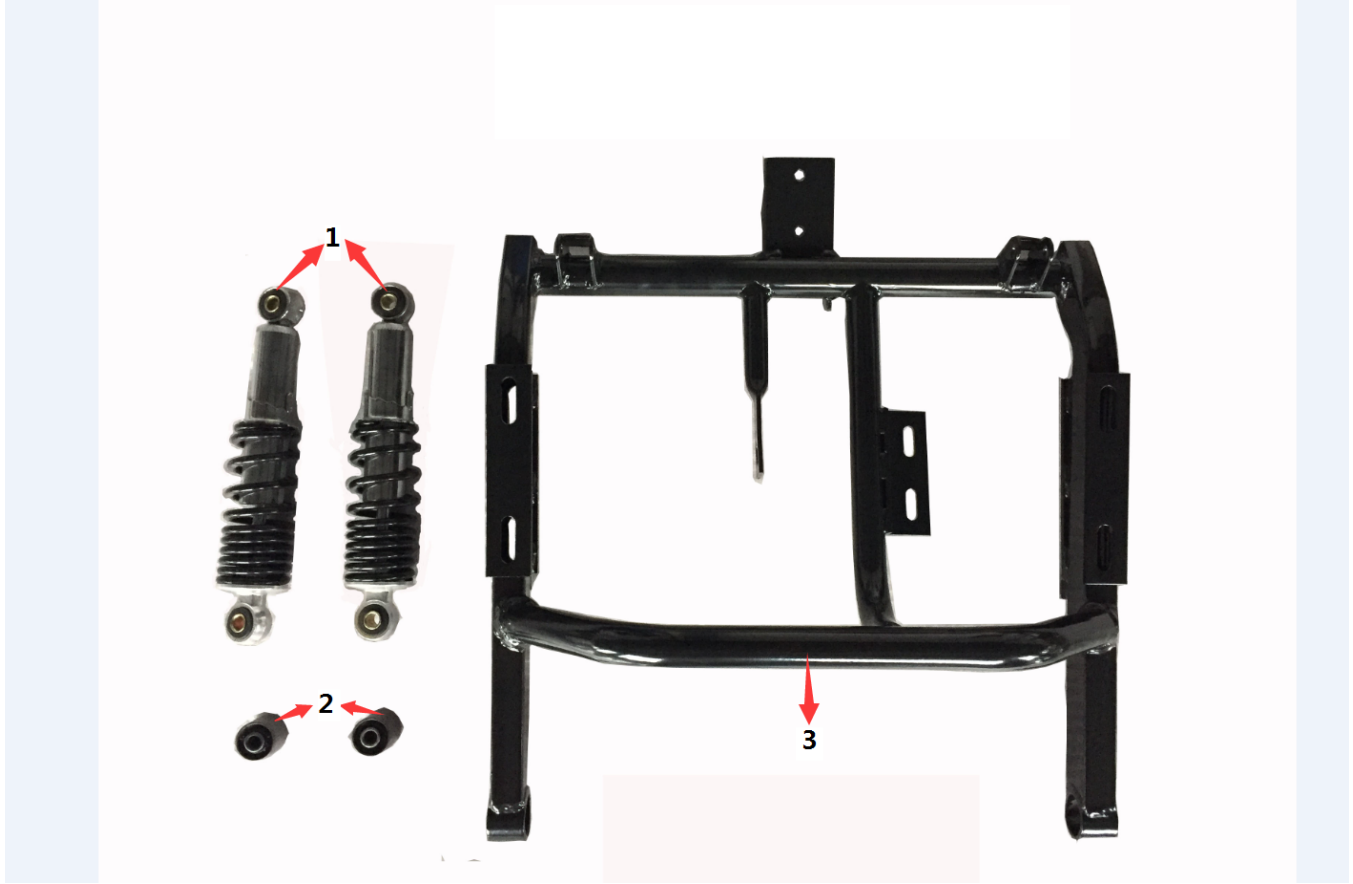

NO.	Part Number	Description	QTY
1	PAZ125-1-M-1	Rear shock	2
2	PAZ125-1-M-2	Bushing for rear fork	2
3	PAZ125-1-M-3	Rear swing arm	1

## SECTION N Headlight & Mirrors



NO.	Part Number	Description	QTY
1	PAZ125-1-N-1	Review mirror	2
2	PAZ125-1-N-2	Head light holder	2
3	PAZ125-1-N-3	Head light	2
4	PAZ125-1-N-4	Mirror bracket	2
5	PAZ125-1-N-5	Head light support	2
6	PAZ125-1-N-6	Front cover support	1

## SECTION O Electrical Components

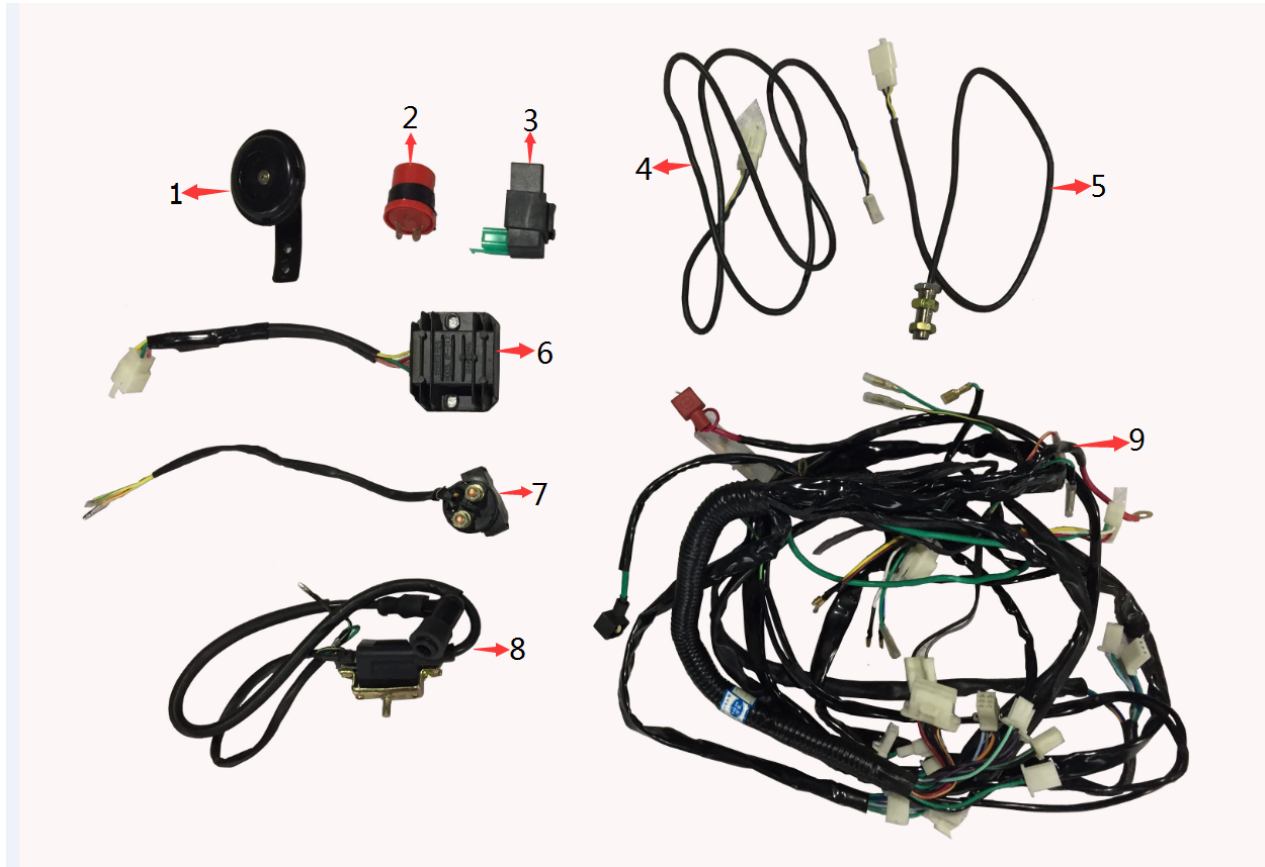

NO.	Part Number	Description	QTY
1	PAZ125-1-O-1	Horn	1
2	PAZ125-1-O-2	Relay winker	1
3	PAZ125-1-O-3	CDI	1
4	PAZ125-1-O-4	Connecting line	1
5	PAZ125-1-O-5	Sensor	1
6	PAZ125-1-O-6	Rectifier	1
7	PAZ125-1-O-7	Start relay	1
8	PAZ125-1-O-8	Ignition coil	1
9	PAZ125-1-O-9	Main wire harness	1

## SECTION P Chain & Tensioner



NO.	Part Number	Description	QTY
1	PAZ125-1-P-1	chain	1
2	PAZ125-1-P-2	Bushing	1
3	PAZ125-1-P-3	Nut	1
4	PAZ125-1-P-4	Axle	1
5	PAZ125-1-P-5	Installation spring for chain	2
6	PAZ125-1-P-6	Nut	2
7	PAZ125-1-P-7	Axle	2
8	PAZ125-1-P-8	Circlip	2

NO.	Part Number	Description	QTY
9	PAZ125-1-P-9	Bearing	4
10	PAZ125-1-P-10	Bushing	1
11	PAZ125-1-P-11	Bushing	1
12	PAZ125-1-P-12	Bushing	1
13	PAZ125-1-P-13	Bushing	1
14	PAZ125-1-P-14	Tensioning wheel	2
15	PAZ125-1-P-15	Mounting plate for Tensioning wheel	4

## SECTION Q Steering Linkage

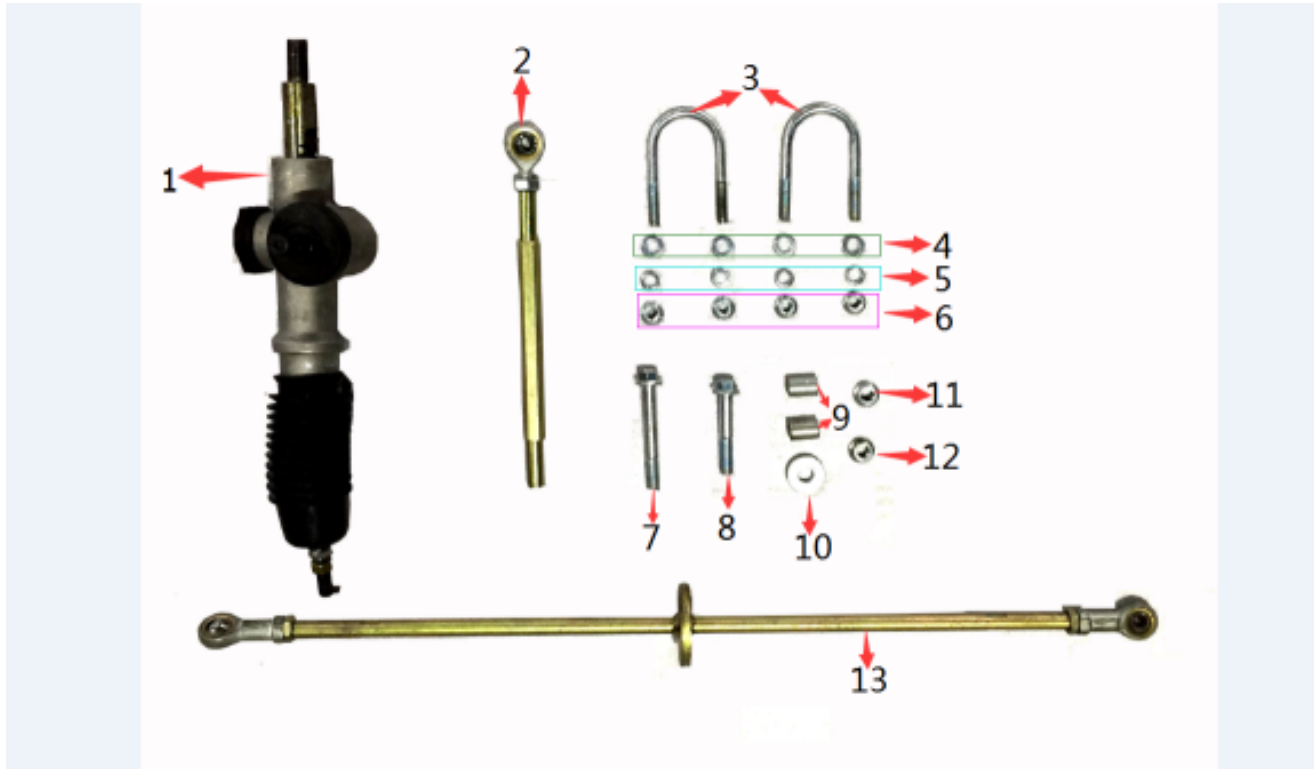

NO.	Part Number	Description	QTY
1	PAZ125-1-Q-1	Redirektor	1
2	PAZ125-1-Q-2	Steering lever	1
3	PAZ125-1-Q-3	U type stents	2
4	PAZ125-1-Q-4	Shim	4
5	PAZ125-1-Q-5	Spring pad	4
6	PAZ125-1-Q-6	Self locking nut	4
7	PAZ125-1-Q-7	Bolt	1
8	PAZ125-1-Q-8	Bolt	1
9	PAZ125-1-Q-9	Bushing	2
10	PAZ125-1-Q-10	Bushing	1
11	PAZ125-1-Q-11	Self locking nut	1
12	PAZ125-1-Q-12	Self locking nut	1
13	PAZ125-1-Q-13	Straining beam	1



## SECTION S Engine & Exhaust

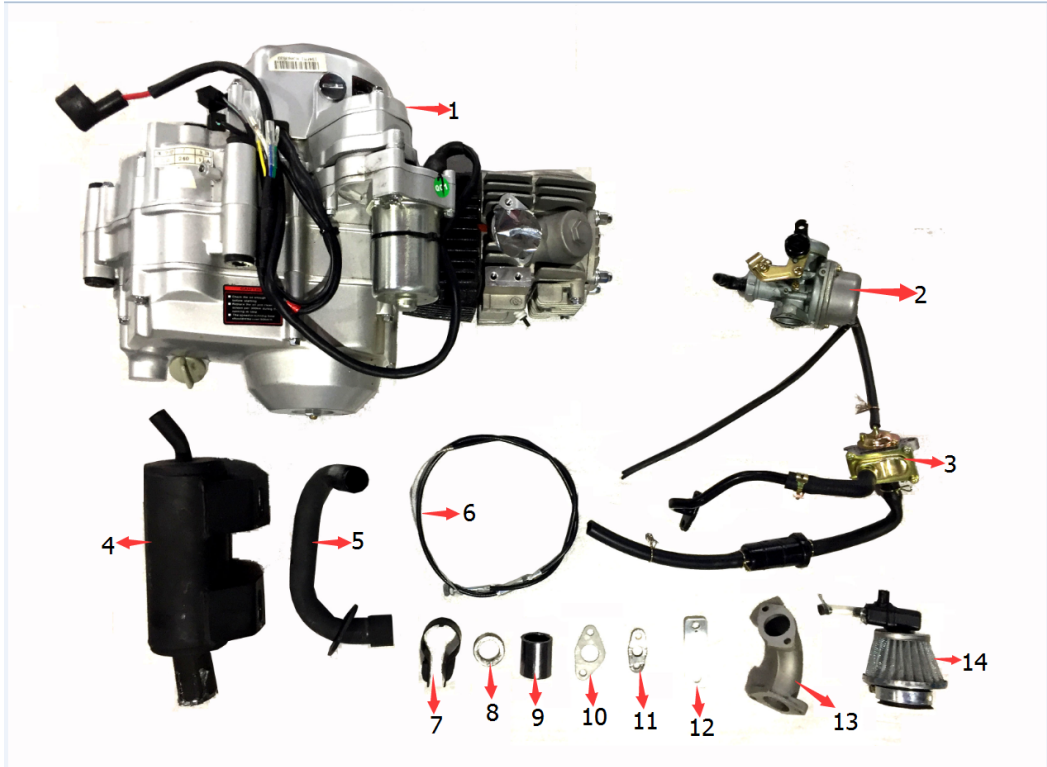

NO.	Part Number	Description	QTY
1	PAZ125-1-S-1	Engine 125CC	1
2	PAZ125-1-S-2	Carburetor	1
3	PAZ125-1-S-3	Secondary reflation	1
4	PAZ125-1-S-4	Muffler	1
5	PAZ125-1-S-5	Elbow	1
6	PAZ125-1-S-6	Cable assy throttle	10
7	PAZ125-1-S-7	Hoop	1
8	PAZ125-1-S-8	Washer for elbow	1
9	PAZ125-1-S-9	Bushing	1
10	PAZ125-1-S-10	Paper pad	1
11	PAZ125-1-S-11	Secondary valve paper pad	1
12	PAZ125-1-S-12	Connection bracket	1
13	PAZ125-1-S-13	Inlet pipe	1
14	PAZ125-1-S-14	Air filter	1

## SECTION T Gear Changer & Pedals

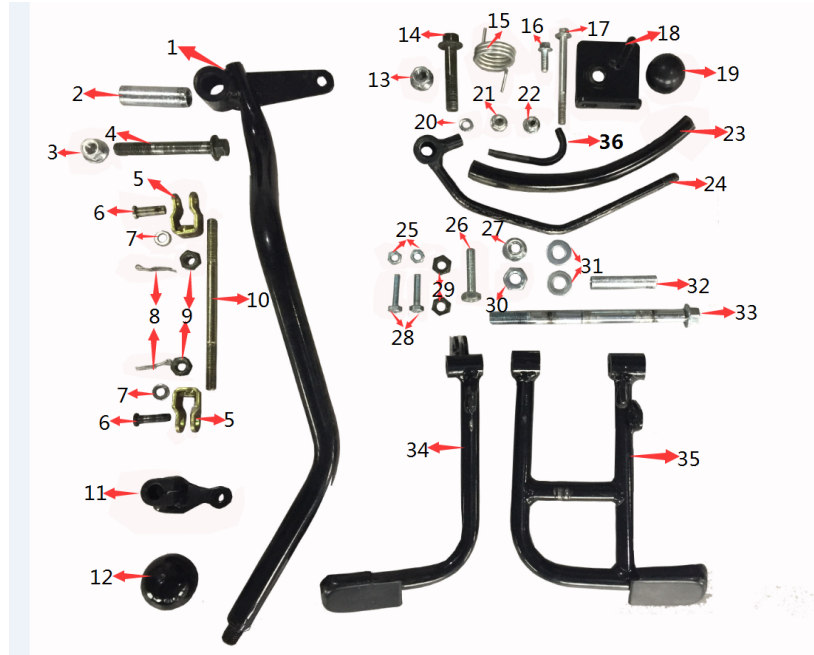

NO.	Part Number	Description	QTY
1	PAZ125-1-T-1	Gear changer	1
2	PAZ125-1-T-2	Bushing	1
3	PAZ125-1-T-3	Self locking nut	1
4	PAZ125-1-T-4	Bearing	1
5	PAZ125-1-T-5	Card head	1
6	PAZ125-1-T-6	Dowel	1
7	PAZ125-1-T-7	Shim	1
8	PAZ125-1-T-8	COTTER PIN	2
9	PAZ125-1-T-9	Nut	2
10	PAZ125-1-T-10	Lever rod	1
11	PAZ125-1-T-11	Gear changer connecting plate	1
12	PAZ125-1-T-12	ball head for Gear changer	1
13	PAZ125-1-T-13	Self locking nut	1
14	PAZ125-1-T-14	Bolt	1
15	PAZ125-1-T-15	torsional spring for parking brake	1
16	PAZ125-1-T-16	Bolt	1
17	PAZ125-1-T-17	Bolt	1
18	PAZ125-1-T-18	Mounting plate for parking brake	1

NO.	Part Number	Description	QTY
19	PAZ125-1-T-19	ball head	1
20	PAZ125-1-T-20	SPRING PAD	1
21	PAZ125-1-T-21	Nut	1
22	PAZ125-1-T-22	Nut	1
23	PAZ125-1-T-23	Leather hose	1
24	PAZ125-1-T-24	Parking brake	1
25	PAZ125-1-T-25	Nut	2
26	PAZ125-1-T-26	Bolt	1
27	PAZ125-1-T-27	Self locking nut	1
28	PAZ125-1-T-28	Bolt	2
29	PAZ125-1-T-29	Nut	2
30	PAZ125-1-T-30	Nut	1
31	PAZ125-1-T-31	Shim	2
32	PAZ125-1-T-32	Bushing	1
33	PAZ125-1-T-33	Bearing	1
34	PAZ125-1-T-34	Accelerator pedal	1
35	PAZ125-1-T-35	Pedal brake	1
36	PAZ125-1-T-36	Hook	1

## SECTION U Brake Linkage

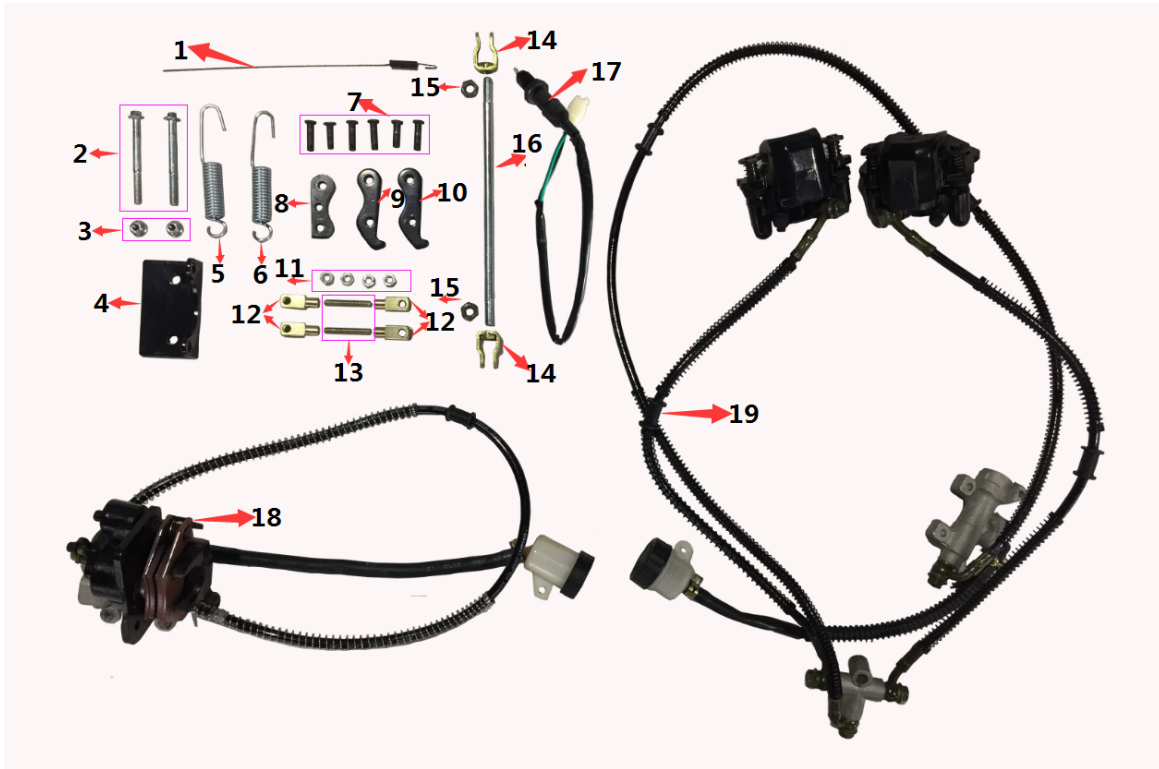

NO.	Part Number	Description	QTY
1	PAZ125-1-U-1	Spring	
2	PAZ125-1-U-2	Bolt	
3	PAZ125-1-U-3	Self locking nut	
4	PAZ125-1-U-4	Mounting plate for rear disc brake	
5	PAZ125-1-U-5	Spring	
6	PAZ125-1-U-6	Spring	
7	PAZ125-1-U-7	Dowel	
8	PAZ125-1-U-8	Comma slice 1	
9	PAZ125-1-U-9	Comma slice 2	
10	PAZ125-1-U-10	Comma slice 3	

NO.	Part Number	Description	QTY
11	PAZ125-1-U-11	Nut	
12	PAZ125-1-U-12	Card head	
13	PAZ125-1-U-13	Brake connecting link	
14	PAZ125-1-U-14	Card head big	
15	PAZ125-1-U-15	Nut	
16	PAZ125-1-U-16	Brake connecting rod	
17	PAZ125-1-U-17	Rear brake switch	
18	PAZ125-1-U-18	Rear disc brake	
19	PAZ125-1-U-19	Front disc brake	

## SECTION V Battery



NO.	Part Number	Description	QTY
1	PAZ125-1-V-1	Electrolyte	1
2	PAZ125-1-V-2	BATTERY	1
3	PAZ125-1-V-3	Nut	2
4	PAZ125-1-V-4	Bolt	2
5	PAZ125-1-V-5	BAND BATTERY	1

## SECTION W Tires & Rims



NO.	Part Number	Description	QTY
1	PAZ125-1-W-1	Tire	4
2	PAZ125-1-W-2	Rim	4

## SECTION X Fuel Tank



NO.	Part Number	Description	QTY
1	PAZ125-1-X-1	Fuel tank	1
2	PAZ125-1-X-2	Fuel tank cover	1
3	PAZ125-1-X-3	Oil pump	1
4	PAZ125-1-X-4	Fuel tank switch	1
5	PAZ125-1-X-5	Three through	2
6	PAZ125-1-X-6	Nut	4
7	PAZ125-1-X-7	Shim	4
8	PAZ125-1-X-8	Bolt	4

NO.	Part Number	Description	QTY
9	PAZ125-1-X-9	Nut	2
10	PAZ125-1-X-10	Bolt	2
11	PAZ125-1-X-11	Washer	1
12	PAZ125-1-X-12	oil pipe 1	1
13	PAZ125-1-X-13	oil pipe 2	1
14	PAZ125-1-X-14	oil pipe 3	1
	PAZ125-1-X-15	STATOR	