

PMZ150-17 150CC

Figure A: frame(图A:车架)



Part No.	Description	Qty per Vehicel
PMZ150-17-A-1	Frame	1

Figure B: filter,rear brake cable,etc(图B:空滤、后刹车线等)



Part No.	Description	Qty per Vehicel
PMZ150-17-B-1	Filter	1
PMZ150-17-B-2	Rear brake cable	1
PMZ150-17-B-3	Throttle Cable	1
PMZ150-17-B-4	Rear rim 12*2.5	1
PMZ150-17-B-5	Rear wheel 120-70-12	1
PMZ150-17-B-6	Carburetor	1
PMZ150-17-B-7	Engine	1
PMZ150-17-B-8	Set Square	1
PMZ150-17-B-9	Tabacco Pipe	1
PMZ150-17-B-10	Muffler Washer	1
PMZ150-17-B-11	Muffler	1
PMZ150-17-B-12	Rear shock	2

Figure C:front wheel,front shock,etc(图C:前轮、前减震等)



Part No.	Description	Qty per Vehicel
PMZ150-17-C-1	Front hub	1
PMZ150-17-C-2	Front Wheel 120-70-12	1
PMZ150-17-C-3	Steel Bowl	1
PMZ150-17-C-4	Bottom allied board	1
PMZ150-17-C-5	Front brake assy.	1
PMZ150-17-C-6	Front shock	2
PMZ150-17-C-7	Mileage clamp	1
PMZ150-17-C-8	Front disc brake 12 inches	1
PMZ150-17-C-9	Front disc brake	1
PMZ150-17-C-10	Screw	3
PMZ150-17-C-11	Bushing	1
PMZ150-17-C-12	Tachometer	1
PMZ150-17-C-13	Front wheel bearing	1

Figure D:fender,rear lamp,etc(图D:挡泥板, 后尾灯等)



Part No.	Description	Qty per Vehicle
PMZ150-17-D-1	Turn lamp	2
PMZ150-17-D-2	Rear reflector plate	1
PMZ150-17-D-3	Edge reflector plate	2
PMZ150-17-D-4	Lower rear fender	1
PMZ150-17-D-5	Armrest lid	1

PMZ150-17-D-6	Upper rear fender	1
PMZ150-17-D-7	Rear lamp	1

Figure E: instrument, seat direction, etc (图E: 仪表、方向把座)



Part No.	Description	Qty per Vehicle
PMZ150-17-E-1	Mileage line	1
PMZ150-17-E-2	Buffer skin	2
PMZ150-17-E-3	Upper speedometer	1
PMZ150-17-E-4	Rearview mirror	2
PMZ150-17-E-5	Instrument	1
PMZ150-17-E-6	Instrument support	1
PMZ150-17-E-7	Seat direction	1
PMZ150-17-E-8	Front turn lamp	2
PMZ150-17-E-9	Front turn lamp support	2
PMZ150-17-E-10	Direction handle shield	1
PMZ150-17-E-11	Gum cover	2
PMZ150-17-E-12	Left switch	1
PMZ150-17-E-13	Right switch	1
PMZ150-17-E-14	Handlebar	1
PMZ150-17-E-15	Hand press	1
PMZ150-17-E-16	Under speedometer	1

Figure F: stand, hanger, etc (图F: 中撑, 吊架等)



Part No.	Description	Qty per Vehicel
PMZ150-17-F-1	Rear lamp support	1
PMZ150-17-F-2	Kick stand	1
PMZ150-17-F-3	Front wall support	1
PMZ150-17-F-4	Rear shelves	1
PMZ150-17-F-5	Kick stand spring	1
PMZ150-17-F-6	Stand spring	1
PMZ150-17-F-7	Hanger buffer skin	2
PMZ150-17-F-8	Hanger	1
PMZ150-17-F-9	Stand	1

Figure G: front wall, headlight, etc (图G:前围, 前大灯等)



Part No.	Description	Qty per Vehicel
PMZ150-17-G-1	Front wall	1
PMZ150-17-G-2	Headlight card buckle	2
PMZ150-17-G-3	Headlight grid	1
PMZ150-17-G-4	Front signal lamp	1
PMZ150-17-G-5	Headlamp	1
PMZ150-17-G-6	Front panel-orange/black	1
	Front panel-matteblack	
	Front panel-matte green	

Figure: H: fuel tank, igniter, etc (图H: 油箱、点火器等)



Part No.	Description	Qty per Vehicel
PMZ150-17-H-1	Fuel tank	1
PMZ150-17-H-2	Cushion lock	1
PMZ150-17-H-3	Key set	1
PMZ150-17-H-4	Fuel level sensors	1
PMZ150-17-H-5	Filter	1
PMZ150-17-H-6	Fuel tank switch	1
PMZ150-17-H-7	Hose	2
PMZ150-17-H-8	Cushion guy	1
PMZ150-17-H-9	High-pressure pump	1
PMZ150-17-H-10	Fuel tank cover	1
PMZ150-17-H-11	Horn	1
PMZ150-17-H-12	Voltage stabilizer	1
PMZ150-17-H-13	Igniter	1
PMZ150-17-H-14	Relay	1
PMZ150-17-H-15	Flasher	1
PMZ150-17-H-16	Wire	1

Figure I: foot skin, battery cover, etc (图I: 脚踏皮、电瓶)



Part No.	Description	Qty per Vehicel
----------	-------------	-----------------

PMZ150-17-I-1	Foot skin	1
PMZ150-17-I-2	Inside cover of tool case	1
PMZ150-17-I-3	Pothook	1
PMZ150-17-I-4	Number cover	1
PMZ150-17-I-5	Pedal cover	4
PMZ150-17-I-6	Battery cover	1
PMZ150-17-I-7	Battery case	1
PMZ150-17-I-8	Tool kit	1

Figure J: fuel tank bottom, Glove box front cover, etc (图J)

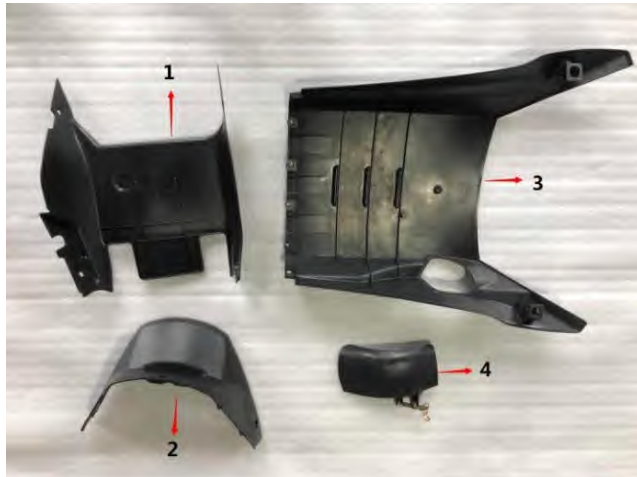

Part No.	Description	Qty per Vehicel
PMZ150-17-J-1	油箱底板	1
PMZ150-17-J-2	杂物箱前罩	1
PMZ150-17-J-3	车架底板	1
PMZ150-17-J-4	后轮挡泥板	1

Figure K: (decorative plate, front fender, etc) (图K: 左右)



Part No.	Description	Qty per Vehicel
PMZ150-17-K-1	Decorative plate-matte black	2
	Decorative plate-matte green	
	Decorative plate-orange/black	

PMZ150-17-K-2	Frame fender-matte black	1
	Frame fender-matte green	
	Frame fender-orange/black	
PMZ150-17-K-3	Front fender-matte black	1

Figure L: seat, glove box, etc (图L: 坐垫、杂物箱等)



Part No.	Description	Qty per Vehicle
PMZ150-17-L-1	坐垫	1
PMZ150-17-L-2	杂物箱	1
PMZ150-17-L-3	杂物箱小盖	1