

# PMZ150-22

## 五代压低祖玛150两轮

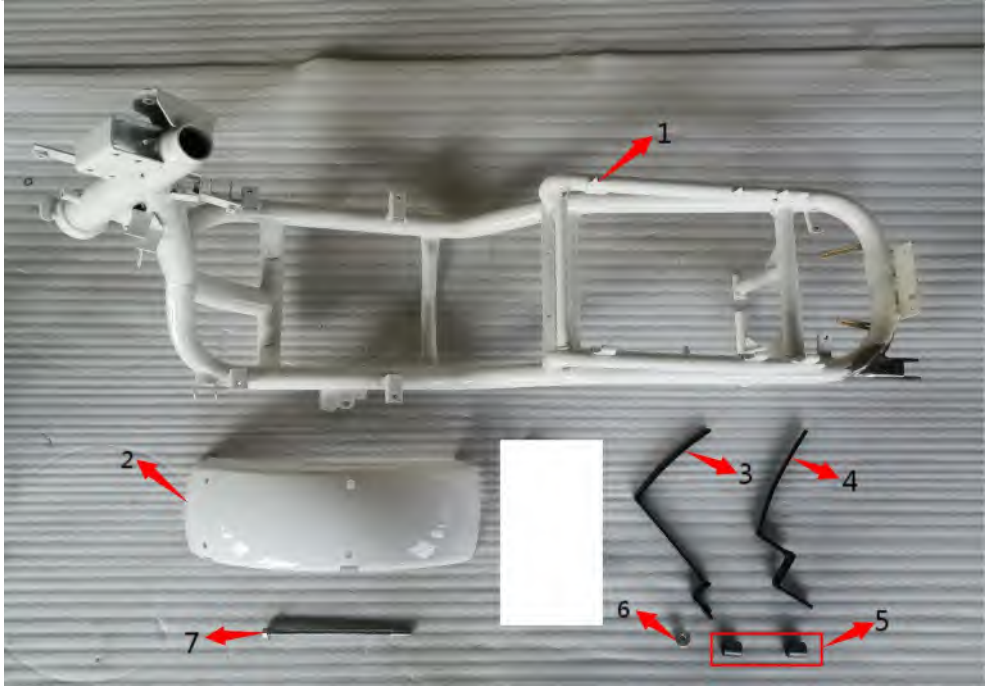

Parts No.	Description	Qty per Vehicel
PMZ150-22-A-1	Frame	1
PMZ150-22-A-2	Rear fender	1
PMZ150-22-A-3	Rear fender bracket, rear	1
PMZ150-22-A-4	Rear fender bracket, front	1
PMZ150-22-A-5	Hangger bushing	2
PMZ150-22-A-6	Step bushing	1
PMZ150-22-A-7	10*225 engine axle	1

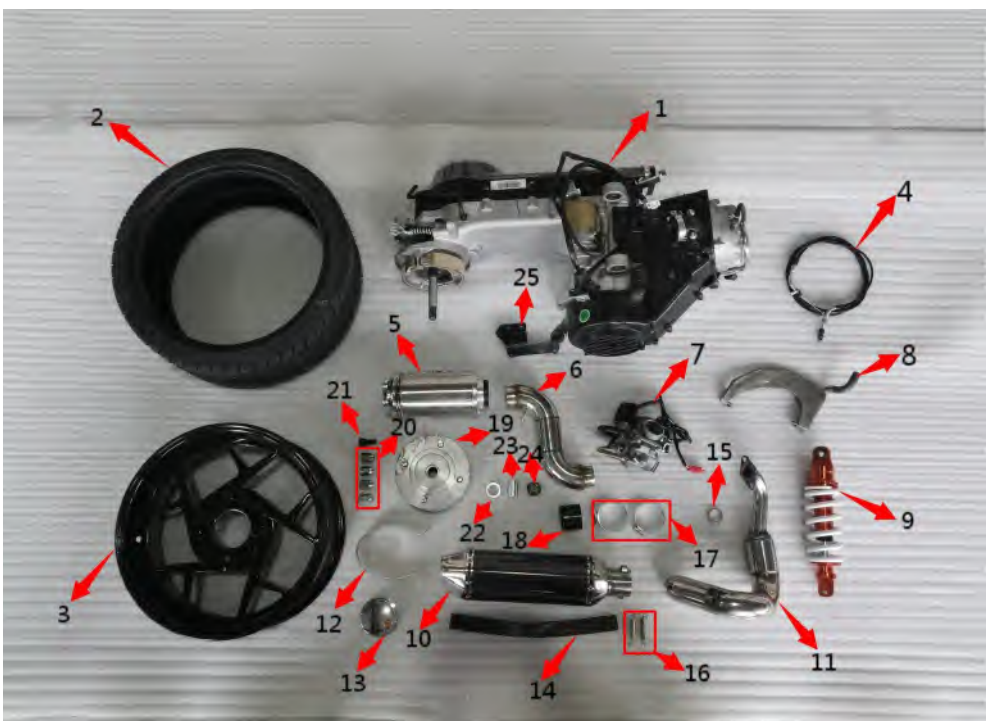

Parts No.	Description	Qty per Vehicle
PMZ150-22-B-1	Engine	1

PMZ150-22-B-2	Rear tire	1
PMZ150-22-B-3	Rear rim	1
PMZ150-22-B-4	Throttle cable	1
PMZ150-22-B-5	Air filter cartridge	1
PMZ150-22-B-6	Air filter bend	1
PMZ150-22-B-7	Carburetor	1
PMZ150-22-B-9	Rear Shock	1
PMZ150-22-B-10	Muffler	1
PMZ150-22-B-11	Exhaust	1
PMZ150-22-B-12	Muffler clip	1
PMZ150-22-B-13	Chrome decorative cover	1
PMZ150-22-B-14	Muffler clamp leather	1
PMZ150-22-B-15	Muffler washer	1
PMZ150-22-B-16	Muffler spring	2
PMZ150-22-B-17	Air filter clamp	2
PMZ150-22-B-18	Air filter rubber connecting	1
PMZ150-22-B-19	Rear wheel core	1
PMZ150-22-B-20	Nut	4
PMZ150-22-B-21	Tubeless valve	1
PMZ150-22-B-22	Rear wheel core bushing 1	1
PMZ150-22-B-23	Rear wheel core bushing 2	1
PMZ150-22-B-24	M16 nut	1
PMZ150-22-B-25	Air filter bracket	1



Parts No.	Description	Qty per Vehicle
PMZ150-22-C-1	Main wire	1

PMZ150-22-C-2	Headlight	1
PMZ150-22-C-3	Wind leaf decorative cover	1
PMZ150-22-C-4	Front turn signal lamp	2
PMZ150-22-C-5	Rear light	1
PMZ150-22-C-6	Headlight bracket	1
PMZ150-22-C-7	License plate light	1
PMZ150-22-C-8	License plate bracket	1
PMZ150-22-C-9	Speedometer	1
PMZ150-22-C-10	Sensor	1
PMZ150-22-C-11	Ignition coil	1
PMZ150-22-C-12	Starter relay	1
PMZ150-22-C-13	Relay assy,tunsignal	1
PMZ150-22-C-14	Horn	1
PMZ150-22-C-15	Regulator	1
PMZ150-22-C-16	CDI	1
PMZ150-22-C-17	Turning light cover	2
PMZ150-22-C-18	Sensor bracket	1
PMZ150-22-C-19	Speedometer bracket	1
PMZ150-22-C-20	Special license plate bracket	1
PMZ150-22-C-21	Ornamental buckle	3

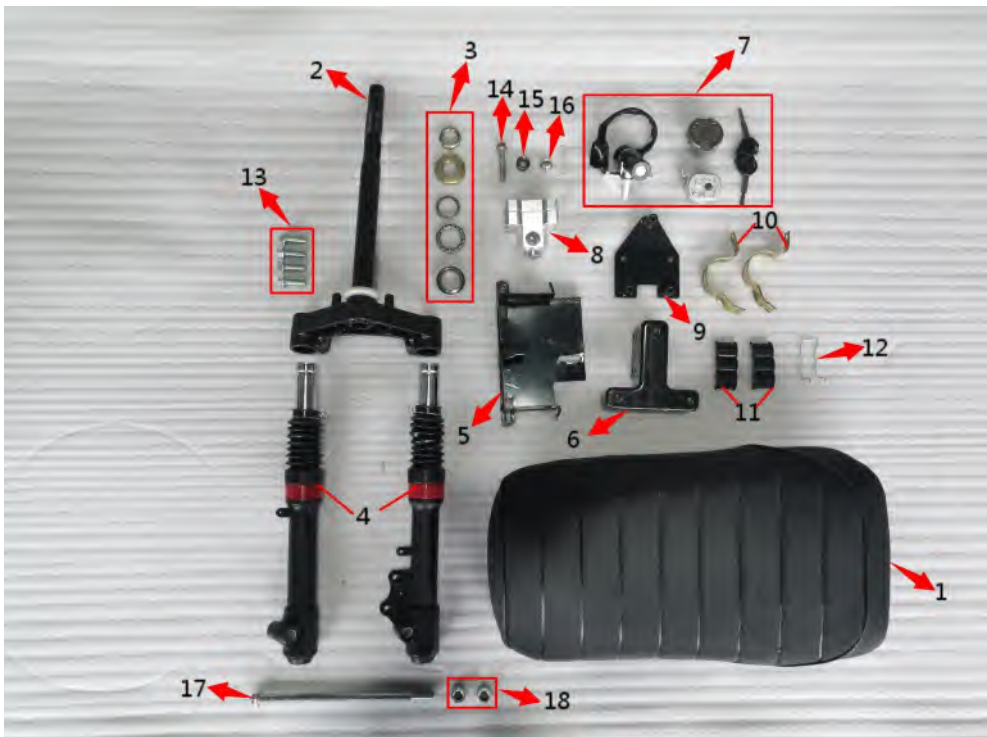

Parts No.	Description	Qty per Vehicle
PMZ150-22-D-1	Seat	1
PMZ150-22-D-2	Steering stem	1
PMZ150-22-D-3	Steel bowl	5
PMZ150-22-D-4	Front shock	2

PMZ150-22-D-5	Holder, battery	1
PMZ150-22-D-6	Front shield install frame	1
PMZ150-22-D-7	Key set	4
PMZ150-22-D-8	Handle guide	1
PMZ150-22-D-9	Front fender bracket	1
PMZ150-22-D-10	Seat attachment 1	2
PMZ150-22-D-11	Seat attachment 2	2
PMZ150-22-D-12	Seat attachment 3	1
PMZ150-22-D-13	10*30 screw bolt	4
PMZ150-22-D-14	10*55 screw bolt	1
PMZ150-22-D-15	Waist type bushing	1
PMZ150-22-D-16	M10 nut	1
PMZ150-22-D-17	Front axle	1
PMZ150-22-D-18	front axle bushing	2



Parts No.	Description	Qty per Vehicel
PMZ150-22-E-1	Latter guard shield	1
PMZ150-22-E-2	Rear shield	1
PMZ150-22-E-3	Front fender	1
PMZ150-22-E-4	Frame mud guard	1
PMZ150-22-E-5	Cover under seat	1
PMZ150-22-E-6	Fuel tank cover	1



Parts No.	Description	Qty per Vehicel
PMZ150-22-F-1	Fuel tank	1
PMZ150-22-F-2	Rear mirror LH	1
PMZ150-22-F-3	Rear mirror RH	1
PMZ150-22-F-4	Lfet hand grip	1
PMZ150-22-F-5	Throttle grip	1
PMZ150-22-F-6	Left control panel	1
PMZ150-22-F-7	Right control panel	1
PMZ150-22-F-8	Handlebar	1
PMZ150-22-F-9	Rear brake cable	1
PMZ150-22-F-10	Front footpeg	2
PMZ150-22-F-11	Front footpeg spring	2
PMZ150-22-F-12	Front footpeg pin	2
PMZ150-22-F-13	Kick stand	1
PMZ150-22-F-14	Kick stand bolt	1
PMZ150-22-F-15	Kick stand spring	1
PMZ150-22-F-16	Gas sensor	1
PMZ150-22-F-17	Oil pump	1
PMZ150-22-F-18	Balance bar bracket	1
PMZ150-22-F-19	Fixed ring	1
PMZ150-22-F-20	Oil seal	1
PMZ150-22-F-21	Oil tubing	3



Parts No.	Description	Qty per Vehicle
PMZ150-22-G-1	Front tire	1
PMZ150-22-G-2	Front rim	1
PMZ150-22-G-3	Front brake	1
PMZ150-22-G-4	Front brake disc	1
PMZ150-22-G-5	Battery	1
PMZ150-22-G-6	Front brake disc screw bolt	3
PMZ150-22-G-7	8*45 screw bolt	2
PMZ150-22-G-8	16*12*8.5 bushing	2
PMZ150-22-G-9	Tubeless valve	1
PMZ150-22-G-10	Battery attachment	4