

# PMZ50-22

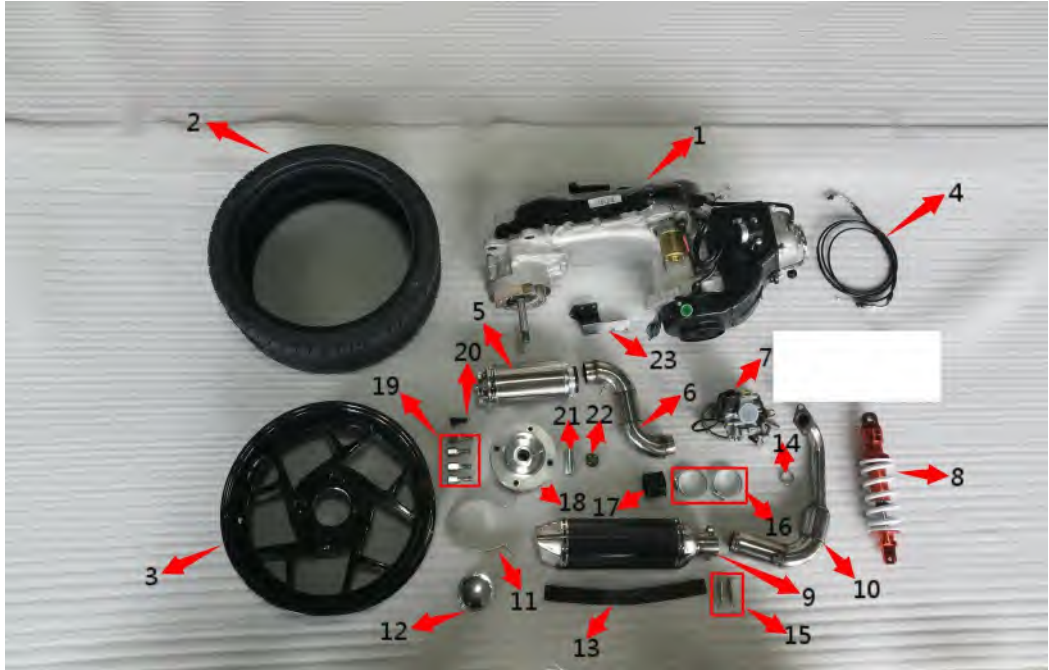

| Parts No.    | Description                | Qty per Vehicle |
|--------------|----------------------------|-----------------|
| PMZ50-22-A-1 | Frame                      | 1               |
| PMZ50-22-A-2 | Rear fender                | 1               |
| PMZ50-22-A-3 | Hanger                     | 1               |
| PMZ50-22-A-4 | Muffler bracket            | 1               |
| PMZ50-22-A-5 | Rear fender bracket, rear  | 1               |
| PMZ50-22-A-6 | Rear fender bracket, front | 1               |
| PMZ50-22-A-7 | Hanger bushing             | 2               |
| PMZ50-22-A-8 | Step bushing               | 1               |
| PMZ50-22-A-9 | Hanger shaft 8*172         | 1               |

|               |                     |   |
|---------------|---------------------|---|
| PMZ50-22-A-10 | Hanger shaft 10*215 | 1 |
|---------------|---------------------|---|



| Parts No.     | Description             | Qty per Vehicle |
|---------------|-------------------------|-----------------|
| PMZ50-22-B-1  | Engine                  | 1               |
| PMZ50-22-B-2  | Rear tire               | 1               |
| PMZ50-22-B-3  | Rear rim                | 1               |
| PMZ50-22-B-4  | Throttle cable          | 1               |
| PMZ50-22-B-5  | Air filter cartridge    | 1               |
| PMZ50-22-B-6  | Air filter bend         | 1               |
| PMZ50-22-B-7  | Carburetor              | 1               |
| PMZ50-22-B-8  | Rear Shock              | 1               |
| PMZ50-22-B-9  | Muffler                 | 1               |
| PMZ50-22-B-10 | Exhaust                 | 1               |
| PMZ50-22-B-11 | Muffler clip            | 1               |
| PMZ50-22-B-12 | Chrome decorative cover | 1               |
| PMZ50-22-B-13 | Muffler clamp leather   | 1               |
| PMZ50-22-B-14 | Muffler washer          | 1               |
| PMZ50-22-B-15 | Muffler spring          | 1               |
| PMZ50-22-B-16 | Air filter clamp        | 2               |

|               |                                 |   |
|---------------|---------------------------------|---|
| PMZ50-22-B-17 | Air filter rubber connecting    | 2 |
| PMZ50-22-B-18 | Rear wheel core                 | 1 |
| PMZ50-22-B-19 | Nut                             | 4 |
| PMZ50-22-B-20 | Tubeless valve                  | 1 |
| PMZ50-22-B-21 | Rear wheel core supporting tube | 1 |
| PMZ50-22-B-22 | M16 nut                         | 1 |
| PMZ50-22-B-23 | Air filter bracket              | 1 |



| Parts No.    | Description                | Qty per Vehicle |
|--------------|----------------------------|-----------------|
| PMZ50-22-C-1 | Main wire                  | 1               |
| PMZ50-22-C-2 | Headlight                  | 1               |
| PMZ50-22-C-3 | Wind leaf decorative cover | 1               |
| PMZ50-22-C-4 | Front turn signal lamp     | 2               |
| PMZ50-22-C-5 | Rear light                 | 1               |
| PMZ50-22-C-6 | Headlight bracket          | 1               |
| PMZ50-22-C-7 | License plate light        | 1               |
| PMZ50-22-C-8 | License plate bracket      | 1               |

|               |                               |   |
|---------------|-------------------------------|---|
| PMZ50-22-C-9  | Speedometer                   | 1 |
| PMZ50-22-C-10 | Sensor                        | 1 |
| PMZ50-22-C-11 | Ignition coil                 | 1 |
| PMZ50-22-C-12 | Starter relay                 | 1 |
| PMZ50-22-C-13 | Relay assy, tunsignal         | 1 |
| PMZ50-22-C-14 | Horn                          | 1 |
| PMZ50-22-C-15 | Regulator                     | 1 |
| PMZ50-22-C-16 | CDI                           | 1 |
| PMZ50-22-C-17 | Turning light cover           | 2 |
| PMZ50-22-C-18 | Sensor bracket                | 1 |
| PMZ50-22-C-19 | Speedometer bracket           | 1 |
| PMZ50-22-C-20 | Special license plate bracket | 1 |
| PMZ50-22-C-21 | Ornamental buckle             | 3 |

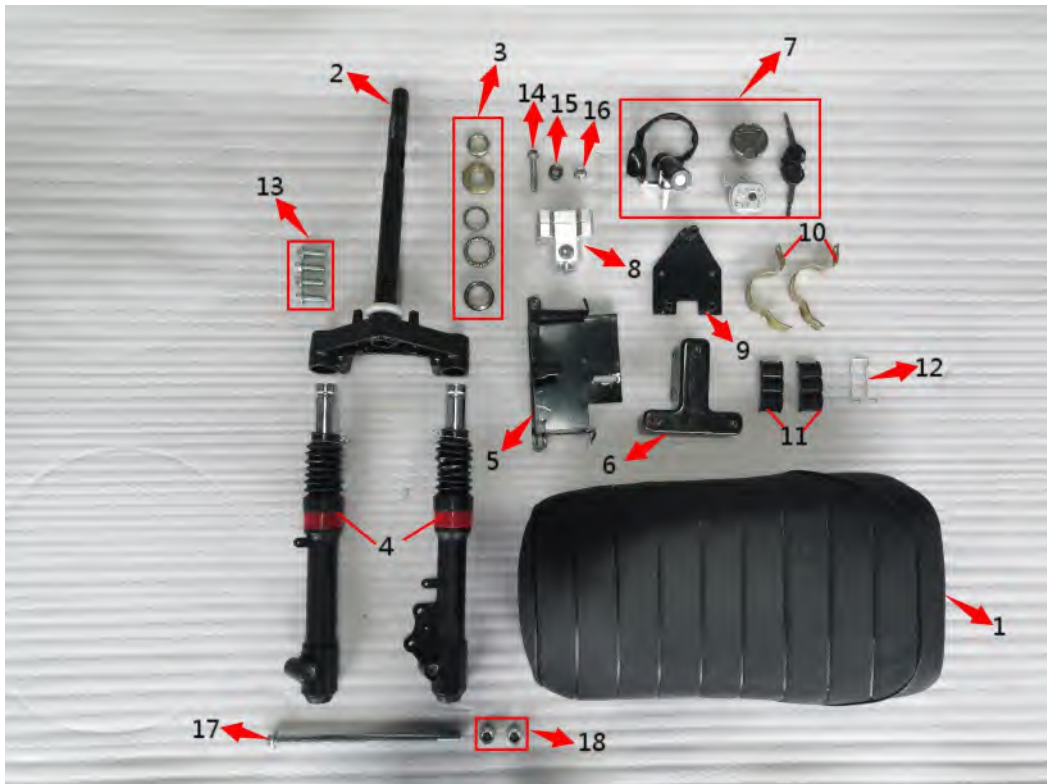

| Parts No.    | Description | Qty per Vehicle |
|--------------|-------------|-----------------|
| PMZ50-22-D-1 | Seat        | 1               |

|               |                            |   |
|---------------|----------------------------|---|
| PMZ50-22-D-2  | Steering stem              | 1 |
| PMZ50-22-D-3  | Steel bowl                 | 5 |
| PMZ50-22-D-4  | Front shock                | 2 |
| PMZ50-22-D-5  | Holder, battery            | 1 |
| PMZ50-22-D-6  | Front shield install frame | 1 |
| PMZ50-22-D-7  | Key set                    | 4 |
| PMZ50-22-D-8  | Handle guide               | 1 |
| PMZ50-22-D-9  | Front fender bracket       | 1 |
| PMZ50-22-D-10 | Seat attachment 1          | 2 |
| PMZ50-22-D-11 | Seat attachment 2          | 2 |
| PMZ50-22-D-12 | Seat attachment 3          | 1 |
| PMZ50-22-D-13 | 10*30 screw bolt           | 4 |
| PMZ50-22-D-14 | 10*55 screw bolt           | 1 |
| PMZ50-22-D-15 | Waist type bushing         | 1 |
| PMZ50-22-D-16 | M10 nut                    | 1 |
| PMZ50-22-D-17 | Front axle                 | 1 |
| PMZ50-22-D-18 | front axle bushing         | 2 |



| Parts No.    | Description         | Qty per Vehicel |
|--------------|---------------------|-----------------|
| PMZ50-22-E-1 | Latter guard shield | 1               |
| PMZ50-22-E-2 | Rear shield         | 1               |
| PMZ50-22-E-3 | Front fender        | 1               |
| PMZ50-22-E-4 | Frame mud guard     | 1               |
| PMZ50-22-E-5 | Cover under seat    | 1               |
| PMZ50-22-E-6 | Fuel tank cover     | 1               |



| Parts No.     | Description          | Qty per Vehicle |
|---------------|----------------------|-----------------|
| PMZ50-22-F-1  | Fuel tank            | 1               |
| PMZ50-22-F-2  | Rear mirror LH       | 1               |
| PMZ50-22-F-3  | Rear mirror RH       | 1               |
| PMZ50-22-F-4  | Lfet hand grip       | 1               |
| PMZ50-22-F-5  | Throttle grip        | 1               |
| PMZ50-22-F-6  | Left control panel   | 1               |
| PMZ50-22-F-7  | Right control panel  | 1               |
| PMZ50-22-F-8  | Handlebar            | 1               |
| PMZ50-22-F-9  | Rear brake cable     | 1               |
| PMZ50-22-F-10 | Front footpeg        | 2               |
| PMZ50-22-F-11 | Front footpeg spring | 2               |

|               |                     |   |
|---------------|---------------------|---|
| PMZ50-22-F-12 | Front footpeg pin   | 2 |
| PMZ50-22-F-13 | Kick stand          | 1 |
| PMZ50-22-F-14 | Kick stand bolt     | 1 |
| PMZ50-22-F-15 | Kick stand spring   | 1 |
| PMZ50-22-F-16 | Gas sensor          | 1 |
| PMZ50-22-F-17 | Oil pump            | 1 |
| PMZ50-22-F-18 | Balance bar bracket | 1 |
| PMZ50-22-F-19 | Fixed ring          | 1 |
| PMZ50-22-F-20 | Oil seal            | 1 |
| PMZ50-22-F-21 | Oil tubing          | 3 |



| Parts No.    | Description | Qty per Vehicle |
|--------------|-------------|-----------------|
| PMZ50-22-G-1 | Front tire  | 1               |
| PMZ50-22-G-2 | Front rim   | 1               |
| PMZ50-22-G-3 | Front brake | 1               |



|               |                             |   |
|---------------|-----------------------------|---|
| PMZ50-22-G-4  | Front brake disc            | 1 |
| PMZ50-22-G-5  | Battery                     | 1 |
| PMZ50-22-G-6  | Front brake disc screw bolt | 3 |
| PMZ50-22-G-7  | 8*45 screw bolt             | 2 |
| PMZ50-22-G-8  | 16*12*8.5 bushing           | 2 |
| PMZ50-22-G-9  | Tubeless valve              | 1 |
| PMZ50-22-G-10 | Battery attachment          | 4 |