



Part No.	Description	Qty per Vehicel
PST150-9Z-A-001	Front tire	1
PST150-9Z-A-002	Front rim	1
PST150-9Z-A-003	Front brake disc	1
PST150-9Z-A-004	Steering stem	1
PST150-9Z-A-005	Front Shock LH, RH	2
PST150-9Z-A-006	Front disc brake	1
PST150-9Z-A-007	Steel bowl	1
PST150-9Z-A-008	Mileage line clip	1
PST150-9Z-A-009	Front disc brake clip	1
PST150-9Z-A-010	Speed sensor	1
PST150-9Z-A-011	Front wheel bushing	1
PST150-9Z-A-012	Self lock screw	1
PST150-9Z-A-013	Front axle	1
PST150-9Z-A-014	Tubeless valve	1



Part No.	Description	Qty per Vehicel
PST150-9Z-B-001METALLIC BLACK	Left panel	1
PST150-9Z-B-001METALLIC WINE RED	Left panel	1
PST150-9Z-B-001METALLIC WHITE	Left panel	1
PST150-9Z-B-001METALLIC BLUE	Left panel	1
PST150-9Z-B-002METALLIC BLACK	Right panel	1
PST150-9Z-B-002METALLIC WINE RED	Right panel	1
PST150-9Z-B-002METALLIC WHITE	Right panel	1
PST150-9Z-B-002METALLIC BLUE	Right panel	1
PST150-9Z-B-003	Tail lamp	1
PST150-9Z-B-004	Rear fender	1
PST150-9Z-B-005METALLIC BLACK	Left panel decoration	1
PST150-9Z-B-005METALLIC WINE RED	Left panel decoration	1
PST150-9Z-B-005METALLIC WHITE	Left panel decoration	1
PST150-9Z-B-005METALLIC BLUE	Left panel decoration	1
PST150-9Z-B-006METALLIC BLACK	Right panel decoration	1
PST150-9Z-B-006METALLIC WINE RED	Right panel decoration	1
PST150-9Z-B-006METALLIC WHITE	Right panel decoration	1
PST150-9Z-B-006METALLIC BLUE	Right panel decoration	1
PST150-9Z-B-007METALLIC BLACK	Connecting, up	1
PST150-9Z-B-0077METALLIC WINE RED	Connecting, up	1

PST150-9Z-B-007METALLIC WHITE	Connecting, up	1
PST150-9Z-B-007METALLIC BLUE	Connecting, up	1
PST150-9Z-B-008	Rear wing	1
PST150-9Z-B-009	Rear reflector plate	1
PST150-9Z-B-010METALLIC BLACK	Rear tail wing	1
PST150-9Z-B-010METALLIC WINE RED	Rear tail wing	1
PST150-9Z-B-010METALLIC WHITE	Rear tail wing	1
PST150-9Z-B-010METALLIC BLUE	Rear tail wing	1
PST150-9Z-B-011	Headlight bracket	1



Part No.	Description	Qty per Vehicle
PST150-9Z-C-001METALLIC BLACK	Front wheel fender	1
PST150-9Z-C-001METALLIC WINE RED	Front wheel fender	1
PST150-9Z-C-001METALLIC WHITE	Front wheel fender	1
PST150-9Z-C-001METALLIC BLUE	Front wheel fender	1
PST150-9Z-C-002METALLIC BLACK	Left guard	1
PST150-9Z-C-002METALLIC WINE RED	Left guard	1
PST150-9Z-C-002METALLIC WHITE	Left guard	1
PST150-9Z-C-002METALLIC BLUE	Left guard	1
PST150-9Z-C-003METALLIC BLACK	Right guard	1
PST150-9Z-C-003METALLIC WINE RED	Right guard	1
PST150-9Z-C-003METALLIC WHITE	Right guard	1
PST150-9Z-C-003METALLIC BLUE	Right guard	1
PST150-9Z-C-004	Rear left bar	1
PST150-9Z-C-005	Rear right bar	1



Part No.	Description	Qty per Vehicle
PST150-9Z-D-001	Seat front wall	1
PST150-9Z-D-002	Front wall fender	1
PST150-9Z-D-003	Center cover	1
PST150-9Z-D-004	Battery cover	1
PST150-9Z-D-005	Charging port cover	1



Part No.	Description	Qty per Vehicle
PST150-9Z-E-001	Lower part of the toolbox	1
PST150-9Z-E-002	Upper part of the toolbox	1
PST150-9Z-E-003	Foot pedal	1
PST150-9Z-E-004	Cover, Chassis No.	1
PST150-9Z-E-005	Hook up	1
PST150-9Z-E-006	Foot pedal cover	4



Part No.	Description	Qty per Vehicle
PST150-9Z-F-001	Seat	1
PST150-9Z-F-002	Luggage	1
PST150-9Z-F-003	Luggage cover	1



Part No.	Description	Qty per Vehicle
PST150-9Z-G-001	Rear mirror	2
PST150-9Z-G-002	Handlebar	1
PST150-9Z-G-003	Seat cushion pull	1
PST150-9Z-G-004	Mileage line	1
PST150-9Z-G-005	Throttle cable	1
PST150-9Z-G-006	Key set	1
PST150-9Z-G-007	Seat lock	1
PST150-9Z-G-008	Throttle holder	1
PST150-9Z-G-009	Left hand grip	1
PST150-9Z-G-010	Throttle grip	1



Part No.	Description	Qty per Vehicel
PST150-9Z-H-001	Engine	1
PST150-9Z-H-002	Secondary intake pipe	1
PST150-9Z-H-003	Connecting plate	1
PST150-9Z-H-004	AIR FILTER	1
PST150-9Z-H-005	CARB	1
PST150-9Z-H-006	Muffler	1
PST150-9Z-H-007	Exhaust	1
PST150-9Z-H-008	Front sprocket	1
PST150-9Z-H-009	Sprocket holder	1
PST150-9Z-H-010	Sprocket locker	1
PST150-9Z-H-011	Air filter bracket	1
PST150-9Z-H-012	Muffler spring	2
PST150-9Z-H-013	Attachment	1
PST150-9Z-H-014	Chain adjuster	2



Part No.	Description	Qty per Vehicel
PST150-9Z-I-001	Front wall	1
PST150-9Z-I-002METALLIC BLACK	Front panel	1
PST150-9Z-I-002METALLIC WINE RED	Front panel	1
PST150-9Z-I-002METALLIC WHITE	Front panel	1
PST150-9Z-I-002METALLIC BLUE	Front panel	1
PST150-9Z-I-003	Front headlight	1
PST150-9Z-I-004METALLIC BLACK	Front wall left decoration	1
PST150-9Z-I-004METALLIC WINE RED	Front wall left decoration	1
PST150-9Z-I-004METALLIC WHITE	Front wall left decoration	1
PST150-9Z-I-004METALLIC BLUE	Front wall left decoration	1
PST150-9Z-I-005METALLIC BLACK	Front wall right decoration	1
PST150-9Z-I-005METALLIC WINE RED	Front wall right decoration	1
PST150-9Z-I-005METALLIC WHITE	Front wall right decoration	1
PST150-9Z-I-005METALLIC BLUE	Front wall right decoration	1
PST150-9Z-I-006METALLIC BLACK	Front wall decoration	1
PST150-9Z-I-006METALLIC WINE RED	Front wall decoration	1
PST150-9Z-I-006METALLIC WHITE	Front wall decoration	1
PST150-9Z-I-006METALLIC BLUE	Front wall decoration	1

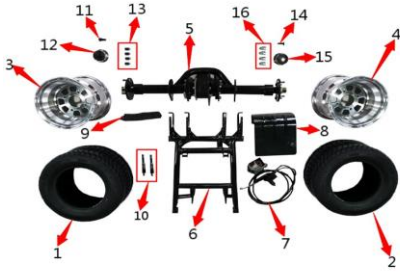

Part No.	Description	Qty per Vehicel
PST150-9Z-J-001	Rear tire	1
PST150-9Z-J-002	Rear tire	1
PST150-9Z-J-003	Rear rim	1
PST150-9Z-J-004	Rear rim	1
PST150-9Z-J-005	Differtinal	1
PST150-9Z-J-006	Swing arm	1
PST150-9Z-J-007	Rear brake	1
PST150-9Z-J-008	Chain cover	1
PST150-9Z-J-009	Chain	1
PST150-9Z-J-010	Front shock	2
PST150-9Z-J-011	Tubeless Valve	1
PST150-9Z-J-012	Chrome decorative cover	1
PST150-9Z-J-013	Nut	4
PST150-9Z-J-014	Tubeless Valve	1
PST150-9Z-J-015	Chrome decorative cover	1
PST150-9Z-J-016	Nut	4



Part No.	Description	Qty per Vehicel
PST150-9Z-K-001METALLIC BLACK	Tail box	1
PST150-9Z-K-001METALLIC WINE RED	Tail box	1
PST150-9Z-K-001METALLIC WHITE	Tail box	1
PST150-9Z-K-001METALLIC BLUE	Tail box	1
PST150-9Z-K-002	Tail box bracket	1



Part No.	Description	Qty per Vehicel
PST150-9Z-L-001	Frame	1

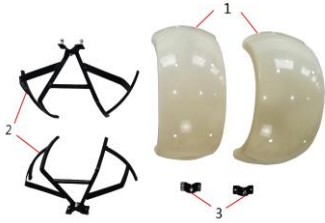

Part No.	Description	Qty per Vehicle
PST150-9Z-M-001METALLIC BLACK	Rear wheel fender	2
PST150-9Z-M-001METALLIC WINE RED	Rear wheel fender	2
PST150-9Z-M-001METALLIC WHITE	Rear wheel fender	2
PST150-9Z-M-001METALLIC BLUE	Rear wheel fender	2
PST150-9Z-M-002	Rear wheel fender bracket	2
PST150-9Z-M-003	Rear wheel fender bracket upper	2



Part No.	Description	Qty per Vehicle
PST150-9Z-N-001METALLIC BLACK	Hood	1
PST150-9Z-N-001METALLIC WINE RED	Hood	1
PST150-9Z-N-001METALLIC WHITE	Hood	1
PST150-9Z-N-001METALLIC BLUE	Hood	1
PST150-9Z-N-002	Speedometer cover	1
PST150-9Z-N-003	Speedometer	1
PST150-9Z-N-004	Front left turning light	1
PST150-9Z-N-005	Front right turning light	1
PST150-9Z-N-006METALLIC BLACK	Hood decoration	1
PST150-9Z-N-006METALLIC WINE RED	Hood decoration	1
PST150-9Z-N-006METALLIC WHITE	Hood decoration	1
PST150-9Z-N-006METALLIC BLUE	Hood decoration	1
PST150-9Z-N-007	Speedometer secondary line 1	1
PST150-9Z-N-008	Speedometer secondary line 2	1
PST150-9Z-N-009	Speedometer secondary line 3	1
PST150-9Z-N-010	Flameout switch	1
PST150-9Z-N-011	Horn switch	1
PST150-9Z-N-012	Electric start switch	1
PST150-9Z-N-013	Left and right turning lights switch	1
PST150-9Z-N-014	Far and near optical switch	1
PST150-9Z-N-015METALLIC BLACK	body kit (B1.B2.B5.B6.B7.B10.C1.C2.C3.I2.I4.I5.I6.M1.N1.N9)	1 set
PST150-9Z-N-015METALLIC WINE RED	body kit (B1.B2.B5.B6.B7.B10.C1.C2.C3.I2.I4.I5.I6.M1.N1.N9)	1 set
PST150-9Z-N-015METALLIC WHITE	body kit (B1.B2.B5.B6.B7.B10.C1.C2.C3.I2.I4.I5.I6.M1.N1.N9)	1 set
PST150-9Z-N-015METALLIC BLUE	body kit (B1.B2.B5.B6.B7.B10.C1.C2.C3.I2.I4.I5.I6.M1.N1.N9)	1 set



Part No.	Description	Qty per Vehicle
PST150-9Z-O-001	Fuel tank	1
PST150-9Z-O-002	Main wire	1
PST150-9Z-O-003	Regulator	1
PST150-9Z-O-004	Tunsignal relay assy	1
PST150-9Z-O-005	Starter relay	1
PST150-9Z-O-006	Ignition coil	1
PST150-9Z-O-007	Fuel level sensors	1
PST150-9Z-O-008	Horn	1
PST150-9Z-O-009	Fuel tank switch	1
PST150-9Z-O-010	Fuel level sensors pressure plate	1
PST150-9Z-O-011	Fuel level sensors rubber ring	1
PST150-9Z-O-012	Fuel tank cover	1

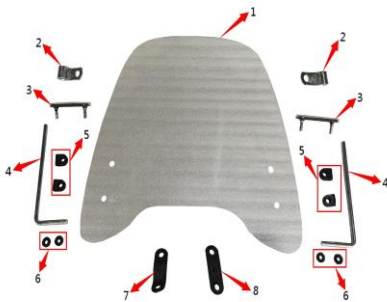

Part No.	Description	Qty per Vehicle
PST150-9Z-P-001	Windshield	1
PST150-9Z-P-002	Windshield attachment 1	2
PST150-9Z-P-003	Windshield attachment 2	2
PST150-9Z-P-004	Windshield attachment 3	2
PST150-9Z-P-005	Windshield attachment 4	4
PST150-9Z-P-006	Windshield attachment 5	4
PST150-9Z-P-007	Windshield attachment 6	1
PST150-9Z-P-008	Windshield attachment 7	1

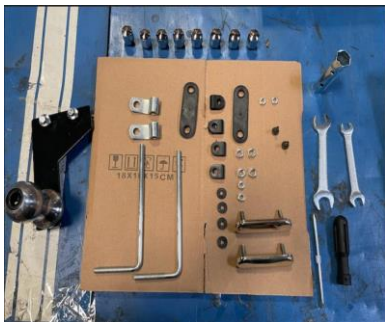

Part No.	Description	Qty per Vehicle
PST150-9Z-Q-01	TRIKE ACCESSORY KIT	1