

Parts No.	Description	Qty per Vehicle
-----------	-------------	-----------------



PST50-1Z-A-001	Front tire	1
PST50-1Z-A-002	Front rim	1
PST50-1Z-A-003	Front brake disc	1
PST50-1Z-A-004	Steering stem	1
PST50-1Z-A-005	Front Shock LH, RH	2
PST50-1Z-A-006	Front disc brake	1
PST50-1Z-A-007	Steel bowl	1
PST50-1Z-A-008	Mileage line clip	1
PST50-1Z-A-009	Front disc brake clip	1
PST50-1Z-A-010	Speed sensor	1
PST50-1Z-A-011	Front wheel bushing	1
PST50-1Z-A-012	Self lock screw	1
PST50-1Z-A-013	Front axle	1
PST50-1Z-A-014	Tubeless valve	1



PST50-1Z-B-001	Left panel	1
PST50-1Z-B-002	Right panel	1
PST50-1Z-B-003	Tail lamp	1
PST50-1Z-B-004	Rear fender	1
PST50-1Z-B-005	Left panel decoration	1
PST50-1Z-B-006	Right panel decoration	1
PST50-1Z-B-007	Connecting, up	1
PST50-1Z-B-008	Rear wing	1
PST50-1Z-B-009	Rear reflector plate	1
PST50-1Z-B-010	Rear tail wing	1
PST50-1Z-B-011	Headlight bracket	1



PST50-1Z-C-001	Front wheel fender	1
PST50-1Z-C-002	Left guard	1
PST50-1Z-C-003	Right guard	1
PST50-1Z-C-004	Rear left bar	1
PST50-1Z-C-005	Rear right bar	1



PST50-1Z-D-001	Seat front wall	1
PST50-1Z-D-002	Front wall fender	1
PST50-1Z-D-003	Center cover	1
PST50-1Z-D-004	Battery cover	1
PST50-1Z-D-005	Charging port cover	1



PST50-1Z-E-001	Lower part of the toolbox	1
PST50-1Z-E-002	Upper part of the toolbox	1
PST50-1Z-E-003	Foot pedal	1
PST50-1Z-E-004	Cover, Chassis No.	1
PST50-1Z-E-005	Hook up	1
PST50-1Z-E-006	Foot pedal cover	4



PST50-1Z-F-001	Seat	1
PST50-1Z-F-002	Luggage	1
PST50-1Z-F-003	Luggage cover	1



PST50-1Z-G-001	Rear mirror	2
PST50-1Z-G-002	Handlebar	1
PST50-1Z-G-003	Seat cushion pull	1
PST50-1Z-G-004	Mileage line	1
PST50-1Z-G-005	Throttle cable	1
PST50-1Z-G-006	Key set	1
PST50-1Z-G-007	Seat lock	1
PST50-1Z-G-008	Throttle holder	1
PST50-1Z-G-009	Left hand grip	1
PST50-1Z-G-010	Throttle grip	1



PST50-1Z-H-001	Engine	1
PST50-1Z-H-002	Connecting plate	1
PST50-1Z-H-003	Air filter	1
PST50-1Z-H-004	Carb	1
PST50-1Z-H-005	Muffler	1
PST50-1Z-H-006	Front sprocket	1
PST50-1Z-H-007	Sprocket holder	1
PST50-1Z-H-008	Connecting plate bushing	1
PST50-1Z-H-009	Air filter bracket long	1
PST50-1Z-H-010	Air filter bracket short	1
PST50-1Z-H-011	Muffler washer	1





PST50-1Z-I-001	Front wall	1
PST50-1Z-I-002	Front panel	1
PST50-1Z-I-003	Front headlight	1
PST50-1Z-I-004	Front wall left decoration	1
PST50-1Z-I-005	Front wall right decoration	1
PST50-1Z-I-006	Front wall decoration	1

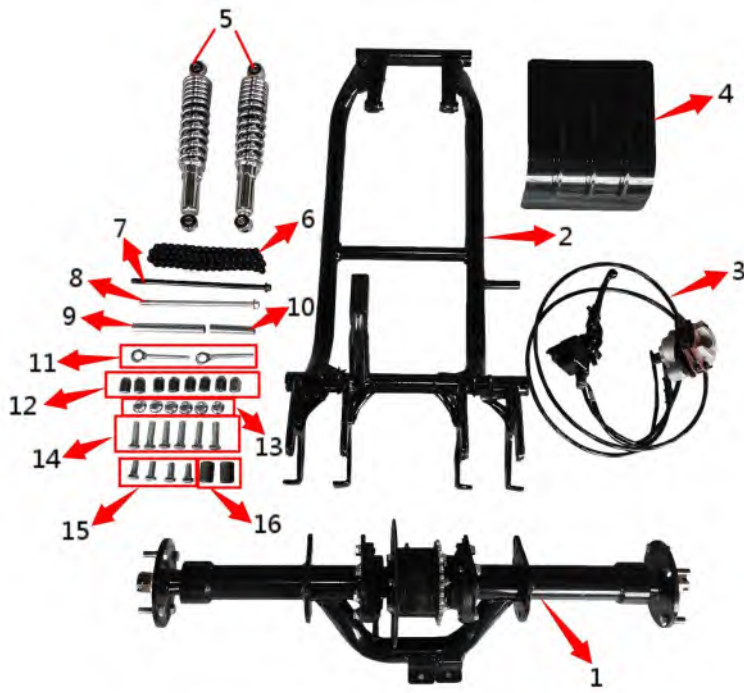

PST50-1Z-J-001	Differtinal	1
PST50-1Z-J-002	Swing arm	1
PST50-1Z-J-003	Rear brake	1
PST50-1Z-J-004	Chain cover	1
PST50-1Z-J-005	Rear shock	2
PST50-1Z-J-006	Chain	1
PST50-1Z-J-007	Swing arm axle	1
PST50-1Z-J-008	Engine axle	1
PST50-1Z-J-009	Swing arm supporting tube	1
PST50-1Z-J-010	Engine supporting tube	1
PST50-1Z-J-011	Chain adjuster	2
PST50-1Z-J-012	Tire nut	8
PST50-1Z-J-013	Nut	6
PST50-1Z-J-014	Nut	6
PST50-1Z-J-015	Nut	4
PST50-1Z-J-016	Swing arm buffer bushing	2



PST50-1Z-K-001	Tail box	1
PST50-1Z-K-002	Tail box bracket	1



PST50-1Z-L-001	Frame	1
----------------	-------	---



PST50-1Z-M-001	Rear wheel fender	2
PST50-1Z-M-002	Rear wheel fender bracket	2
PST50-1Z-M-003	Rear wheel fender bracket upper	2



PST50-1Z-N-001	Hood	1
PST50-1Z-N-002	Speedometer cover	1
PST50-1Z-N-003	Speedometer	1
PST50-1Z-N-004	Front left turning light	1
PST50-1Z-N-005	Front right turning light	1
PST50-1Z-N-006	Hood decoration	1
PST50-1Z-N-007	Speedometer secondary line 1	1
PST50-1Z-N-008	Speedometer secondary line 2	1
PST50-1Z-N-009	Speedometer secondary line 3	1
PST50-1Z-N-010	Flameout switch	1
PST50-1Z-N-011	Horn switch	1
PST50-1Z-N-012	Electric start switch	1
PST50-1Z-N-013	Left and right turning lights switch	1
PST50-1Z-N-014	Far and near optical switch	1



PST50-1Z-O-001	Fuel tank	1
PST50-1Z-O-002	Main wire	1
PST50-1Z-O-003	Regulator	1
PST50-1Z-O-004	Tunsignal relay assy	1
PST50-1Z-O-005	Starter relay	1
PST50-1Z-O-006	Ignition coil	1
PST50-1Z-O-007	Fuel level sensors	1
PST50-1Z-O-008	Horn	1
PST50-1Z-O-009	Fuel tank switch	1
PST50-1Z-O-010	Fuel level sensors pressure plate	1
PST50-1Z-O-011	Fuel level sensors rubber ring	1
PST50-1Z-O-012	Fuel tank cover	1



PST50-1Z-P-001	Rear tire	2
PST50-1Z-P-002	Rear rim	2
PST50-1Z-P-003	Chrome decorative cover	2
PST50-1Z-P-004	Tubeless Valve	2



PST50-1Z-Q-001	Windshield	1
PST50-1Z-Q-002	Windshield attachment 1	2
PST50-1Z-Q-003	Windshield attachment 2	2
PST50-1Z-Q-004	Windshield attachment 3	2
PST50-1Z-Q-005	Windshield attachment 4	4
PST50-1Z-Q-006	Windshield attachment 5	4
PST50-1Z-Q-007	Windshield attachment 6	1
PST50-1Z-Q-008	Windshield attachment 7	1