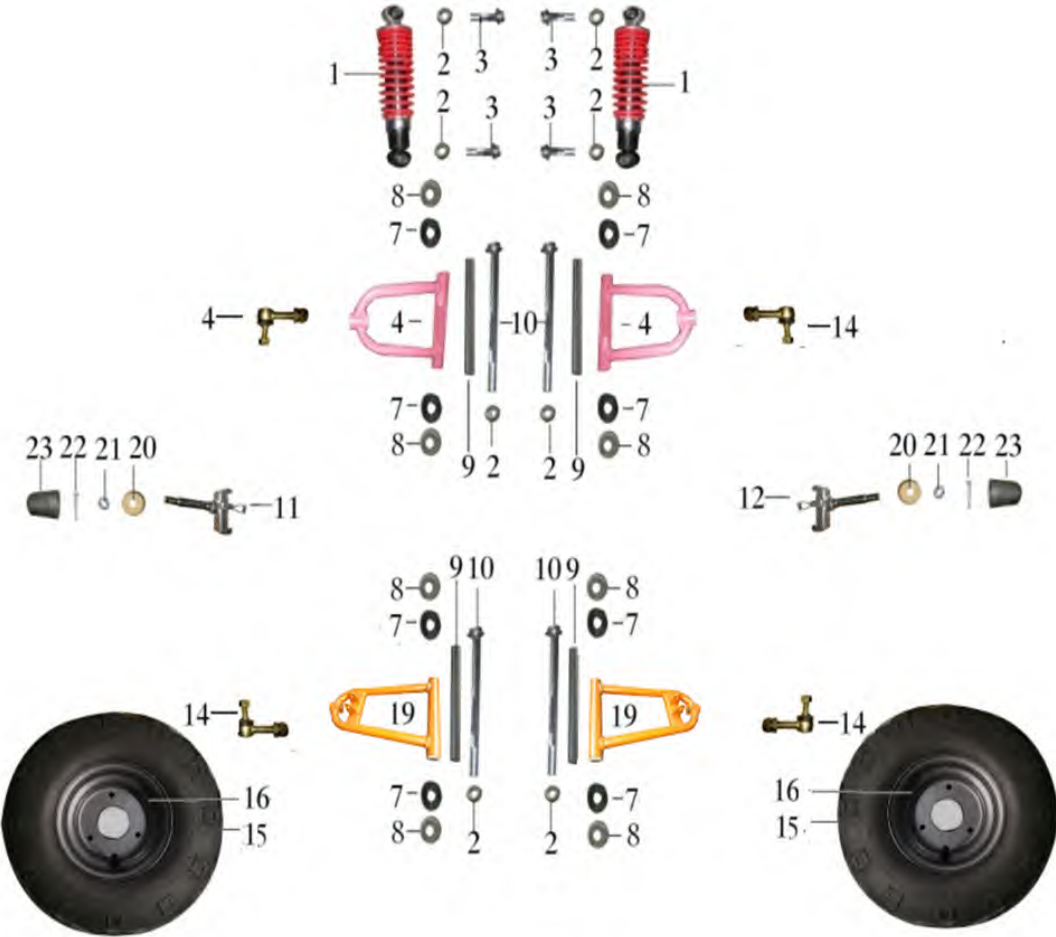

PART NUMBER	Description	Qty per Vehicle
1. Main part Plastic cover		
PAH125-8E-A-001	MAIN PLASTIC BODY	1
PAH125-8E-A-002	FR.L.Plastic hemming	1
PAH125-8E-A-003	R.L.Plastic hemming	1
PAH125-8E-A-004	FR.R.Plastic hemming	1
PAH125-8E-A-005	R.R.Plastic hemming	1
PAH125-8E-A-006	DECORATIVE BOARD,FR.BUMPER	1
PAH125-8E-A-007	LIGHT COVER	1

PART NUMBER	Description	Qty per Vehicel
PAH125-8E-A-008	FR.PANEL	1
PAH125-8E-A-009	L.FOOTREST	1
PAH125-8E-A-010	R.FOOTREST	1
PAH125-8E-A-011	FR.LIGHT	2
PAH125-8E-A-012	TAIL LIGHT	1
PAH125-8E-A-013	chain cover	1
PAH125-8E-A-014	SEAT	1
PAH125-8E-A-015	talk	1
PAH125-8E-A-016	GAS FILTER	1
PAH125-8E-A-017	OIL SWITCH	1
PAH125-8E-A-018	SMALL FUEL PIPE 0.29m	1
PAH125-8E-A-019	BIG SPRINGINESS LATHE DOG	1
PAH125-8E-A-020	BIG FUEL PIPE 0.4m	1
PAH125-8E-A-021	SMALL SPRINGINESS LATHE DOG	5
PAH125-8E-A-022	big hexagon socket flat head bolt	30
PAH125-8E-A-023	rubber washer	30
PAH125-8E-A-024	self locking nut	31
PAH125-8E-A-025	self tapping screw	8
PAH125-8E-A-026	Expansion screw	22
PAH125-8E-A-027	INDICATOR LIGHT R	1
PAH125-8E-A-028	INDICATOR LIGHT N	1

PART NUMBER	Description	Qty per Vehicle
2. Main part steering system		
PAH125-8E-B-001	HANDLE BAR	1
PAH125-8E-B-002	FUNCTION SWITCH	1
PAH125-8E-B-003	STEERING BAR	1
PAH125-8E-B-004	Hexagon flange bolts	4
PAH125-8E-B-005	UPPER CLIP	1
PAH125-8E-B-007	THROTTLE	1
PAH125-8E-B-008	HANDLE BAR	1
PAH125-8E-B-009	Hexagon flange bolts	2
PAH125-8E-B-010	STEERING CLIP (UPPER)	1
PAH125-8E-B-011	GASKET	2
PAH125-8E-B-013	NUT	2

PART NUMBER	Description	Qty per Vehicel
PAH125-8E-B-014	STEERING POST	1
PAH125-8E-B-015	tie rod	1
PAH125-8E-B-016	NUT	1
PAH125-8E-B-017	PROTECTION MASK CLOTH	1
PAH125-8E-B-018	PROTECTION MASK	1
PAH125-8E-B-019	THROTTLE CABLE	1
PAH125-8E-B-020	GASKET	1

PART NUMBER	Description	Qty per Vehicle
 <p>The diagram shows an exploded view of the front suspension system. Key components include: <ul style="list-style-type: none"> 1: Front shock absorbers (red). 4: Hex flange locking nuts (pink). 10: Upper control arms (pink). 19: Lower control arms (orange). 16: Wheel hubs (black). 15: Wheel rims (black). 20-23: Various bolts and nuts for hub and wheel assembly. </p>		
3. Main part front suspension system		
PAH125-8E-C-001	FRONT SHOCK	2
PAH125-8E-C-002	HEX FLANGE LOCKING NUT	12
PAH125-8E-C-003	Hexagon flange bolts	4
PAH125-8E-C-004	UPPER SWING ARM	2

PART NUMBER	Description	Qty per Vehicel
PAH125-8E-C-005	Hexagon flange bolts	4
PAH125-8E-C-006	short GASKET	4
PAH125-8E-C-007	small WASHER	8
PAH125-8E-C-008	small COVER	8
PAH125-8E-C-009	long GASKET	4
PAH125-8E-C-010	Hexagon flange bolts	4
PAH125-8E-C-011	LEFT ELEVATION AXIS	1
PAH125-8E-C-012	RIGHT ELEVATION AXIS	1
PAH125-8E-C-014	tie rod end	4
PAH125-8E-C-015	REAR HUB	2
PAH125-8E-C-016	front rim	2
PAH125-8E-C-018	HEX FLANGE LOCKING NUT	2
PAH125-8E-C-019	LOWER SWING ARM	2
PAH125-8E-C-020	Big COVER	2
PAH125-8E-C-021	Slotted nut	2
PAH125-8E-C-022	Cotter pin	2
PAH125-8E-C-023	Dust cap	2

PART NUMBER	Description	Qty per Vehicle
4. Main part Rear suspension system		
PAH125-8E-D-001	REAR SHOCK	1
PAH125-8E-D-002	HEX FLANGE LOCKING NUT	6
PAH125-8E-D-003	Hexagon flange bolts	2
PAH125-8E-D-004	CHAIN COVER	2
PAH125-8E-D-005	Hexagon flange bolts	1
PAH125-8E-D-006	Hexagon flange bolts	1

PART NUMBER	Description	Qty per Vehicel
PAH125-8E-D-007	BEARING	2
PAH125-8E-D-008	GASKET	1
PAH125-8E-D-009	REAR FORK	1
PAH125-8E-D-010	chian	1
PAH125-8E-D-011	Chain regulator	2
PAH125-8E-D-012	REAR AXLE	1
PAH125-8E-D-013	SPROCKET SEAT	1
PAH125-8E-D-014	BRAKE SEAT	1
PAH125-8E-D-015	CHAIN WHEEL	1
PAH125-8E-D-016	REAR DISC BRAKE	1
PAH125-8E-D-017	HUB SEAT	2
PAH125-8E-D-018	Big COVER	2
PAH125-8E-D-019	Slotted nut	2
PAH125-8E-D-020	Cotter pin	2
PAH125-8E-D-021	Dust cap	2
PAH125-8E-D-022	Hexagon flange bolts	8
PAH125-8E-D-023	CONNECTOR	1
PAH125-8E-D-024	Hexagon flange bolts	4
PAH125-8E-D-025	Hexagon flange bolts	8
PAH125-8E-D-026	GASKET	1
PAH125-8E-D-027	BEARING	2
PAH125-8E-D-028	REAR HUB	2
PAH125-8E-D-029	FRONT TIRE	2

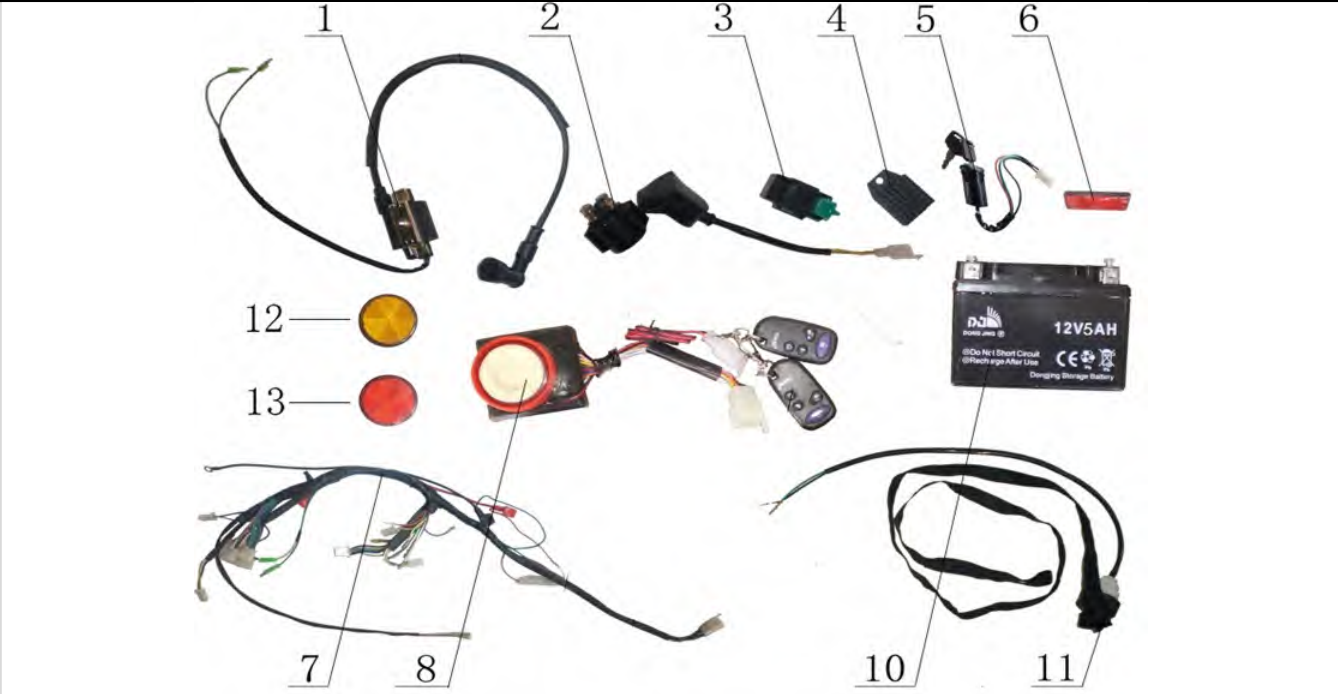
PART NUMBER	Description	Qty per Vehicle
		

5. Main part Electrical parts

PAH125-8E-E-001	IGNITION COIL	1
PAH125-8E-E-002	RELAY	1
PAH125-8E-E-003	C.D.I	1
PAH125-8E-E-004	RECTIFIER	1
PAH125-8E-E-005	ELECTRIC LOCK	1
PAH125-8E-E-006	REPLAY TRANSMITTER	1
PAH125-8E-E-007	CABLE	1
PAH125-8E-E-008	ALARM	1
PAH125-8E-E-010	BATTERY	1
PAH125-8E-E-011	FLAME OUT SWITCH	1

PART NUMBER	Description	Qty per Vehicel
PAH125-8E-E-012	reflector I	2
PAH125-8E-E-013	reflector II	2

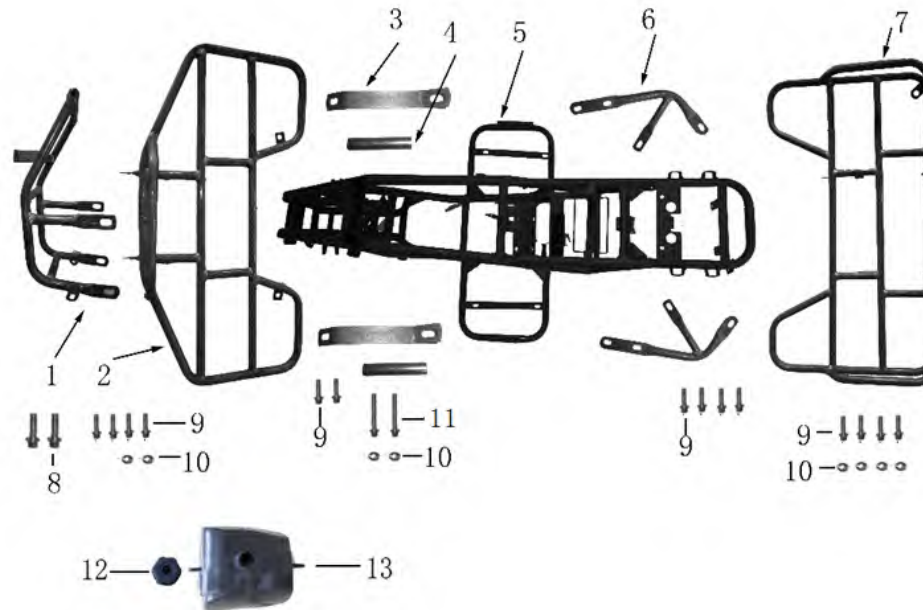

6. Main part Frame

PAH125-8E-F-001	FENDER GUARD	1
PAH125-8E-F-002	ahead rack	1
PAH125-8E-F-003	Connection piece	2
PAH125-8E-F-004	tube	2
PAH125-8E-F-005	FRAME	1
PAH125-8E-F-006	Fixed frame	2
PAH125-8E-F-007	rear rack	1
PAH125-8E-F-008	flange bolts	2
PAH125-8E-F-009	NUT	8

PART NUMBER	Description	Qty per Vehicel
PAH125-8E-F-010	flange bolts	14
PAH125-8E-F-011	flange bolts	2
PAH125-8E-F-012	fuel tank cap	1
PAH125-8E-F-013	fuel tank	1

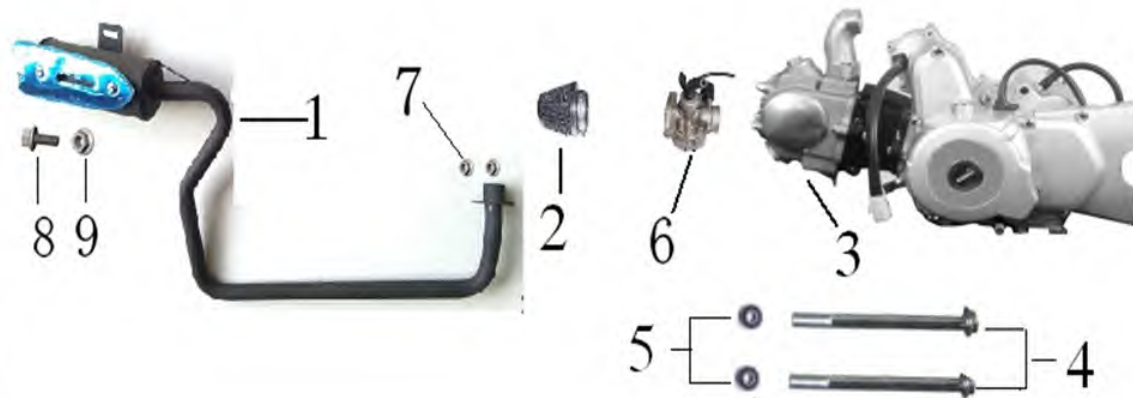

7. Main part Main part Induction system

PAH125-8E-G-001	EXHAUST PIPE	1
PAH125-8E-G-002	AIR FILTER	1
PAH125-8E-G-003	ENGINE	1
PAH125-8E-G-004	Hexagon flange bolts	2
PAH125-8E-G-005	HEX FLANGE LOCKING NUT	2
PAH125-8E-G-006	carburetor	1
PAH125-8E-G-007	nut	2
PAH125-8E-G-008	bolt	1
PAH125-8E-G-009	nut	1

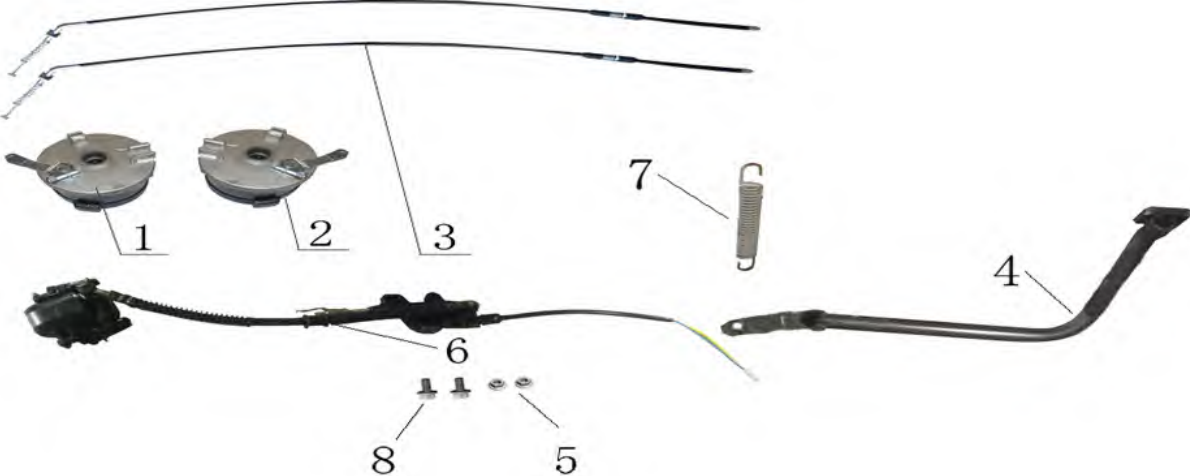
PART NUMBER	Description	Qty per Vehicel
		
8. Main part Hydraulic brake system		
PAH125-8E-H-001	left DRUM BRAKE	1
PAH125-8E-H-002	right DRUM BRAKE	1
PAH125-8E-H-003	BRAKE CABLE	2
PAH125-8E-H-004	foot brake fast	1
PAH125-8E-H-005	nut	2
PAH125-8E-H-006	rear brake set	1
PAH125-8E-H-007	spring	1
PAH125-8E-H-008	bolt	2