

Parts No.	Description	Qty per Vehicle
-----------	-------------	-----------------

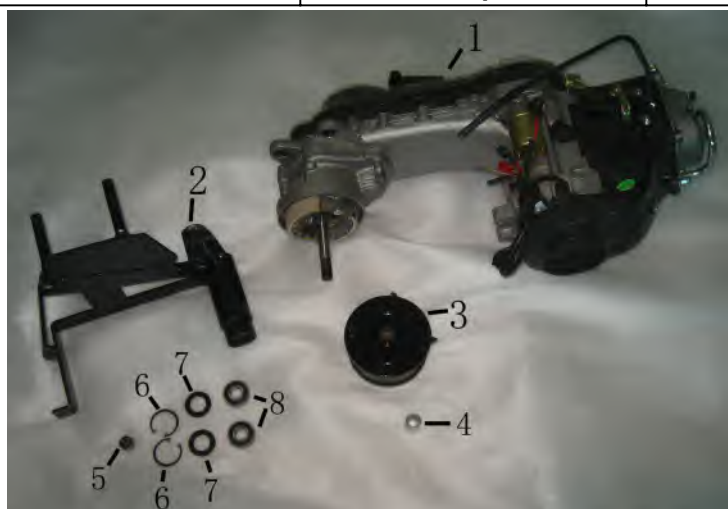

PMZ50-19-A-001	ENGINE	1
PMZ50-19-A-002	connecting plate	1
PMZ50-19-A-003	rear rub	1
PMZ50-19-A-004	bushing	1
PMZ50-19-A-005	bushing	1
PMZ50-19-A-006	washer	2
PMZ50-19-A-007	oil seal	2
PMZ50-19-A-008	bearing	2



PMZ50-19-B-001	air filter bend	1
PMZ50-19-B-002	air filter	1
PMZ50-19-B-003	clamp	2
PMZ50-19-B-004	airfilter bracket	1
PMZ50-19-B-005	airfilter bracket	1
PMZ50-19-B-006	rubber connecting	1
PMZ50-19-B-007	AIR FILTER ASSEY	1



PMZ50-19-C-001	ELBOW PIECE	1
PMZ50-19-C-002	MUFFLER	1
PMZ50-19-C-003	paper pad	1
PMZ50-19-C-004	clamp	1
PMZ50-19-C-005	wood pad	1
PMZ50-19-C-006	rubber pad	2
PMZ50-19-C-007	EXHAUST ASSEY	



PMZ50-19-D-001	HEADLIGHT COMPLETE	1
PMZ50-19-D-002	ornamental buckle	3
PMZ50-19-D-003	rubber pad	3



PMZ50-19-E-001	rear tire	1
PMZ50-19-E-002	rear rim	1
PMZ50-19-E-003	valve	1



PMZ50-19-F-001	front tire	1
PMZ50-19-F-002	front rim	1
PMZ50-19-F-003	front brake disc	1
PMZ50-19-F-004	valve	1



PMZ50-19-G-001	LATTER GUARD SHIELD	1
PMZ50-19-G-002	rear shield	1



PMZ50-19-H-001	seat	1
PMZ50-19-H-002	rubber	2
PMZ50-19-H-003	FIXED BUCKLE	2
PMZ50-19-H-004	fixed frame	1



PMZ50-19-I-001	fuel tank	1
PMZ50-19-I-002	oil pump	1
PMZ50-19-I-003	GAS SENSOR	1
PMZ50-19-I-004	oil seal	1
PMZ50-19-I-005	fixed ring	1

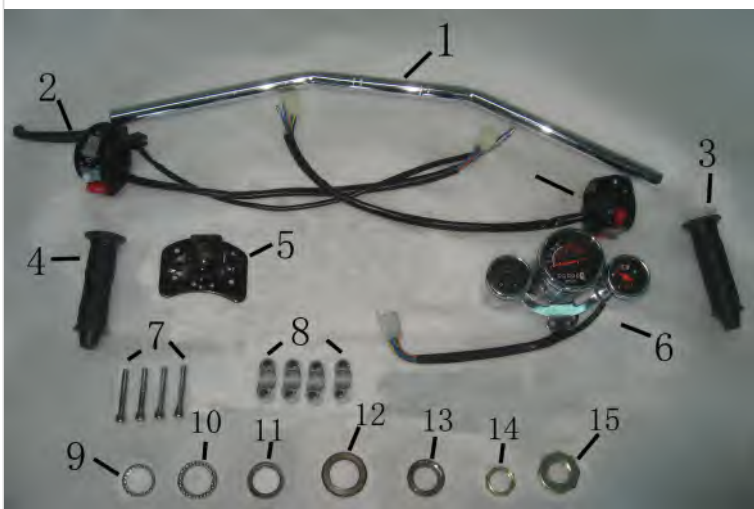

PMZ50-19-J-001	handlebar	1
PMZ50-19-J-002	RIGHT COMBO SWITCH	1
PMZ50-19-J-002-01	LEFT COMBO SWITCH	1
PMZ50-19-J-003	THROTTLE GRIP	1
PMZ50-19-J-004	lfet hand grip	1
PMZ50-19-J-005	handle guide	1
PMZ50-19-J-006	speedometer	1
PMZ50-19-J-007	bolt	2
PMZ50-19-J-008	handlebar lock	2
PMZ50-19-J-009	STEEL BALL	1

PMZ50-19-J-010	STEEL BALL	1
PMZ50-19-J-011	washer	1
PMZ50-19-J-012	RACE,INNER	1
PMZ50-19-J-013	RACE,INNER	1
PMZ50-19-J-014	nut	1
PMZ50-19-J-015	nut	1



PMZ50-19-K-001	MAIN WIRE	1
	NEW WIRE HARNESS	
PMZ50-19-K-002	HORN	1
PMZ50-19-K-003	HOLDER,BATTERY	1
PMZ50-19-K-004	front shield install frame	1
PMZ50-19-K-005	front turning lh	1
PMZ50-19-K-006	front turning rh	1
PMZ50-19-K-007	REGULATOR	1
PMZ50-19-K-008	IGNITION COIL	1
PMZ50-19-K-009	STARTER RELAY	1
PMZ50-19-K-010	SWITCH ASSY,IGNITION	1
PMZ50-19-K-011	RELAY ASSY,TUNIGNAL	1
PMZ50-19-K-012	CDI	1
PMZ50-19-K-013	speed senser	1
PMZ50-19-K-014	key	1
PMZ50-19-K-015	fuel tank cover	1



PMZ50-19-L-001	rear light	1
PMZ50-19-L-002	rear turning light lh	1
PMZ50-19-L-003	rear turning light rh	1



PMZ50-19-M-001	front brake	1
PMZ50-19-M-002	Master cylinder	1
PMZ50-19-M-003	brake lever	1
PMZ50-19-M-004	Brake Line	1
PMZ50-19-M-005	Brake Caliper	1
PMZ50-19-M-006	Brake Pad	1



PMZ50-19-N-001	CARBURETOR	1
PMZ50-19-N-002	THROTTLE CABLE	1

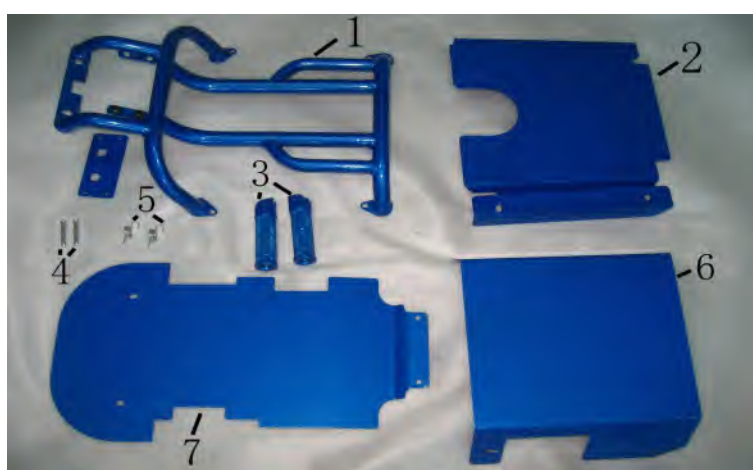

PMZ50-19-O-001	FUEL TANK BRACKET	1
PMZ50-19-O-002	FUEL TANK COVER	1
PMZ50-19-O-003	front footpeg	2
PMZ50-19-O-004	front footpeg pin	1
PMZ50-19-O-005	SPRING	1
PMZ50-19-O-006	COVER UNDER FUEL TANK	1
PMZ50-19-O-007	cover under seat	1





PMZ50-19-P-001	rear bushing	1
PMZ50-19-P-002	rear bushing inner	1
PMZ50-19-P-003	swing arm	1
PMZ50-19-P-004	engine bushing	1
PMZ50-19-P-005	support pipe	1
PMZ50-19-P-006	support pipe bushing	1
PMZ50-19-P-007	rear shock	1
PMZ50-19-P-008	rear shock	1

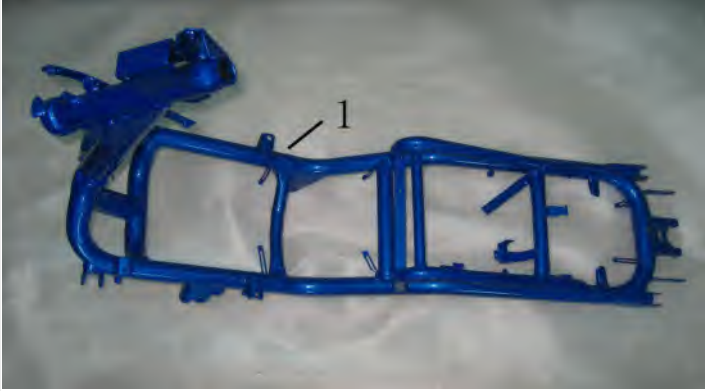

PMZ50-19-Q-001	frame	1
----------------	-------	---



PMZ50-19-R-001	battery	1
PMZ50-19-R-002	rear mirror LH	1
PMZ50-19-R-003	rear mirror RH	1
PMZ50-19-R-004	electrolyte	1
PMZ50-19-R-005	climbing belt	1
PMZ50-19-R-006	tool	1
PMZ50-19-R-007	tool	1
PMZ50-19-R-008	tool	1
PMZ50-19-R-009	tool	1
PMZ50-19-R-010	steering stem cover	1



PMZ50-19-S-001	rear brake cable	1
PMZ50-19-S-002	speedo cable	1

PMZ50-19-S-003	kick stand spring	1
PMZ50-19-S-004	kick stand	1



PMZ50-19-T-001	steel bowel	1 set
PMZ50-19-T-002	BRACKET	1
PMZ50-19-T-003	steering stem	1
PMZ50-19-T-004	front fender	1
PMZ50-19-T-005	front shock	2